



Measure E Bond Program MODESTO JUNIOR COLLEGE CAMPUS CONSTRUCTION UPDATE



UPDATES & ACTIVITIES THAT MAY IMPACT CAMPUS OPERATION *Week of July 4, 2016*

DISTRICT OFFICE BUILDING

Work this week: Contractor will continue working on lighting, interior paint, pulling wire, site grading and site concrete.

Access: None
Noise: Moderate due to construction equipment.
Parking: None
Utilities: None
Odors: None
Dust: Minor impact.

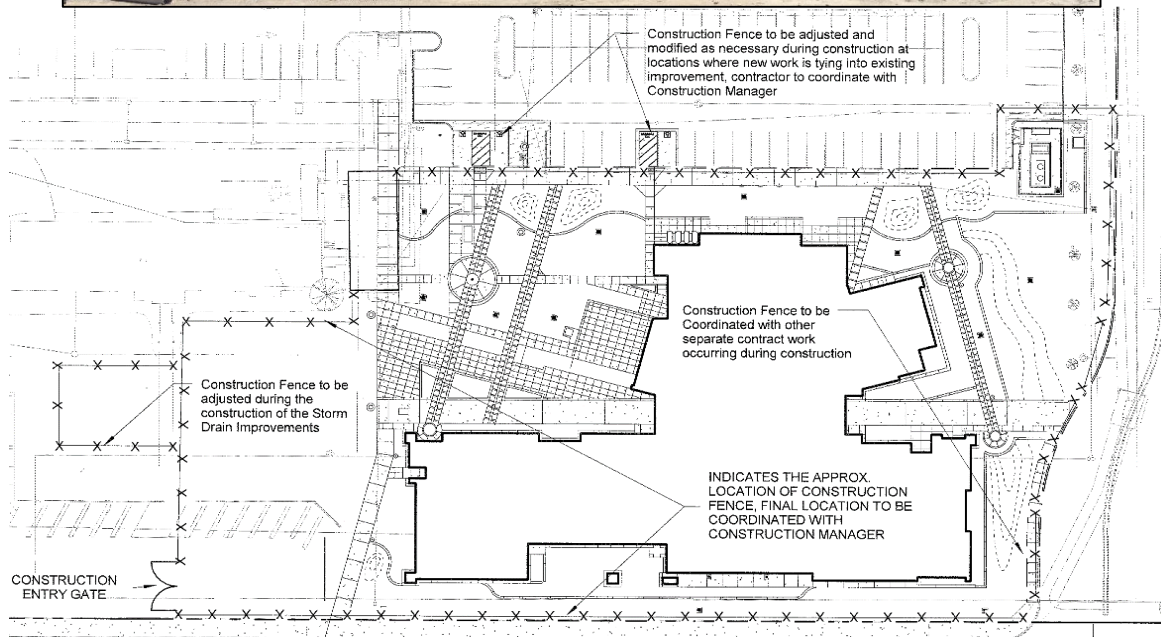

X-X-X

Construction fencing. Restricted access.



WESTERLY ROADS AREAS 3 & 4

Work this week: Paving is complete at Parking Lot 207. On Tuesday paving will occur from F. Street down to E. Street. Grading is taking place on the 2nd half of E. Street headed to the new 2nd Street. Irrigation work will occur at parking lot 207 while electrical continues towards the new 2nd street.

Access: Lot 207 is now open for parking.
Noise: Extreme noise due to heavy construction equipment.
Parking: Gravel lot across E. Street will be closed along with Parking Lot 211.
Utilities: None anticipated.
Odors: None anticipated.
Dust: Moderate impact due to construction related activities.



WESTERLY ROADS AREAS 5 & 6

Work this week: Work will now continue for our newest road project. Parking lot 211 will be closed for use starting Tuesday as saw cut work will occur from the East side of B Street across from Yosemite Hall down to Parking Lot 209. Demo work will follow in these areas towards the end of the week.

Access: Lot 207 is now open for parking.

Noise: Extreme noise due to heavy construction equipment.

Parking: Gravel lot across E Street will be closed along with Parking Lot 211.

Utilities: None anticipated.

Odors: None anticipated.

Dust: Moderate impact due to construction related activities.

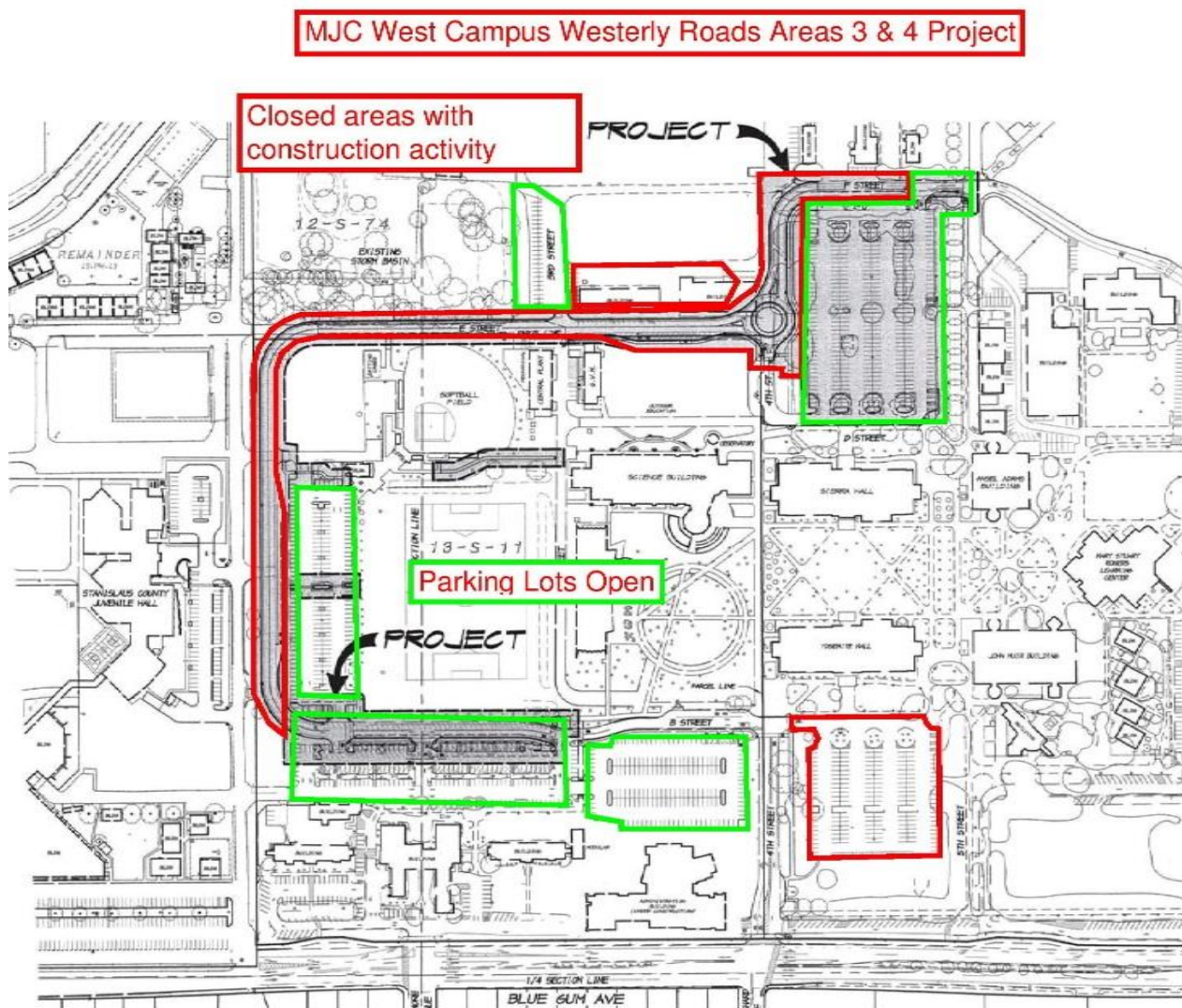



SOLAR ARRAY PROJECT

Work this week: Contractor continues on electrical work installations.

Access: None.
Noise: Extreme noise due to heavy construction equipment.
Parking: Lot 215 will be closed.
Utilities: Power shut down at the Central Plant on July 8.
Odors: None anticipated.
Dust: Moderate impact due to construction related activities.



Under Construction

Available Parking



If there are any questions or concerns please contact Kitchell CEM, located at
2201 Blue Gum Ave., Modesto CA 95358 Tel: 575-6991 E-mail: avalencia@kitchell.com