



Measure E Bond Program MODESTO JUNIOR COLLEGE CAMPUS CONSTRUCTION UPDATE



UPDATES & ACTIVITIES THAT MAY IMPACT CAMPUS OPERATION *Week of May 23, 2016*

DISTRICT OFFICE BUILDING

Work this week: Contractor will be working on mechanical and electrical rough-in, roofing, building stucco, and installing sheetrock. Painting and site work.

Access: None
Noise: Moderate due to construction equipment.
Parking: None
Utilities: None
Odors: None
Dust: Minor impact.

X-X-X Construction fencing. Restricted access.

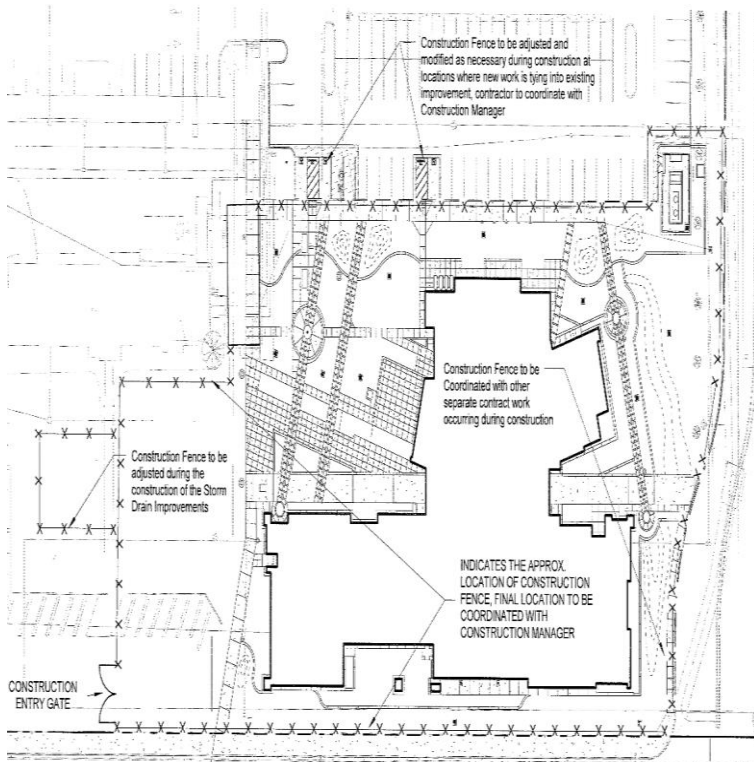



WESTERLY ROADS AREAS 3 & 4

Work this week: Forming for curbs, gutters & sidewalks will occur through the week. Electrical & irrigation work will continue. Saw cutting work for the sidewalks at Parking Lot 202 will begin on Monday.

Access: Traffic will be redirected to G-Street North of Lot 207.

Noise: Extreme noise due to heavy construction equipment.

Parking: Lot 207 will be closed. Lot 202 will be partly closed starting Monday.

Utilities: None anticipated.

Odors: None anticipated.

Dust: Moderate impact due to construction related activities.

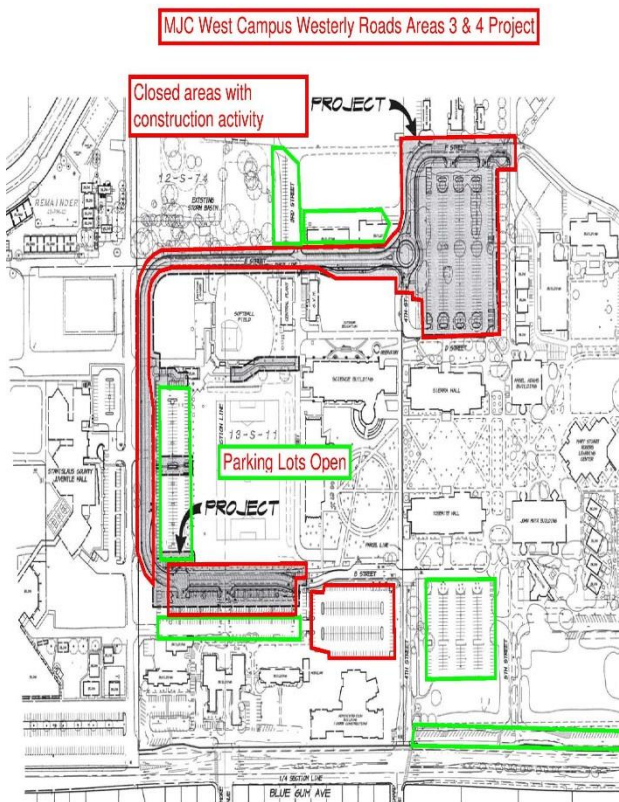



SOLAR ARRAY PROJECT

Work this week: Installation of purlins and columns, begin painting of steel, and delivery of modules.

Access: None.

Noise: Extreme noise due to heavy construction equipment.

Parking: Lot 215 will be closed.

Utilities: None anticipated.

Odors: None anticipated.

Dust: Moderate impact due to construction related activities.



Under Construction

Available Parking



If there are any questions or concerns contact Kitchell CEM, Measure E Bond Construction Manager, located at 2201 Blue Gum Ave., Modesto CA 95358 Tel: 575-6991 Email mkenedy@kitchell.com