



**UPDATES & ACTIVITIES THAT MAY IMPACT  
 CAMPUS OPERATION**

*Week of December 17, 2012*

**SCIENCE COMMUNITY CENTER**

**Work this week:** Continued installation of casework and lab cabinetry. Continued site work. Installation of flooring on 2<sup>nd</sup> and 3<sup>rd</sup> floors. Electrical, mechanical and plumbing finish work. Installation of interior finishes. Installation of GVM displays.

- Access:** No anticipated impact
- Noise:** Moderate impact
- Parking:** No anticipated impact
- Utilities:** No anticipated impact
- Odors:** No anticipated impact
- Dust:** No anticipated impact



**WEST CAMPUS PARKING LOT**

**Work this week:** Work on punchlist items.

- Access:** No anticipated impact
- Noise:** No anticipated impact
- Parking:** No anticipated impact
- Utilities:** No anticipated impact
- Odors:** No anticipated impact
- Dust:** No anticipated impact



**AG PAVILION SITE IMPROVEMENTS**

**Work this week:** Installation of gravel and punchlist work.

- Access:** Limited access when using G Street & Student Center Dr.
- Noise:** Moderate impact
- Parking:** No anticipated impact
- Utilities:** No anticipated impact
- Odors:** No anticipated impact
- Dust:** No anticipated impact





# Measure E Bond Program MODESTO JUNIOR COLLEGE CAMPUS CONSTRUCTION UPDATE *continued (page 2 of 3)*

## SHIPPING & RECEIVING BLDG

**Work this week:** Concrete pour of the foundation.

<b>Access:</b>	Caution when using G Street & 5 <sup>th</sup> Street.
<b>Noise:</b>	Moderate impact
<b>Parking:</b>	No anticipated impact
<b>Utilities:</b>	No anticipated impact
<b>Odors:</b>	No anticipated impact
<b>Dust:</b>	No anticipated impact



## PRIMARY DATA CENTER

**Work this week:** Installation of interior and exterior framing. Rough in electrical. Installation of structural steel

<b>Access:</b>	Caution at G Street and 3 <sup>rd</sup> street.
<b>Noise:</b>	Moderate impact
<b>Parking:</b>	No anticipated impact
<b>Utilities:</b>	No anticipated impact
<b>Odors:</b>	No anticipated impact
<b>Dust:</b>	Moderate impact



## LIBRARY RENOVATION

**Work this week:** Wall and structural steel layout.

<b>Access:</b>	See updated access map below
<b>Noise:</b>	Deliveries and tractors
<b>Parking:</b>	See attached map for closure.
<b>Utilities:</b>	Power to library except for the essential HVAC circuits remain off. Water to the Library will be turned off for a few hours.
<b>Odors:</b>	None
<b>Dust:</b>	None







**Measure E Bond Program**  
**MODESTO JUNIOR COLLEGE CAMPUS**  
**CONSTRUCTION UPDATE**  
*continued (page 3 of 3)*

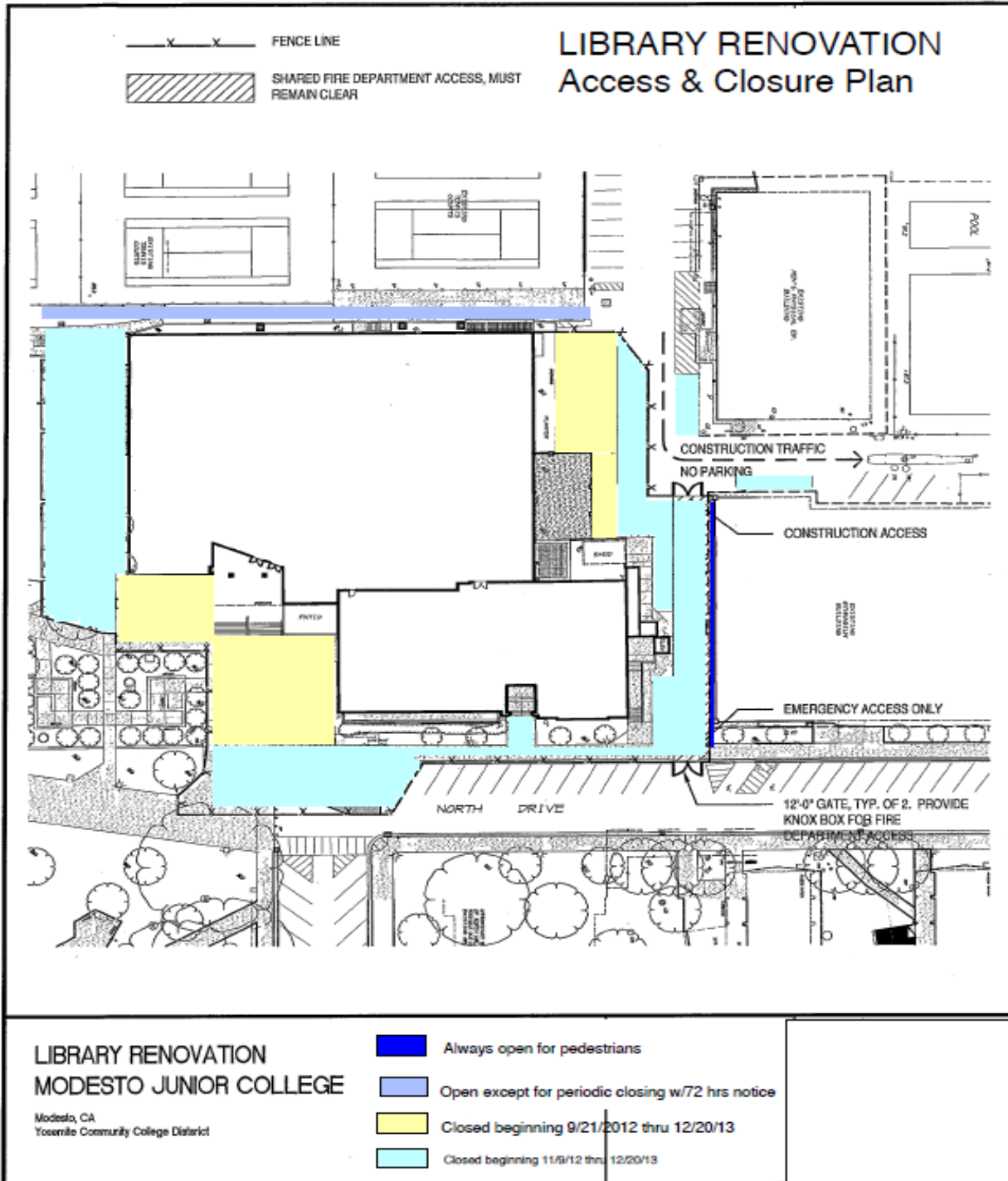

If there are any questions or concerns contact Kitchell CEM, Measure E Bond Construction Manager, located at 2201 Blue Gum Ave., Modesto CA 95358 Tel: 575-6991 Email mkennedy@kitchell.com

