



**UPDATES & ACTIVITIES THAT MAY IMPACT
 CAMPUS OPERATION**

Week of December 3, 2012

SCIENCE COMMUNITY CENTER

Work this week: Installation of casework and lab cabinetry. Continued site work. Installation of flooring on 2nd and 3rd floors. Electrical, mechanical and plumbing finish work. Installation of planetarium dome. Interior and exterior painting. Installation of GVM displays.

- Access:** No anticipated impact
- Noise:** Moderate impact
- Parking:** No anticipated impact
- Utilities:** No anticipated impact
- Odors:** No anticipated impact
- Dust:** No anticipated impact



WEST CAMPUS PARKING LOT

Work this week: Work on punchlist items.

- Access:** Caution at 4th and B Street, sidewalk closed at east end of Lot 202.
- Noise:** No anticipated impact
- Parking:** 11 stalls at east end of Lot 202 impacted
- Utilities:** No anticipated impact
- Odors:** No anticipated impact
- Dust:** No anticipated impact



AG PAVILION SITE IMPROVEMENTS

Work this week: Continue installation of feedlot.

- Access:** Limited access when using G Street & Student Center Dr.
- Noise:** Moderate impact
- Parking:** No anticipated impact
- Utilities:** No anticipated impact
- Odors:** No anticipated impact
- Dust:** No anticipated impact





Measure E Bond Program MODESTO JUNIOR COLLEGE CAMPUS CONSTRUCTION UPDATE *continued (page 2 of 3)*

SHIPPING & RECEIVING BLDG

Work this week: Continued trenching and installation of formwork for foundation. Installation of underground plumbing and electrical.

- Access:** Caution when using G Street & 5th Street.
- Noise:** Moderate impact
- Parking:** No anticipated impact
- Utilities:** No anticipated impact
- Odors:** No anticipated impact
- Dust:** No anticipated impact



PRIMARY DATA CENTER

Work this week: Installation of interior and exterior framing.

- Access:** Caution at G Street and 3rd street.
- Noise:** Moderate impact
- Parking:** No anticipated impact
- Utilities:** No anticipated impact
- Odors:** No anticipated impact
- Dust:** Moderate impact



LIBRARY REMEDIATION

Work this week: Continue demolition and abatement on the first floor and begin flooring removal and abatement in the basement.

- Access:** See updated access map below
- Noise:** High: equipment noise
- Parking:** Stalls in the alley between the Library and the Gym continue to be closed, additional stalls on North Road will be closed beginning 11/9. See attached map for closure.
- Utilities:** Power to library except for the essential HVAC circuits remain off. Water to the Library will be turned off for a few hours.
- Odors:** None
- Dust:** None





Measure E Bond Program
MODESTO JUNIOR COLLEGE CAMPUS
CONSTRUCTION UPDATE
continued (page 3 of 3)

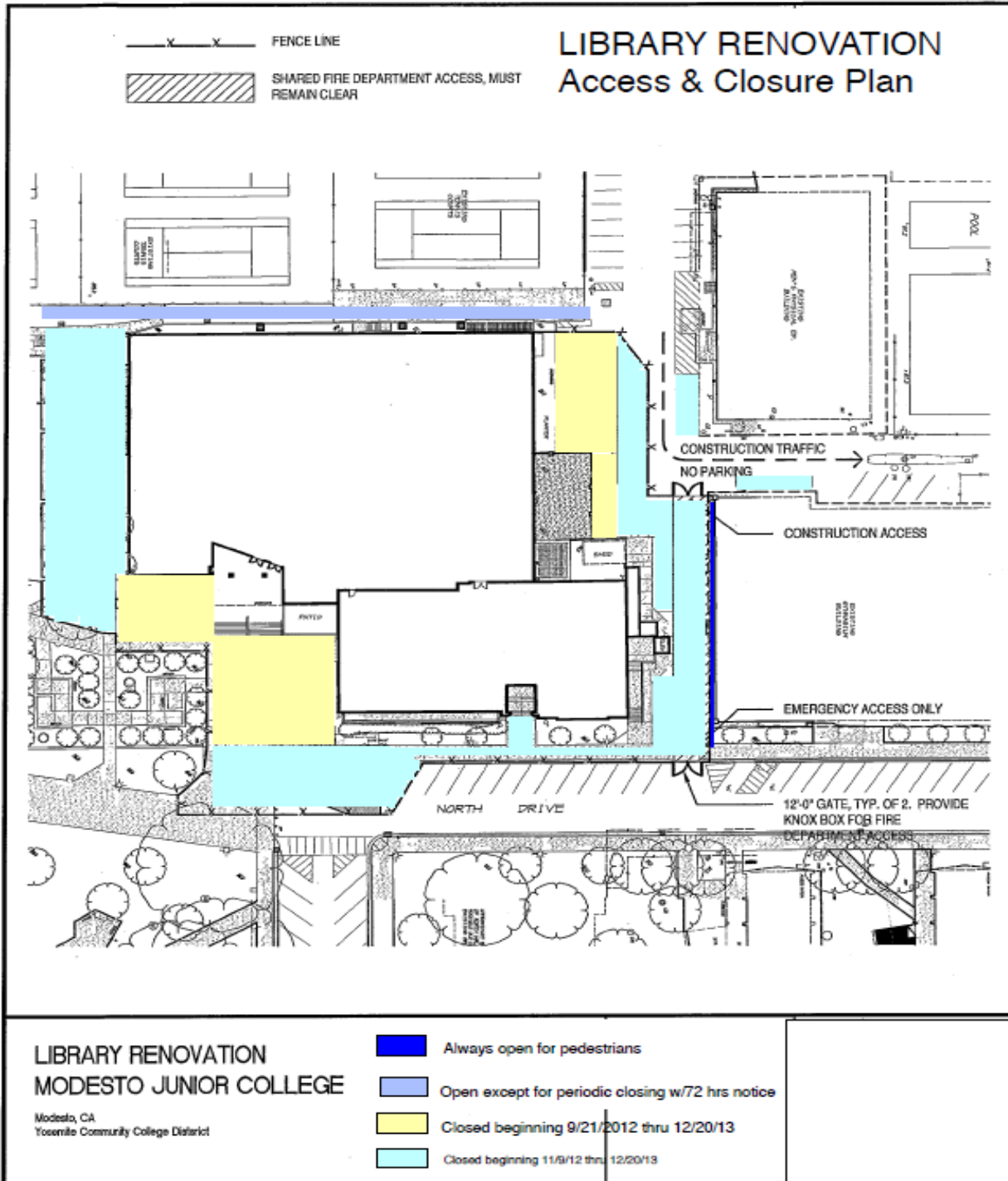

If there are any questions or concerns contact Kitchell CEM, Measure E Bond Construction Manager, located at 2201 Blue Gum Ave., Modesto CA 95358 Tel: 575-6991 Email mkennedy@kitchell.com

