

PERKINS
+ WILL



Ideas + buildings
that honor the broader
goals of society



↖ Modesto Junior College | Student Services Bldg.

INTRODUCTION AND PROJECT TEAMS

Introduction

This document outlines the project program and design priorities for the new Student Services Project for the Modesto Junior College East Campus. The Campus is one of two that comprise Modesto Junior College. The College began in 1921 is situated in the Central Valley, serving an agricultural and manufacturing based economy. It is one of two comprehensive colleges within the Yosemite Community College District, which covers a 4,500 square mile area encompassing all of two counties (Stanislaus and Tuolumne) and parts of four others (Calaveras, Merced, San Joaquin and Santa Clara).

The new Student Services Project will consolidate the existing Student Services programs spread throughout East Campus, incorporate a Testing Center currently housed on West Campus, and allow for some growth in these programs. The project site is located at the heart of the campus, adjacent to the existing Morris Memorial Building in the landscaped campus quad near the main pedestrian circulation route. The District and the Campus want the new Student Services Project to be the missing front door to the East Campus, and to include a One Stop Shop approach to student services. The building should be contemporary and clearly identifiable as a landmark building, but also be harmonious with the existing campus fabric.

Architectural Team:

Robert Lavey – Principal in Charge
Nick Seierup – Design Principal
Sandra Corazzelli – Project Manager
Leigh Christy – Project Architect
Brian Knight – Project Designer

Campus Executive Committee:

Bob Nadell – Vice President of Student Services, Modesto Junior College
Tim Nesbitt – Director, Facilities Planning & Operations, Yosemite Community College District
Judy Lanchester – Asst. Director, Facilities Planning & Operations, Yosemite Community College District
Matt Kennedy – Program Manager, Kitchell
Marie Otaya – Project Manager, Kitchell

Student Services Planning Committee:

Susie Agostini – Dean, Admissions & Records / Testing & Assessment, MJC
Judy Drummond – Admissions & Records / Welcome Center, MJC
Myra Rush – Director, Financial Aid / Veterans, MJC
Carol McKenzie – Financial Aid / Veterans, MJC
Derek Waring – Dean, Counseling & Student Services, MJC
Pam Crittenden – Counseling, MJC
Linda Wong – Counseling, MJC
June Hunt – Career Development & Transfer Center, MJC
Claudia Ramirez – Career Development & Transfer Center, MJC
John Martinez – Dean, Special Programs, MJC
Hector Duarte – EOPS, MJC
Nancee Carrillo – Alternate Media, MJC
Francisco Banuelos – Director, PreCollege, MJC
Flerida Arias – PreCollege, MJC
Wendy Byrd – Director, Student Development & Campus Life, MJC
Martha Robles – Director, Student Success & Special Projects, MJC
Araceli Balieal – Health Services, MJC
Valerie Parker – Health Services, MJC
Cecilia Vera – Health Services, MJC

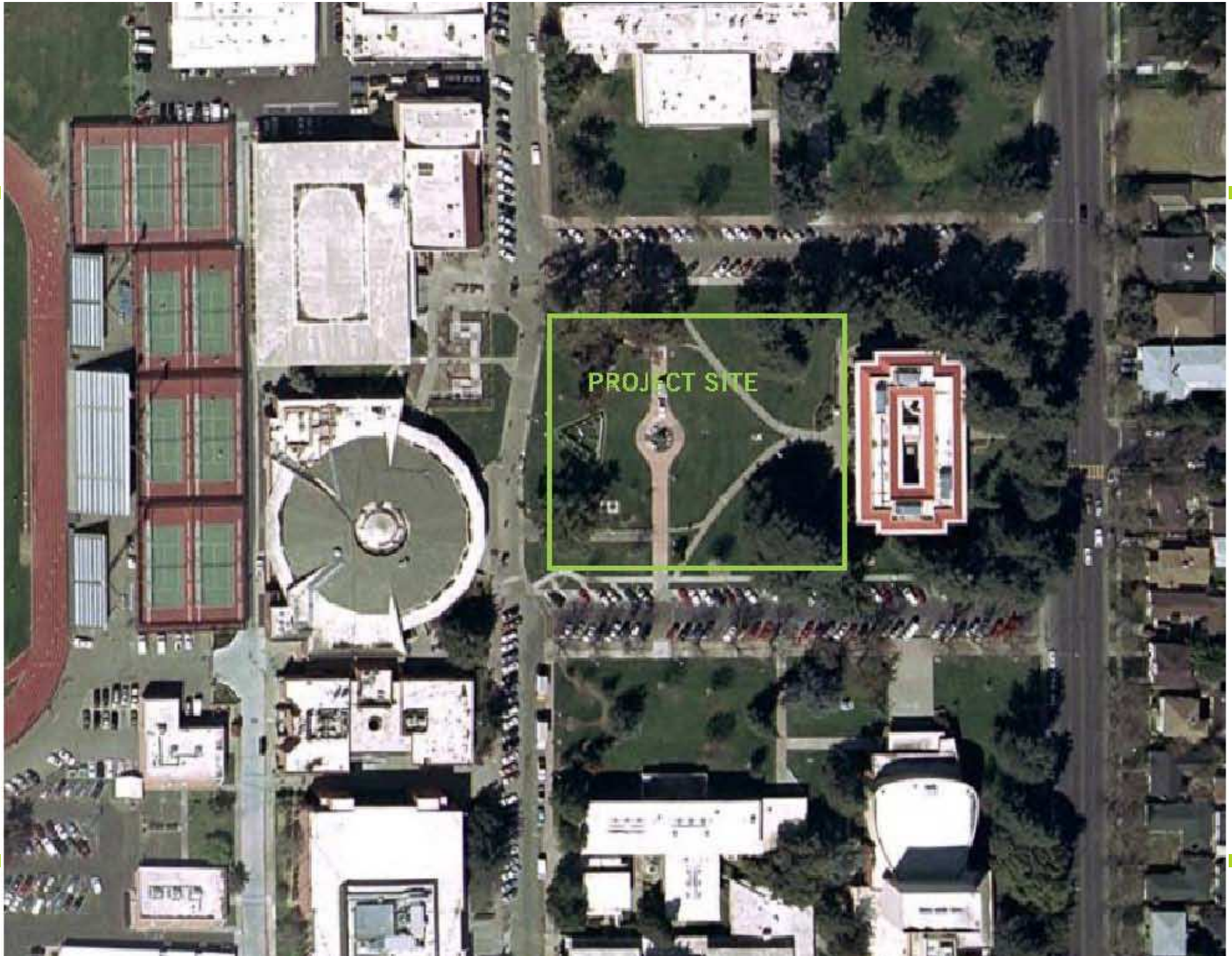

Alternate Stacking Options

STACKING DIAGRAMS

STUDENT SERVICES BUILDING (NEW CONSTRUCTION)



MORRIS MEMORIAL BUILDING (EXISTING RENOVATION)



Three-story Scheme

There is one proposed scheme that is configured into a three-story structure. The above diagram shows the relationships between the floors based on programming in both the new building (upper diagram) and the Morris Memorial Building (lower diagram).

STACKING DIAGRAMS

STACKING DIAGRAMS

STUDENT SERVICES BUILDING (NEW CONSTRUCTION)

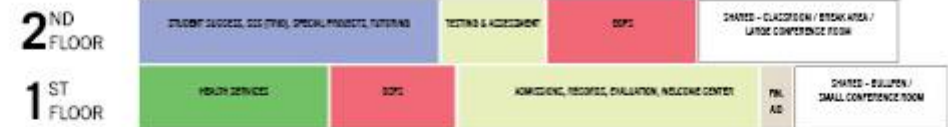

MORRIS MEMORIAL BUILDING (EXISTING RENOVATION)



Two-story Schemes

There are two proposed schemes that are configured into a two-story structure. The above diagram shows the relationships between the floors based on programming in both the new building (upper diagram) and the Morris Memorial Building (lower diagram).

Alternate Siting Options



1. The Slider



2. The Line Drive



3. The Triple

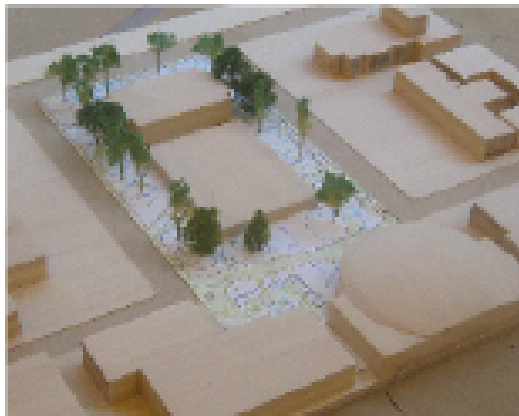

4. The Single



5. The On-Deck

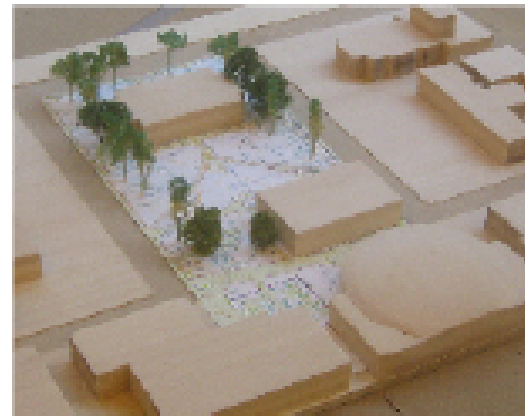

6. The Outfield

The On-Deck - 2 Story Morris Adjacent (MasterPlan)

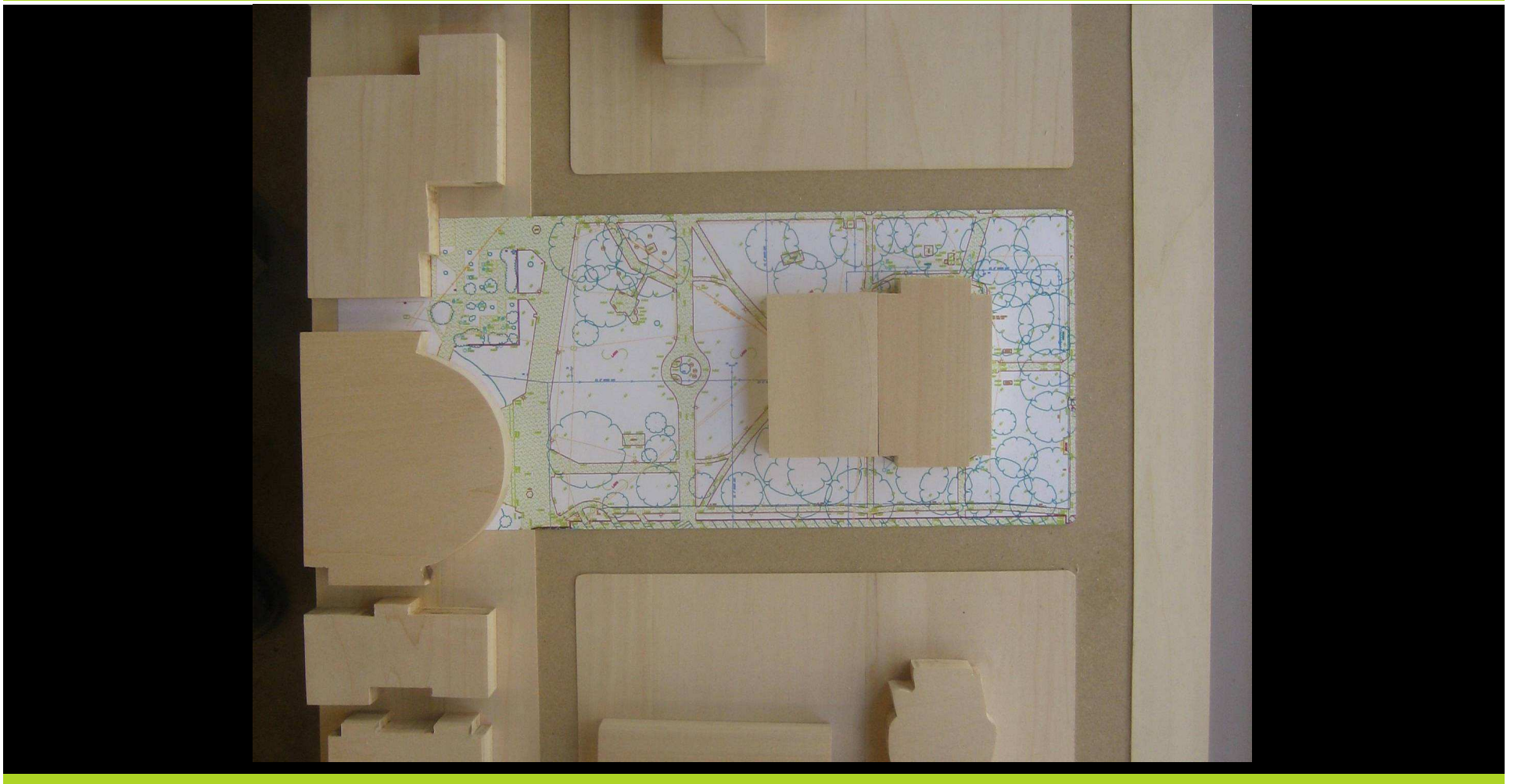

The On-Deck – 2 Story, Morris Adjacent (Master Plan)

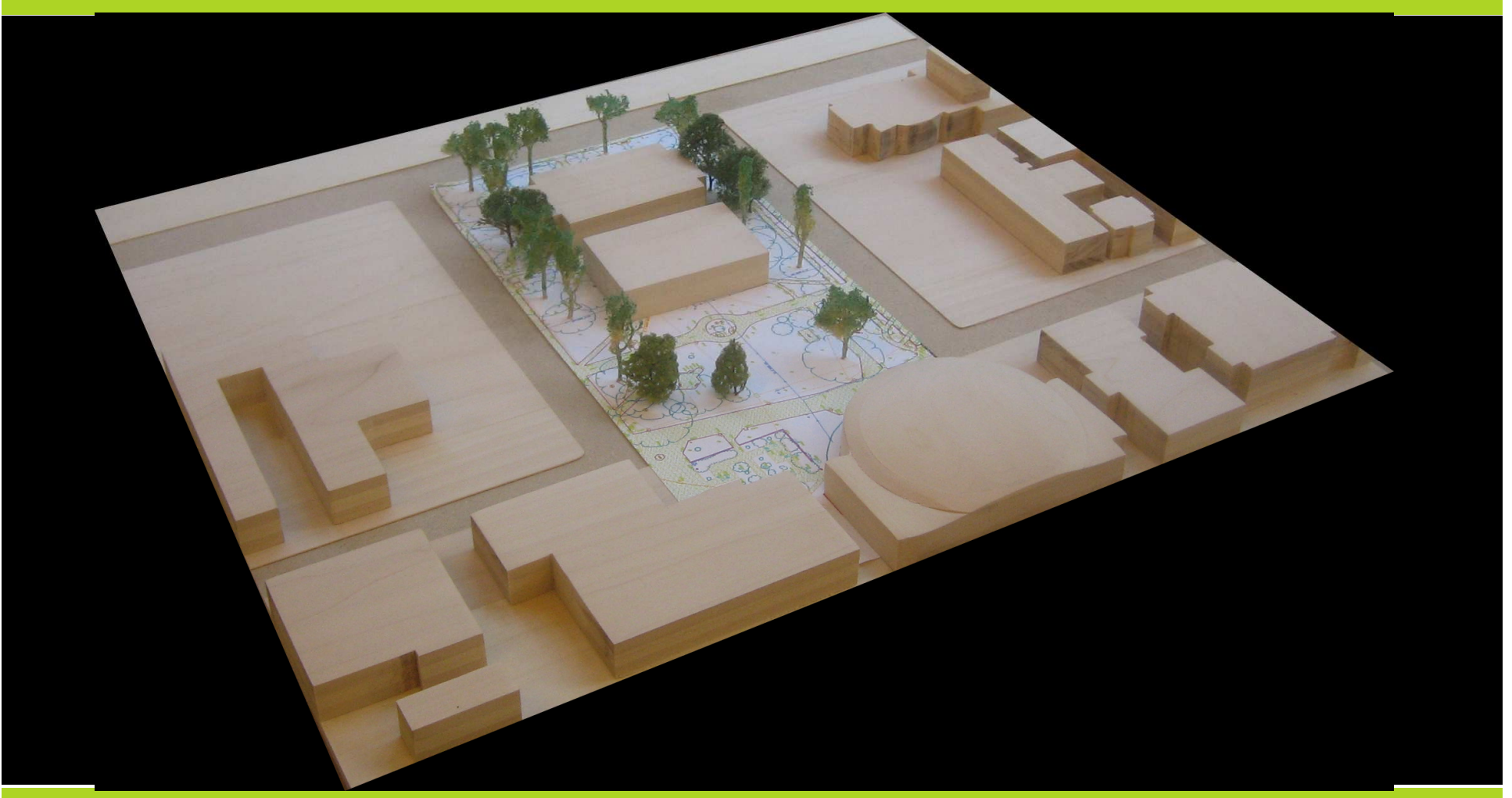

2 Story Morris Adjacent (Atrium)

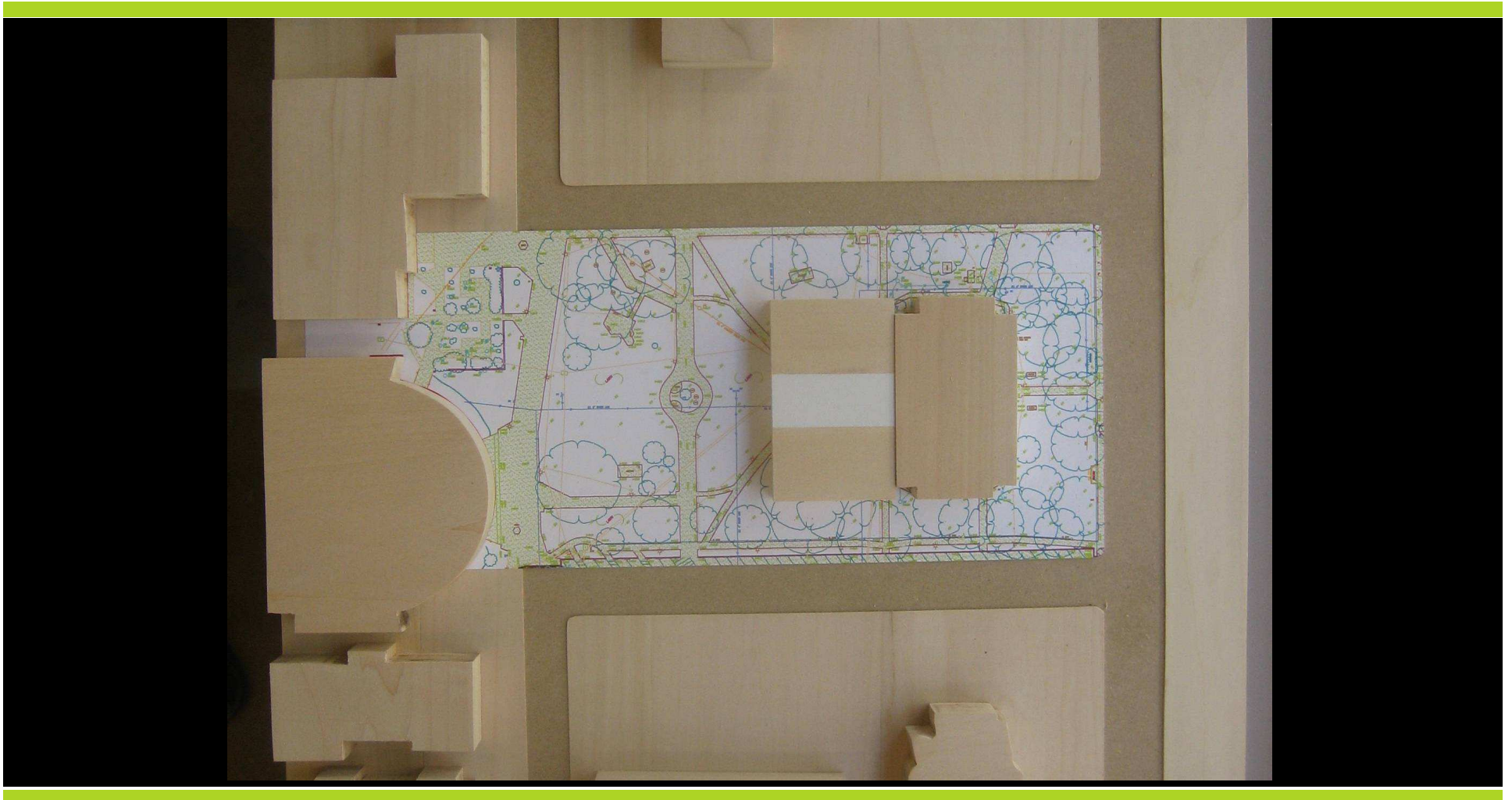

The Line Drive - 2 Story Atrium, Center

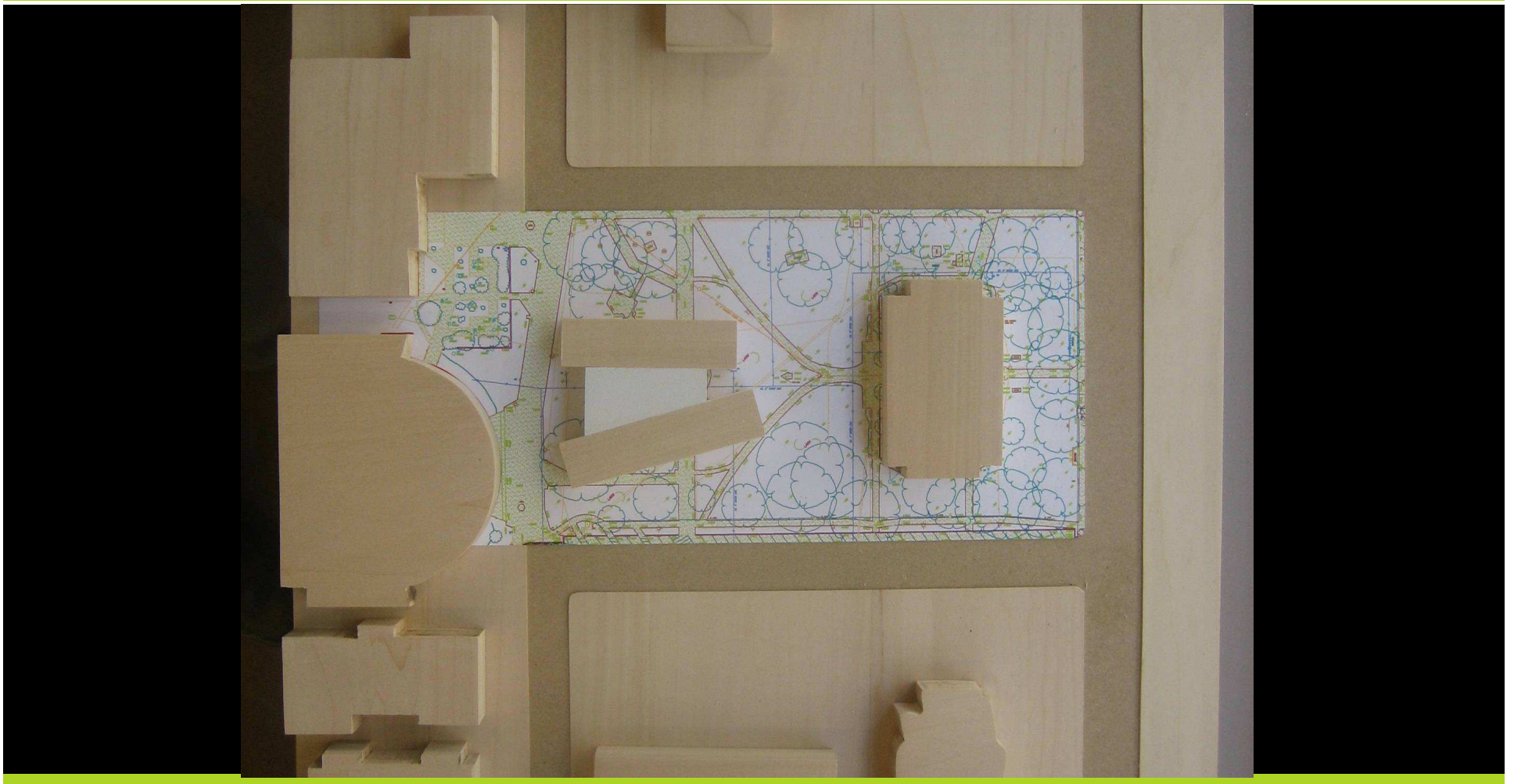

The Line Drive - 2 Story Atrium, Center



2 Story Atrium, South Side



The Single - 1 Story, Center

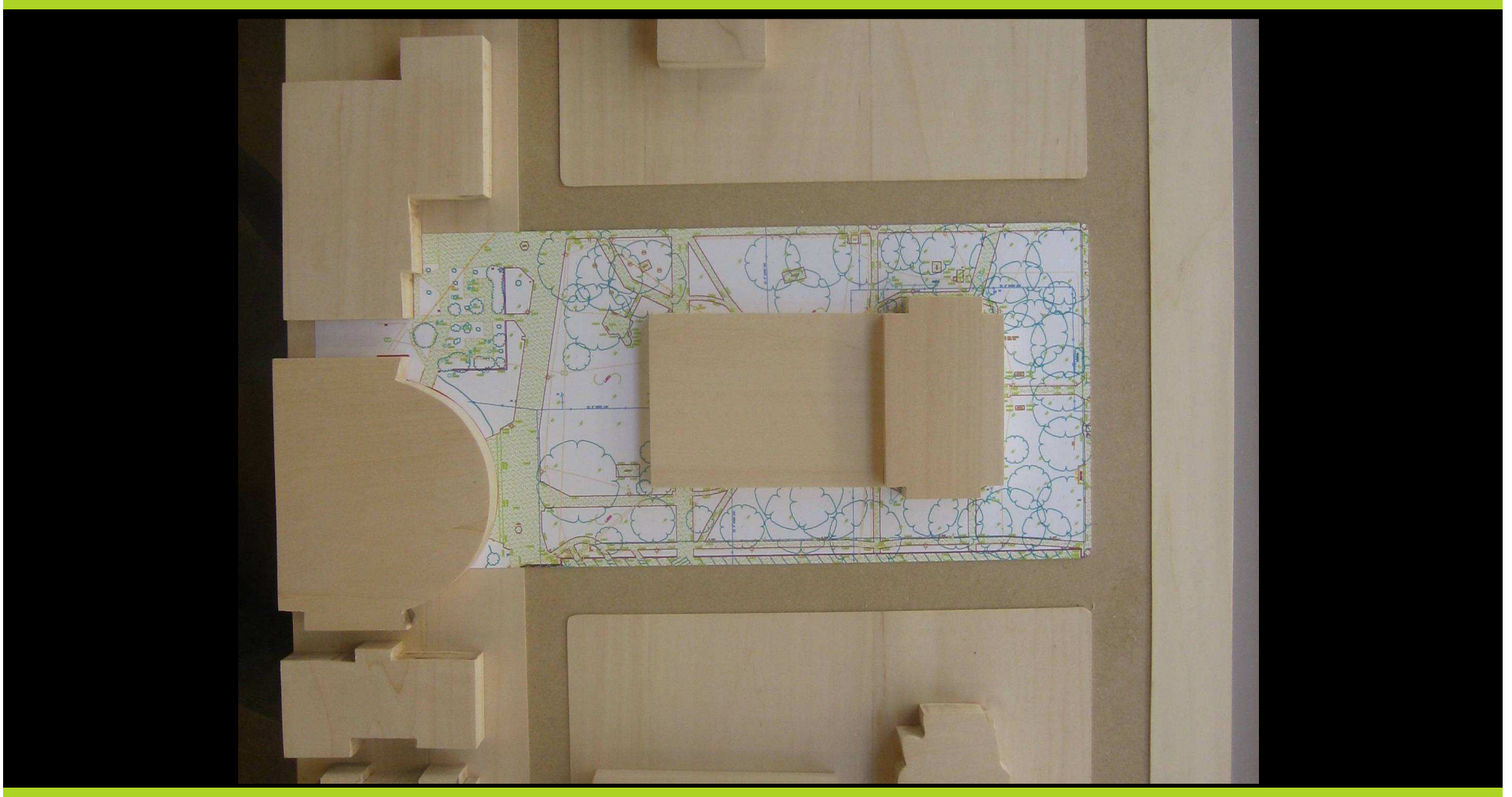

The Single - 1 Story, Center



The Outfield - 2 Story, Student Center Adjacent

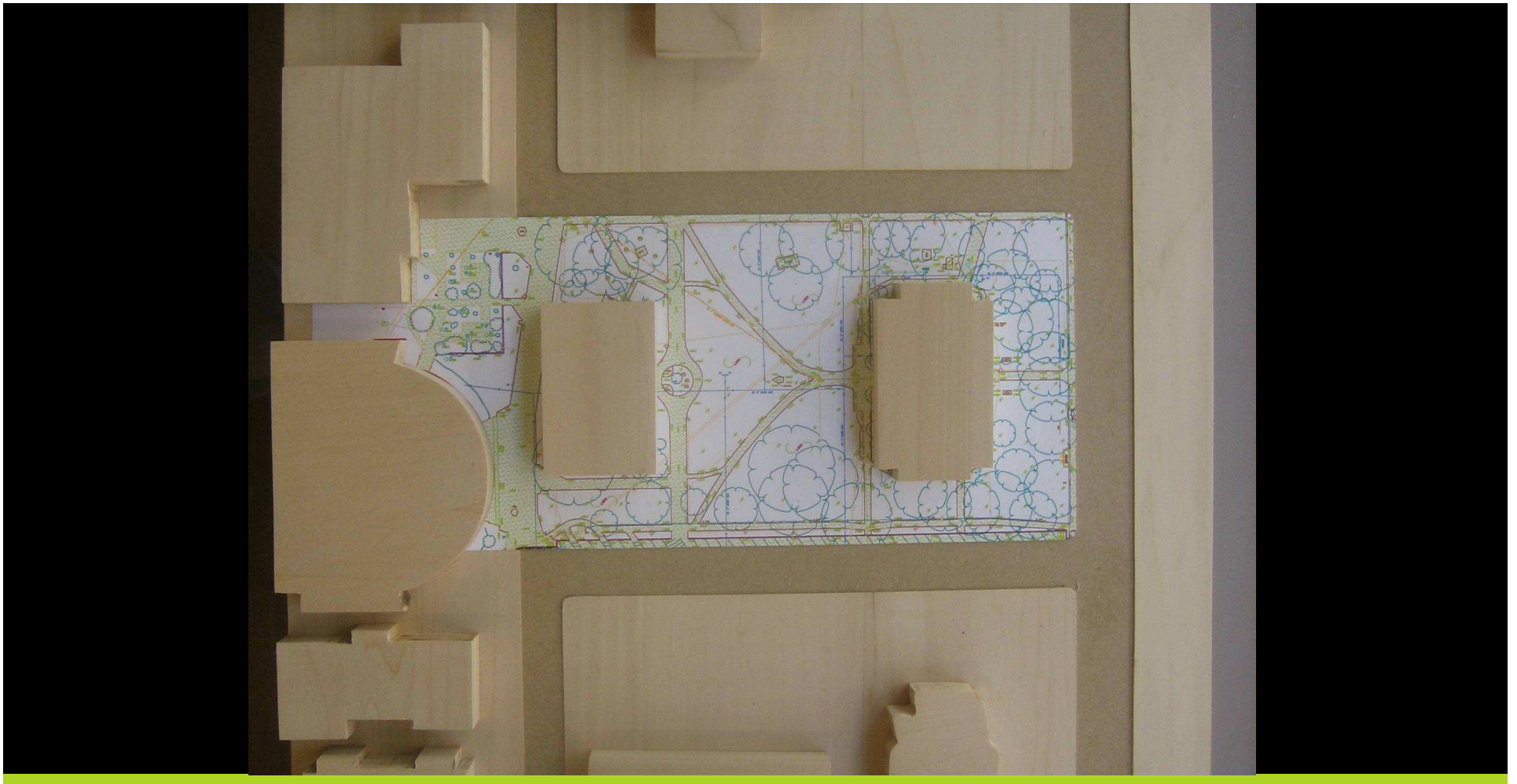

The Outfield - 2 Story, West (Student Center Adjacent)

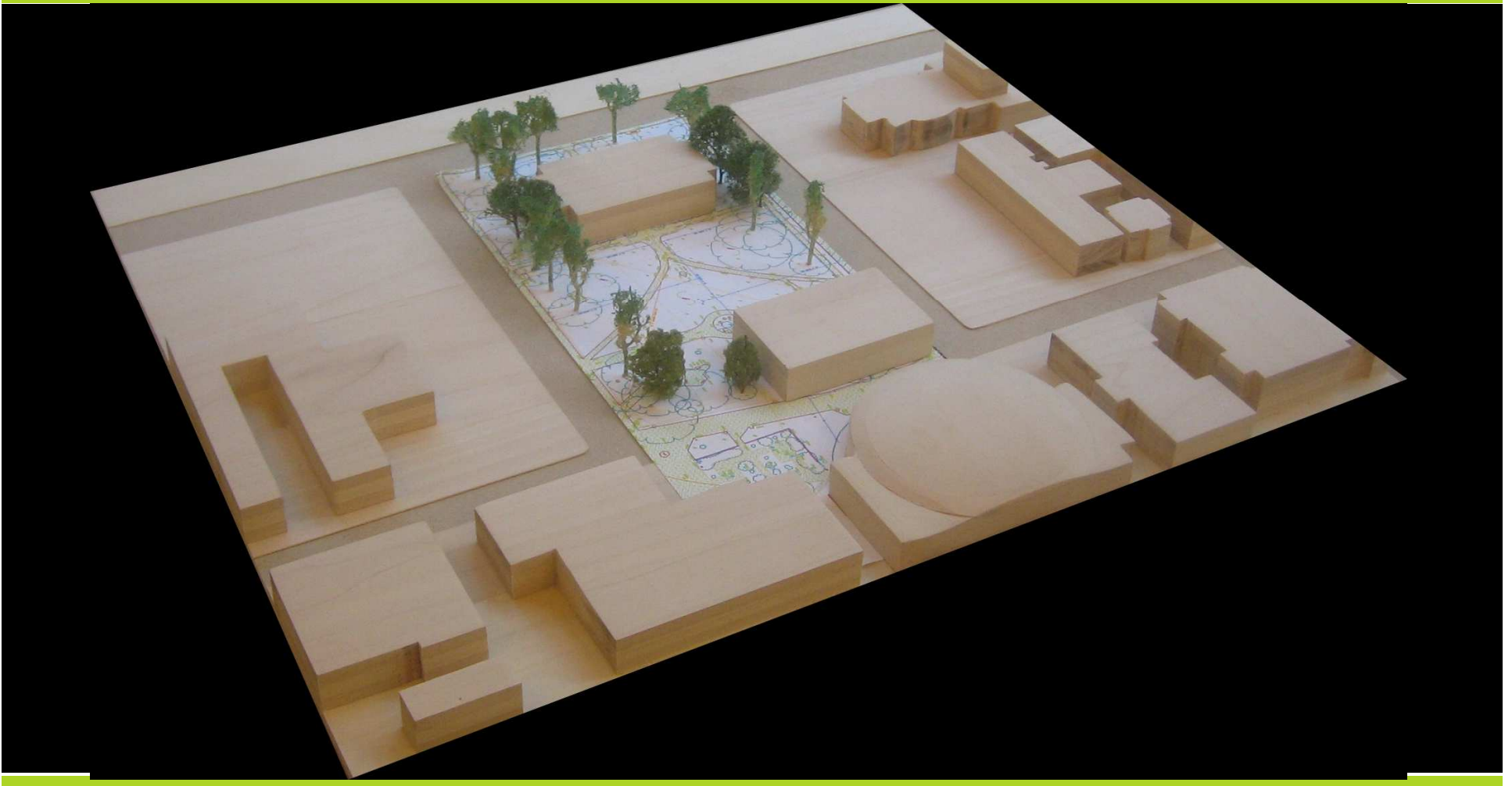

The Slider - 2 Story, South Side

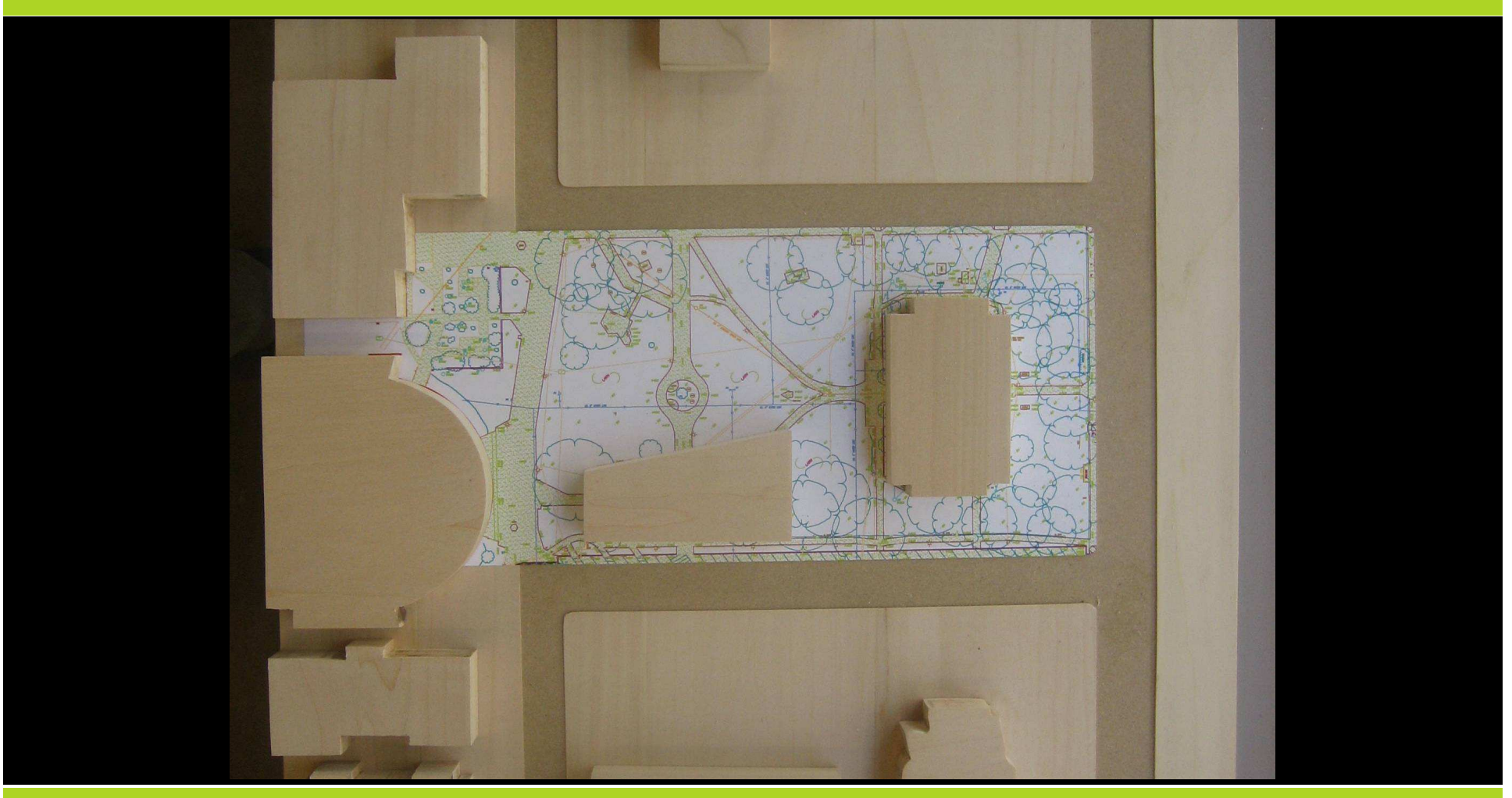

The Slider - 2 Story, South Side



The Triple - 3 Story, South Side



The Triple

PREFERRED SITING SCHEMES

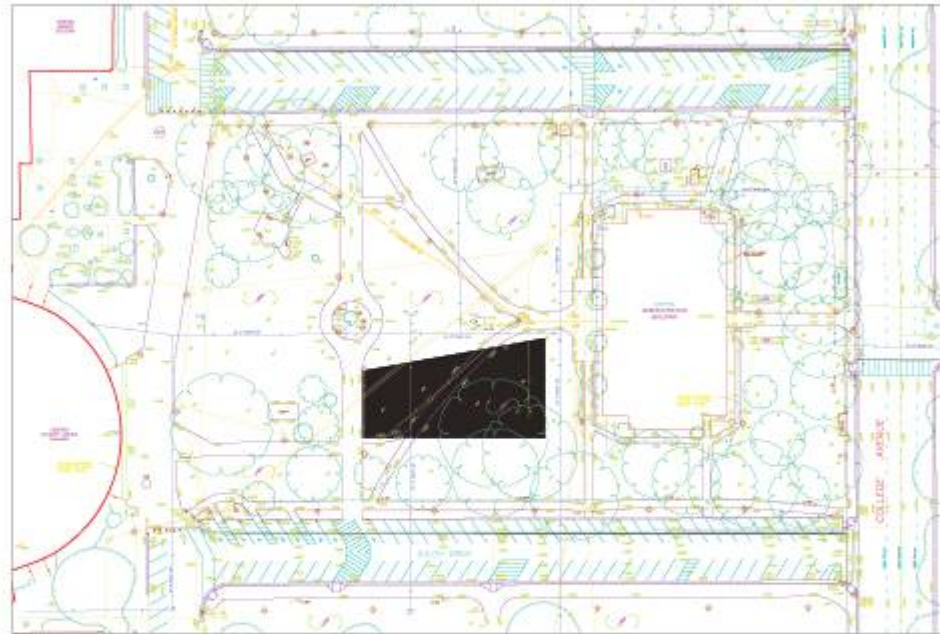

The Triple

This scheme moves part of the program into a three story building. This will allow for a much smaller footprint on the main quad, retaining a larger amount of existing green space. Its smaller perimeter will still allow for the visual connection between the Morris and Student Center buildings and its north facing main entrance will open out onto the main green space of the campus. The height of the building will help emphasize that this is the heart of the campus. This more prominent building will announce itself—and the campus—to the city of Modesto. Although the prominence of the building and the larger amount of retained green space are beneficial to the site, the smaller floorplates may result in a less efficient building. This scheme will result in the loss of one or two of the existing trees on the site.

The Slider

PREFERRED SITING SCHEMES

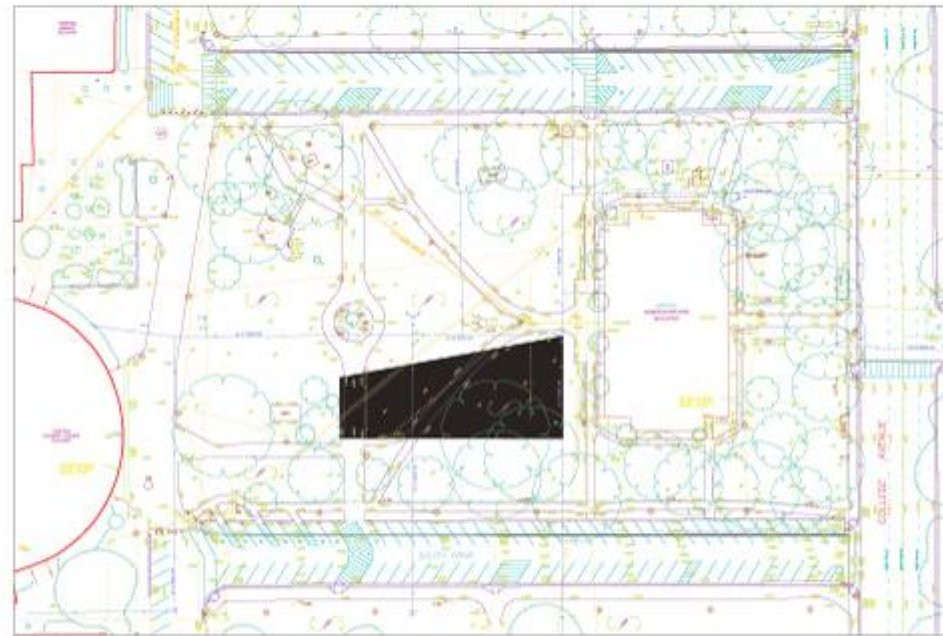

The Slider

This scheme attempts to act as the connective tissue that links the three structures that will house the comprehensive student service programs. The angled north face of the building links the Student Center front door with the Morris Building front door. This visual connection is important to creating a main space that includes unique individual buildings and maintains a cohesive feel between the structures. The main entrance will be on the north side of the building and will look out onto the main quad and the free speech steps. During times of high activity, the main quad will become the front yard for all three student services structures and will help activate the heart of the campus. This scheme will most likely result in the loss of one or two of the existing trees on the site.

The Line Drive

PREFERRED SITING SCHEMES

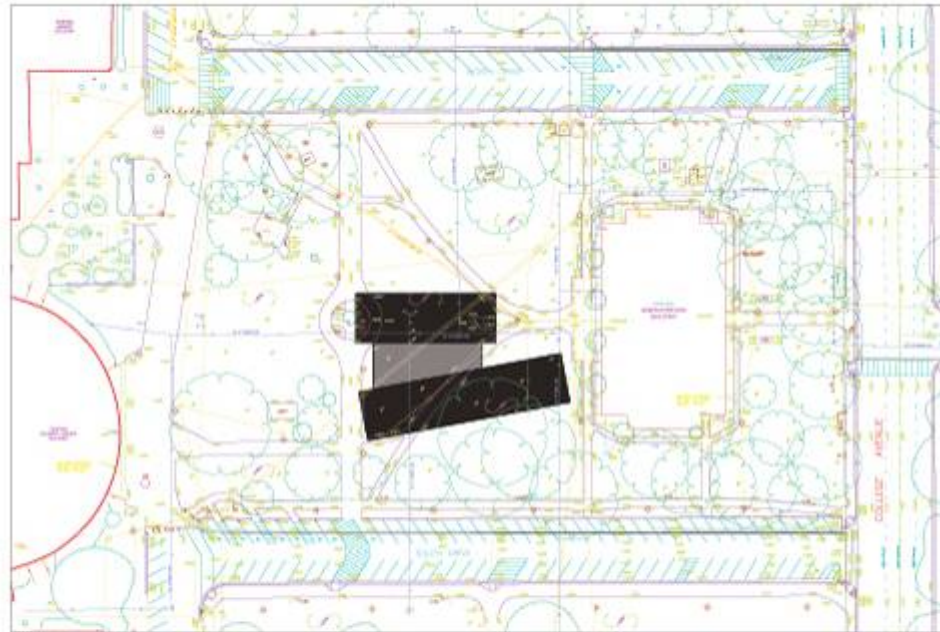

The Line Drive

This scheme attempts to retain the visual connection between the Morris Building and the Student Center by splitting the building into two main components. These wings are connected with a largely transparent "Bulldrop" area through which one maintains the visual connection between the main structures. The central location of the bulldrop allows for effective circulation between the constituent departments, both inside the new structure and into the departments that will remain in the existing structures. Although this version is more centrally located on the quad than the other schemes, it will result in the loss of none of the existing mature trees. It will result in three large green spaces in and around the new building allowing for discrete functions to occur simultaneously on the main quad.

A

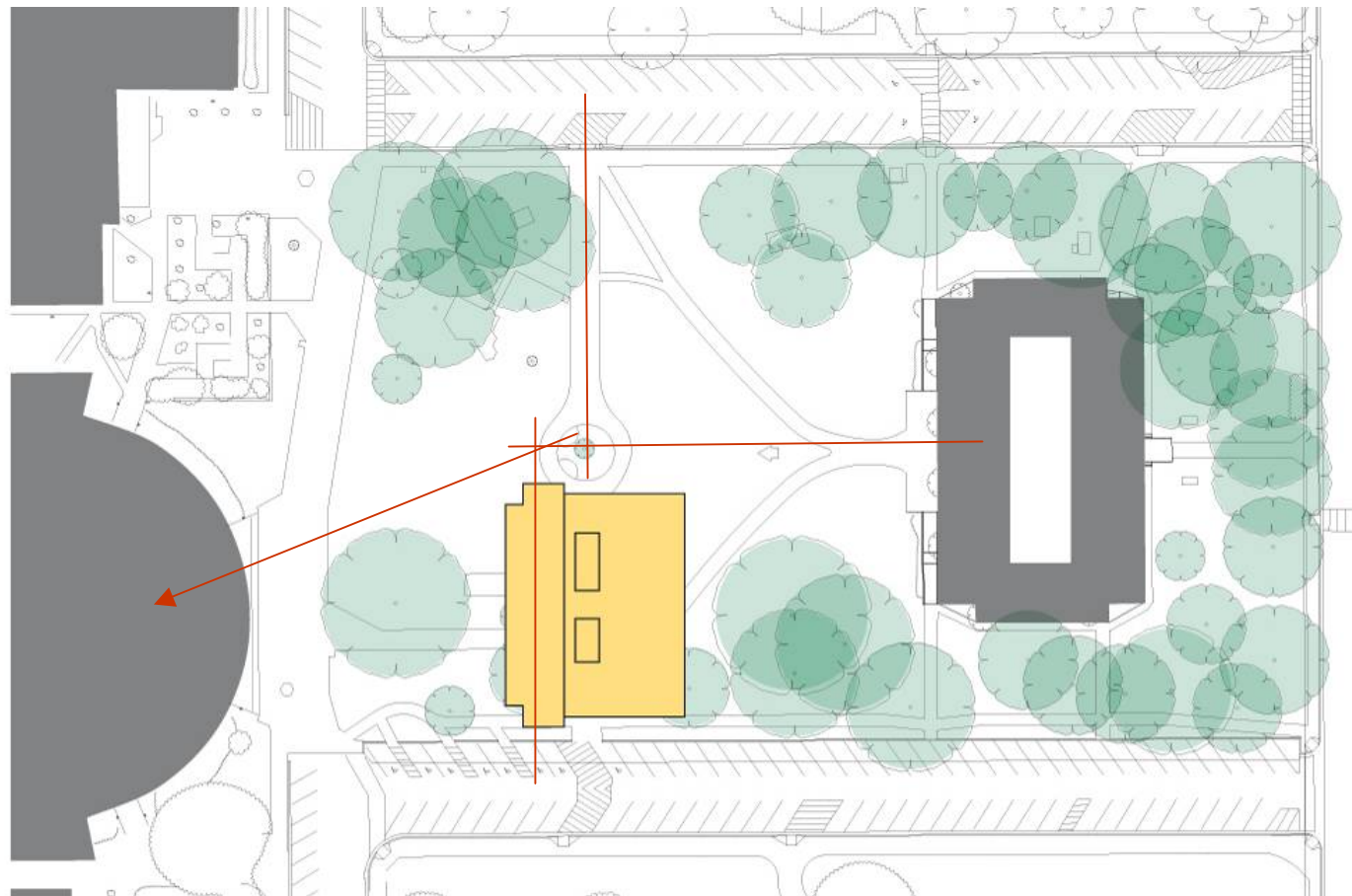

Scheme B
24,500 GSF



Scale: 1" = 50'

11.20.2007

B

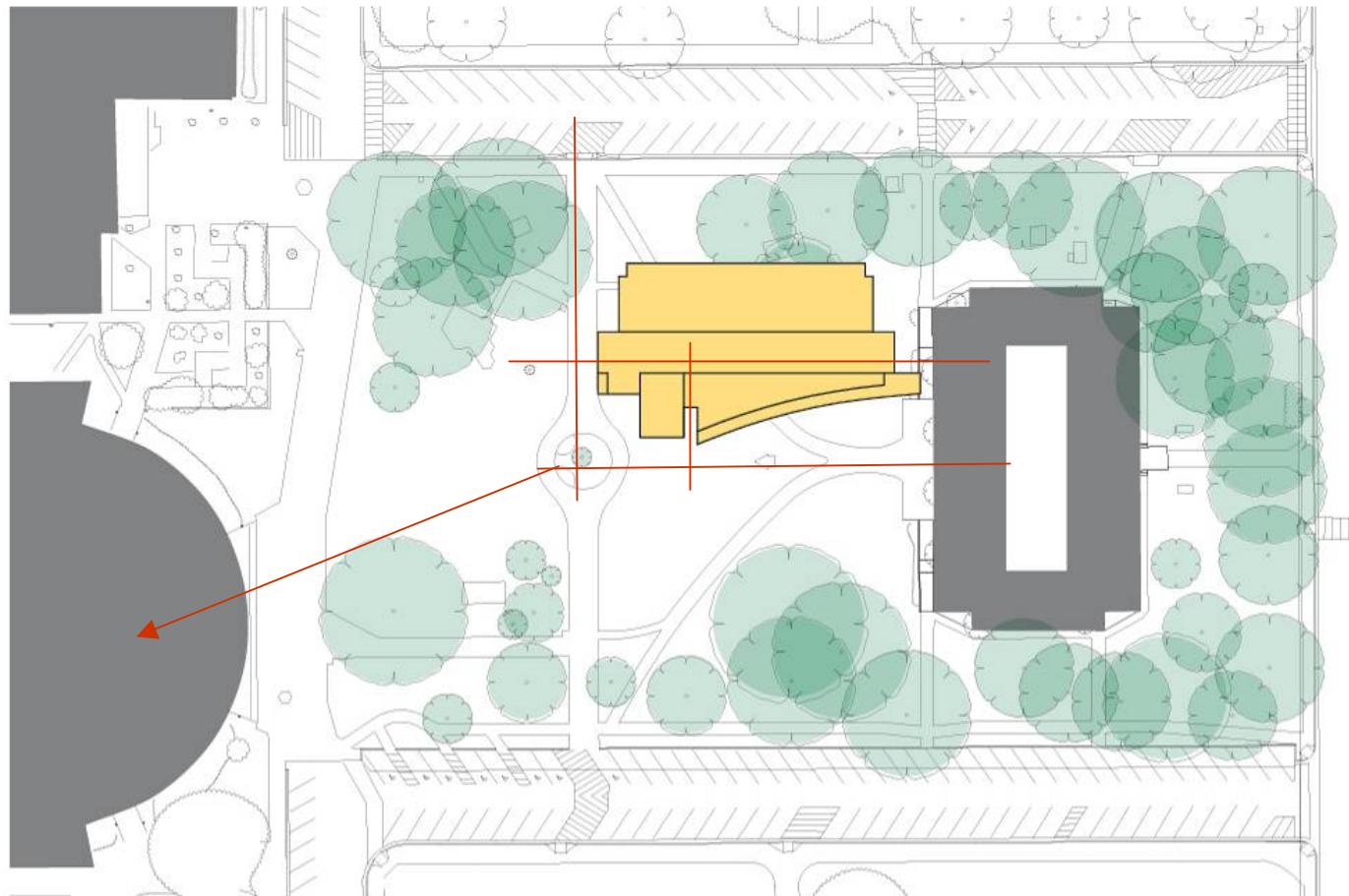

Scheme A
23,005 GSF



Scale: 1" = 50'

11.20.2007

C

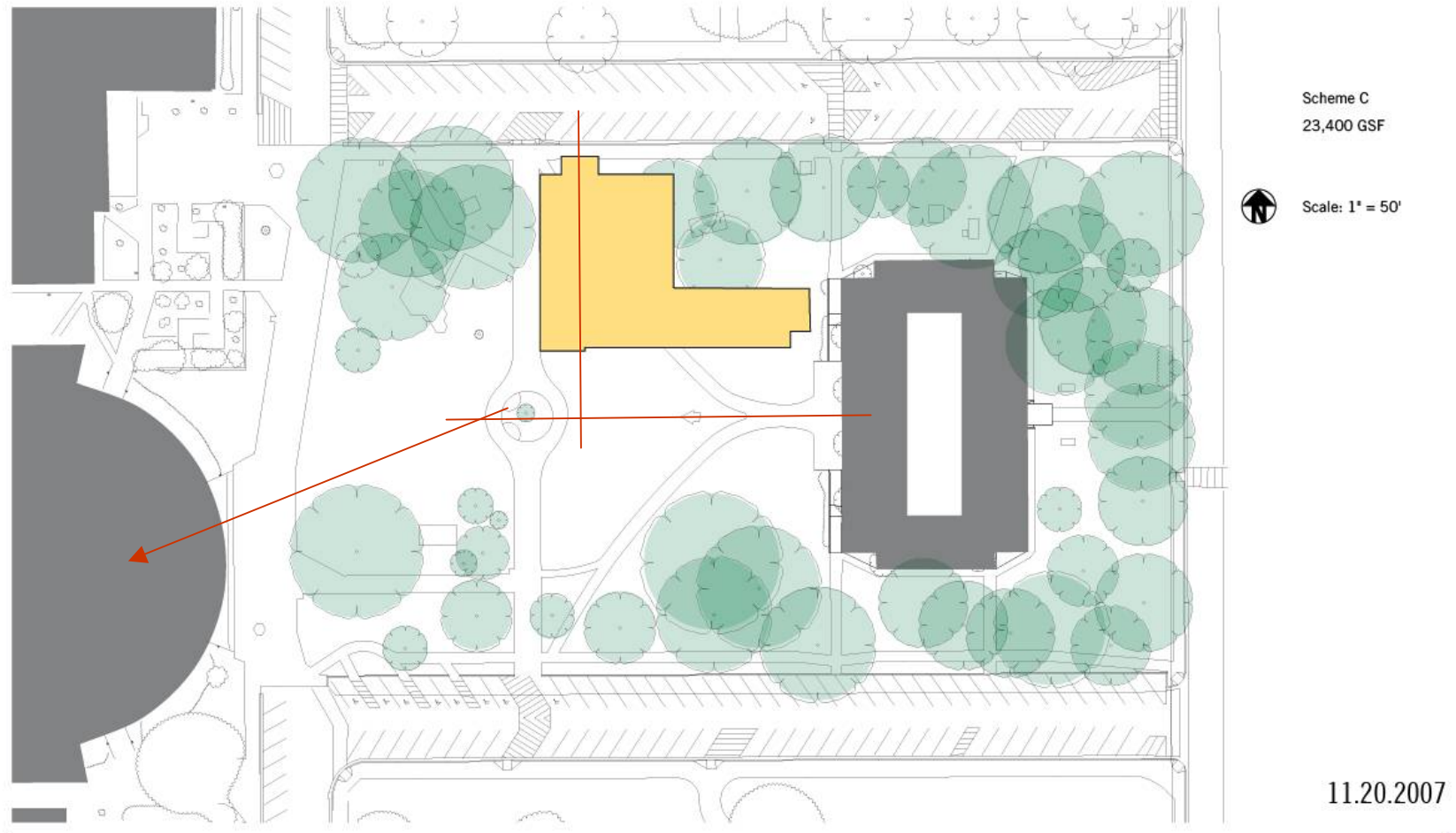

Site Plan

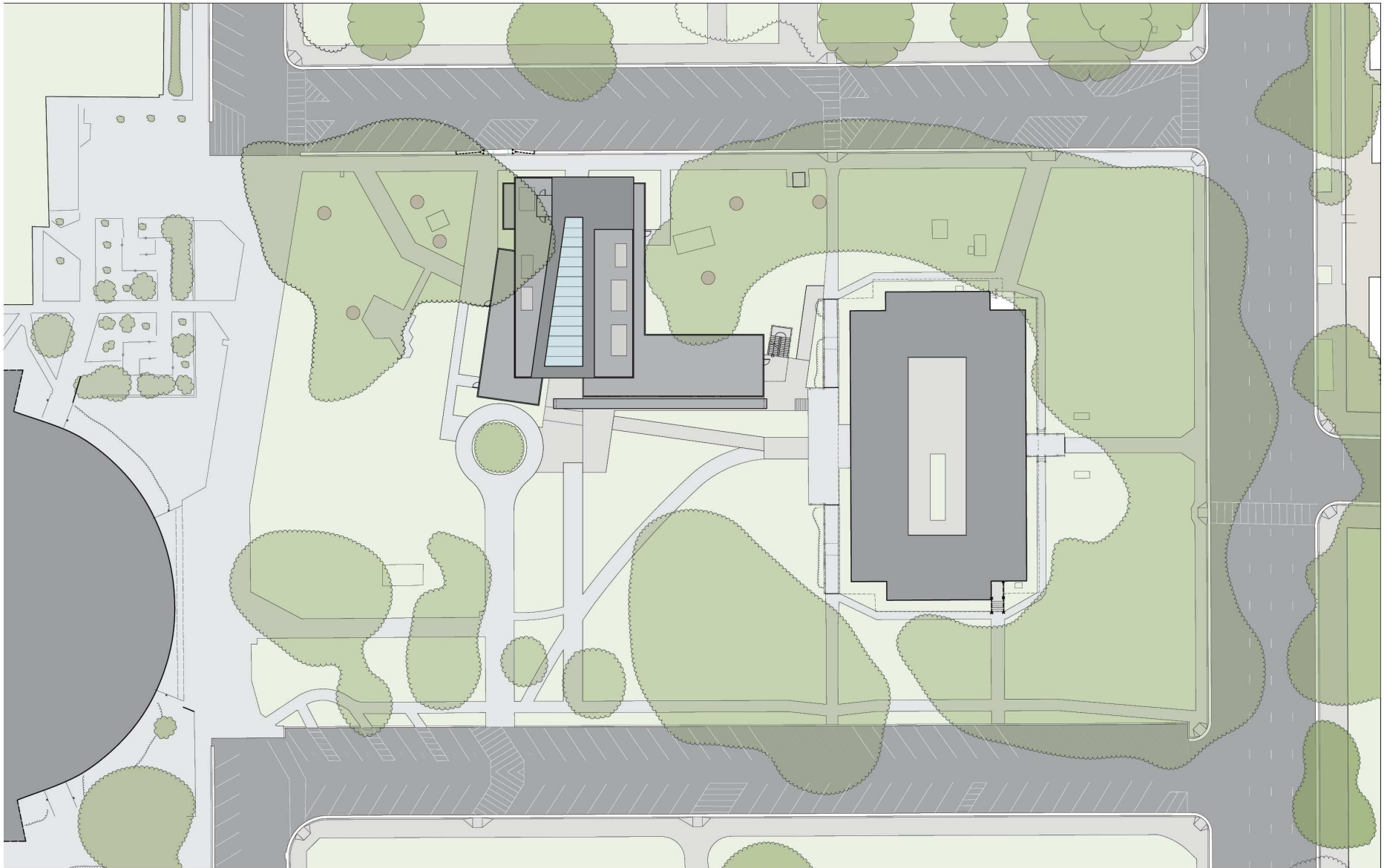

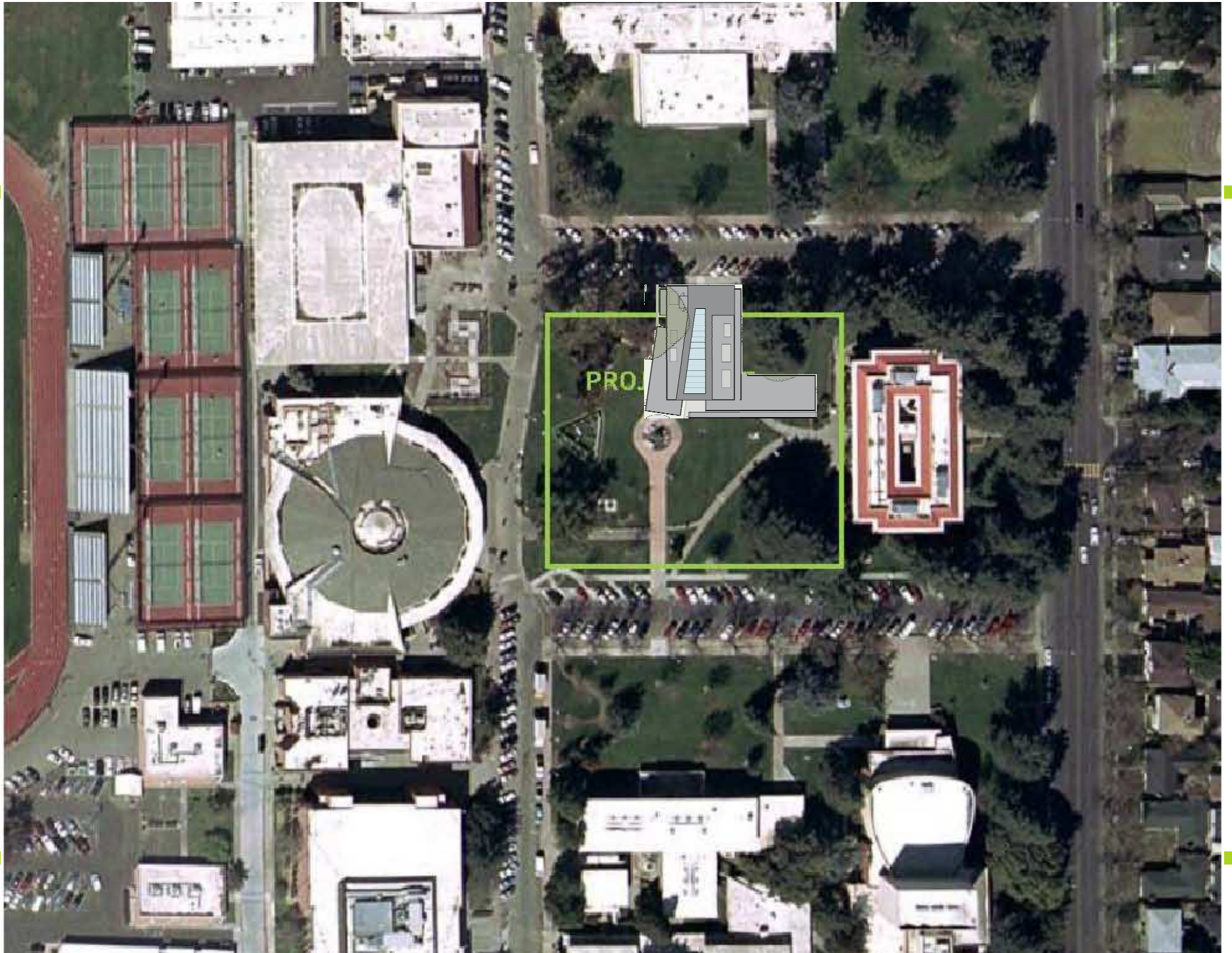

Site Plan

