



Measure E Bond Program MODESTO JUNIOR COLLEGE CAMPUS CONSTRUCTION UPDATE



UPDATES & ACTIVITIES THAT MAY IMPACT CAMPUS OPERATION *Week of May 20, 2013*

SCIENCE COMMUNITY CENTER

Work this week: Clean up and finish work ongoing. Working on punch list items. Continue move in of faculty and staff.

Access:	No anticipated impact
Noise:	Moderate impact
Parking:	No anticipated impact
Utilities:	No anticipated impact
Odors:	No anticipated impact
Dust:	No anticipated impact



INFRASTRUCTURE

Work this week: Continued installation of way finding signs. Continued site grading, completing concrete benches and preparing for landscaping.

Access:	Moderate impact
Noise:	No anticipated impact
Parking:	No anticipated impact
Utilities:	No anticipated impact
Odors:	No anticipated impact
Dust:	No anticipated impact



SHIPPING & RECEIVING BLDG

Work this week: Continued installation of MEP systems. Paint and texture interior walls. Continue landscaping.

Access:	Caution at G Street and 5 th Street
Noise:	Moderate: equipment & deliveries
Parking:	No anticipated impact
Utilities:	No anticipated impact
Odors:	No anticipated impact
Dust:	No anticipated impact

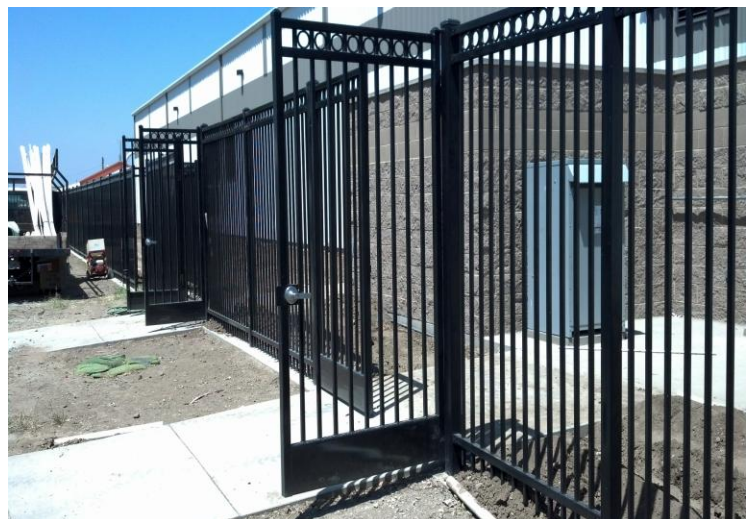



Measure E Bond Program MODESTO JUNIOR COLLEGE CAMPUS CONSTRUCTION UPDATE *continued (page 2 of 4)*

PRIMARY DATA CENTER

Work this week: Installation of AC units on roof. Continue under access floor rough-in of electrical, mechanical and plumbing systems in data room. Continued installation of electrical panels and equipment in UPS rooms. Pull wire to UPS rooms. Install interior doors and hardware.

Access:	Caution at G Street and 3 rd street.
Noise:	Moderate impact
Parking:	No anticipated impact
Utilities:	No anticipated impact
Odors:	No anticipated impact
Dust:	Moderate impact



LIBRARY RENOVATION

Work this week: Continue painting, interior finishes and electrical installation. Continue exterior site work and roof demolition.

Access:	See access map below
Noise:	Moderate: equipment & deliveries
Parking:	See attached map for closure.
Utilities:	None
Odors:	None
Dust:	None



CAREER TRANSFER CENTER

Work this week: Continue demolition and abatement in the area between the bookstore and the café and in the men's and women's restrooms.

Access:	See updated access map below
Noise:	Moderate: equipment & deliveries
Parking:	See attached map for closure.
Utilities:	None
Odors:	None
Dust:	None





Measure E Bond Program
MODESTO JUNIOR COLLEGE CAMPUS
CONSTRUCTION UPDATE
continued (page 3 of 4)

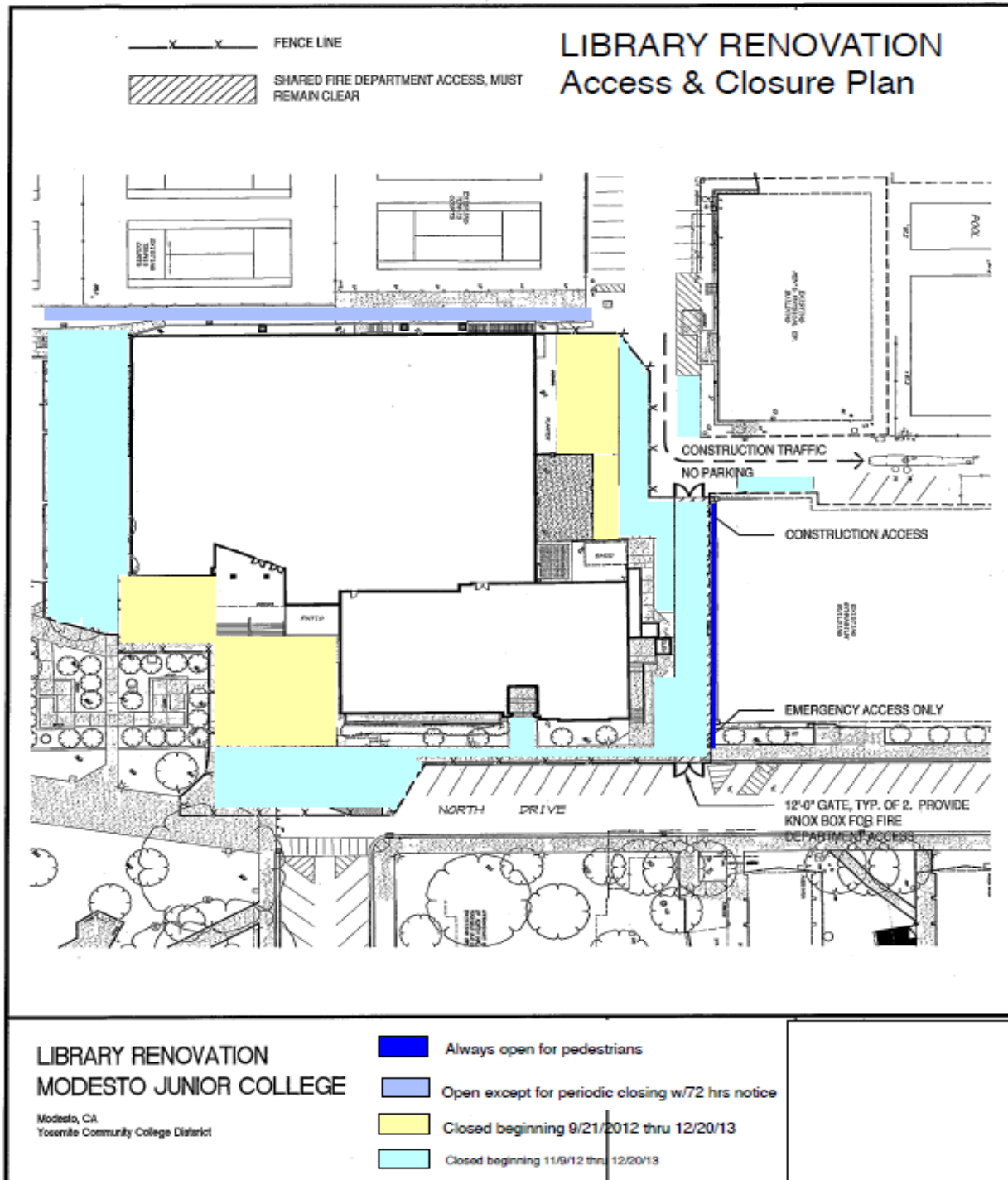



Measure E Bond Program
MODESTO JUNIOR COLLEGE CAMPUS
CONSTRUCTION UPDATE
continued (page 4 of 4)

CAREER DEVELOPMENT & TRANSFER CENTER – Access & Closure Map (Updated 05/09/2013)

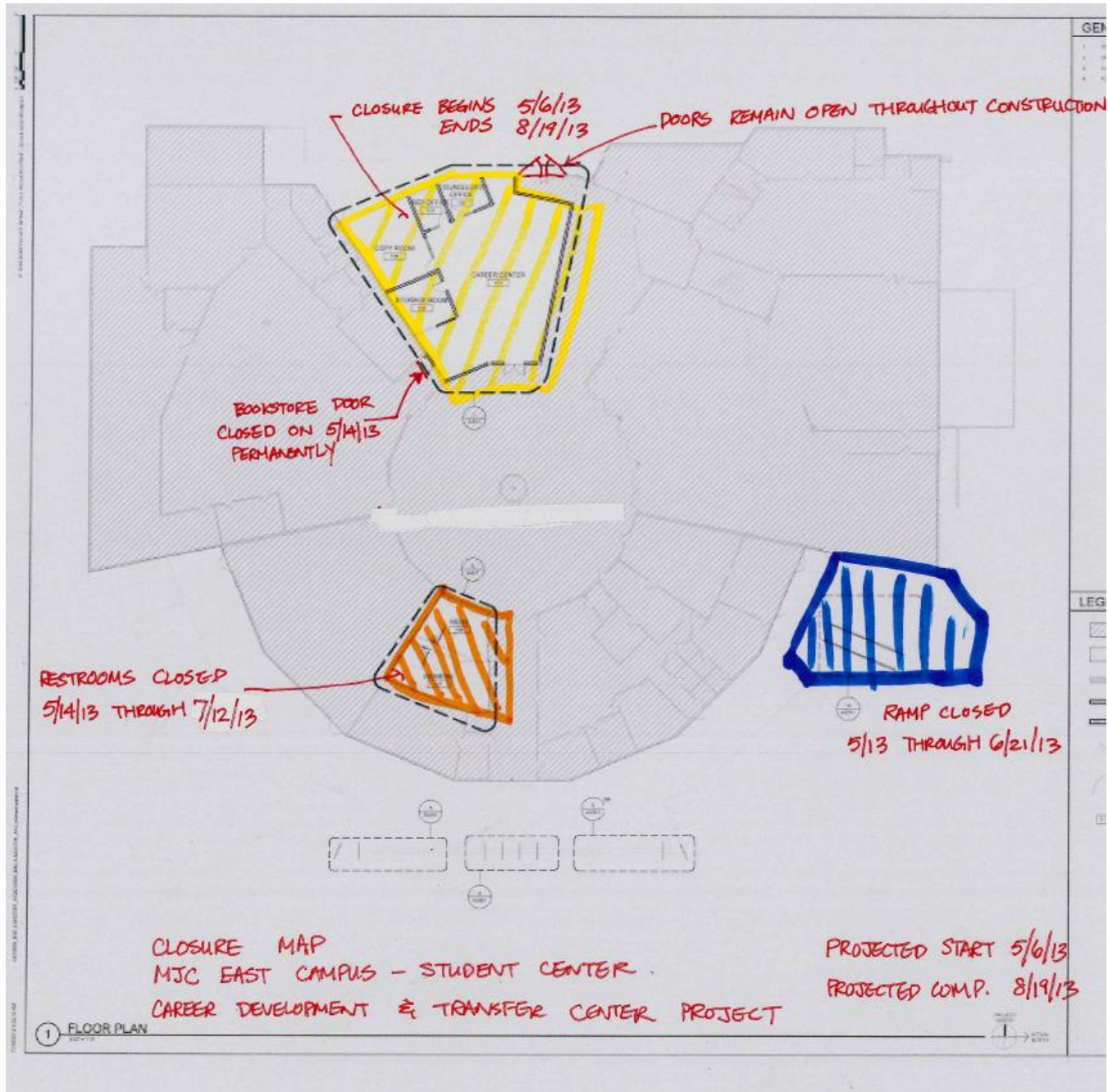

If there are any questions or concerns contact Kitchell CEM, Measure E Bond Construction Manager, located at 2201 Blue Gum Ave., Modesto CA 95358 Tel: 575-6991 Email mkennedy@kitchell.com

