



**UPDATES & ACTIVITIES THAT MAY IMPACT
 CAMPUS OPERATION**

Week of May 6, 2013

SCIENCE COMMUNITY CENTER

Work this week: Clean up and finish work ongoing. Working on punchlist items.

- Access:** No anticipated impact
- Noise:** Moderate impact
- Parking:** No anticipated impact
- Utilities:** No anticipated impact
- Odors:** No anticipated impact
- Dust:** No anticipated impact



INFRASTRUCTURE

Work this week: Continued installation of way finding signs. Clearing and cleaning site between Science and Allied Health building.

- Access:** Moderate impact
- Noise:** No anticipated impact
- Parking:** No anticipated impact
- Utilities:** No anticipated impact
- Odors:** No anticipated impact
- Dust:** No anticipated impact



SHIPPING & RECEIVING BLDG

Work this week: Metal building construction, installation of metal wall and roof panels. Metal stud framing, interior rough in mechanical, electrical and plumbing. Paint and texture interior walls.

- Access:** None
- Noise:** Moderate: equipment & deliveries
- Parking:** No anticipated impact
- Utilities:** No anticipated impact
- Odors:** No anticipated impact
- Dust:** No anticipated impact





Measure E Bond Program MODESTO JUNIOR COLLEGE CAMPUS CONSTRUCTION UPDATE *continued (page 2 of 4)*

PRIMARY DATA CENTER

Work this week: Continued installation for metal roof system. Continue setting equipment in electrical yard and install AC units on roof. Grading parking lot. Under access floor rough-in of electrical, mechanical and plumbing systems in data room.

- Access:** Caution at G Street and 3rd street.
- Noise:** Moderate impact
- Parking:** No anticipated impact
- Utilities:** No anticipated impact
- Odors:** No anticipated impact
- Dust:** Moderate impact



LIBRARY RENOVATION

Work this week: Continue interior framing and gypsum board installation. Continue pulling wire through conduits. Texture and paint walls. Removal of roof. Removal of exterior flatwork. Installation of storefronts.

- Access:** **Alley closed May 9th from 3:30am - 6:00am.**
See updated access map below
- Noise:** Moderate: equipment & deliveries
- Parking:** See attached map for closure.
- Utilities:** None
- Odors:** None
- Dust:** None



CAREER TRANSFER CENTER

Work this week: Set-up temporary fencing of construction area.

- Access:** **See closure map below**
- Noise:** Moderate: equipment & deliveries
- Parking:** See attached map for closure.
- Utilities:** None
- Odors:** None
- Dust:** None

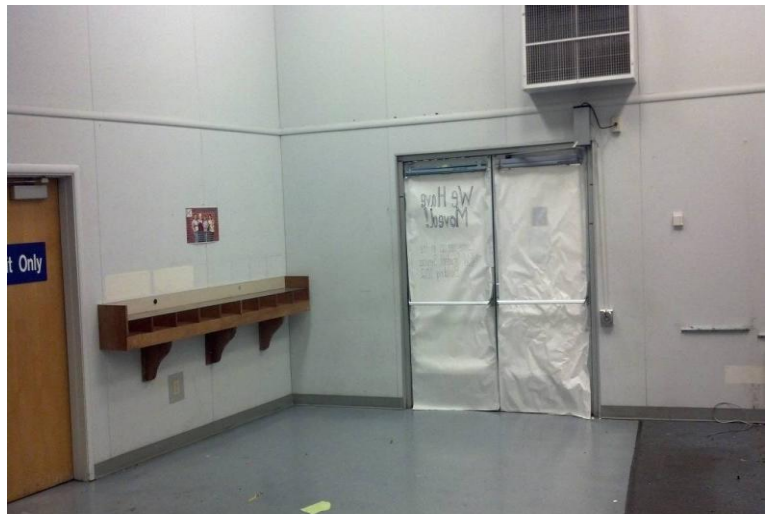



Measure E Bond Program
MODESTO JUNIOR COLLEGE CAMPUS
CONSTRUCTION UPDATE
continued (page 3 of 4)

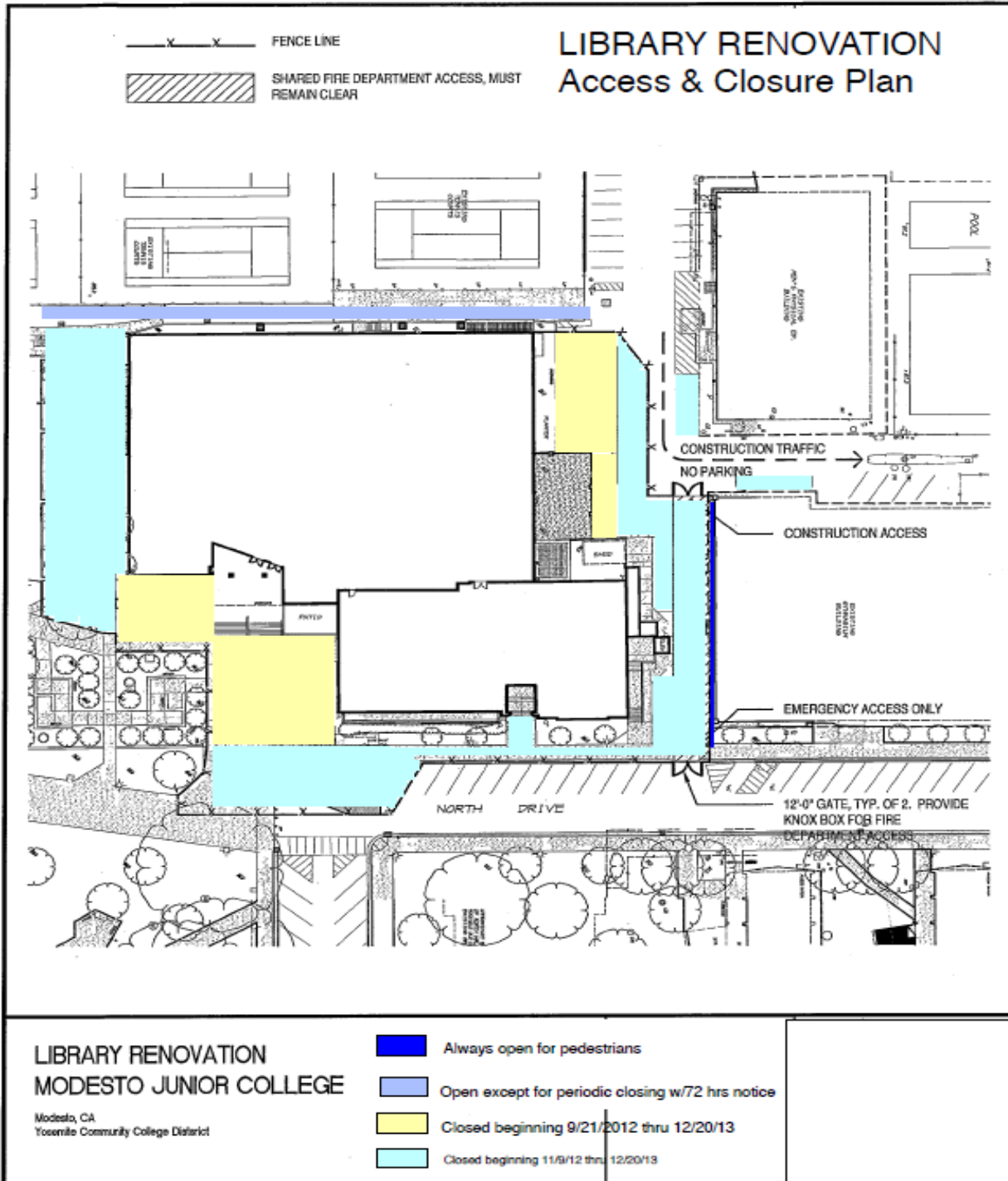



Measure E Bond Program
MODESTO JUNIOR COLLEGE CAMPUS
CONSTRUCTION UPDATE
continued (page 4 of 4)

CAREER DEVELOPMENT & TRANSFER CENTER – Access & Closure Map

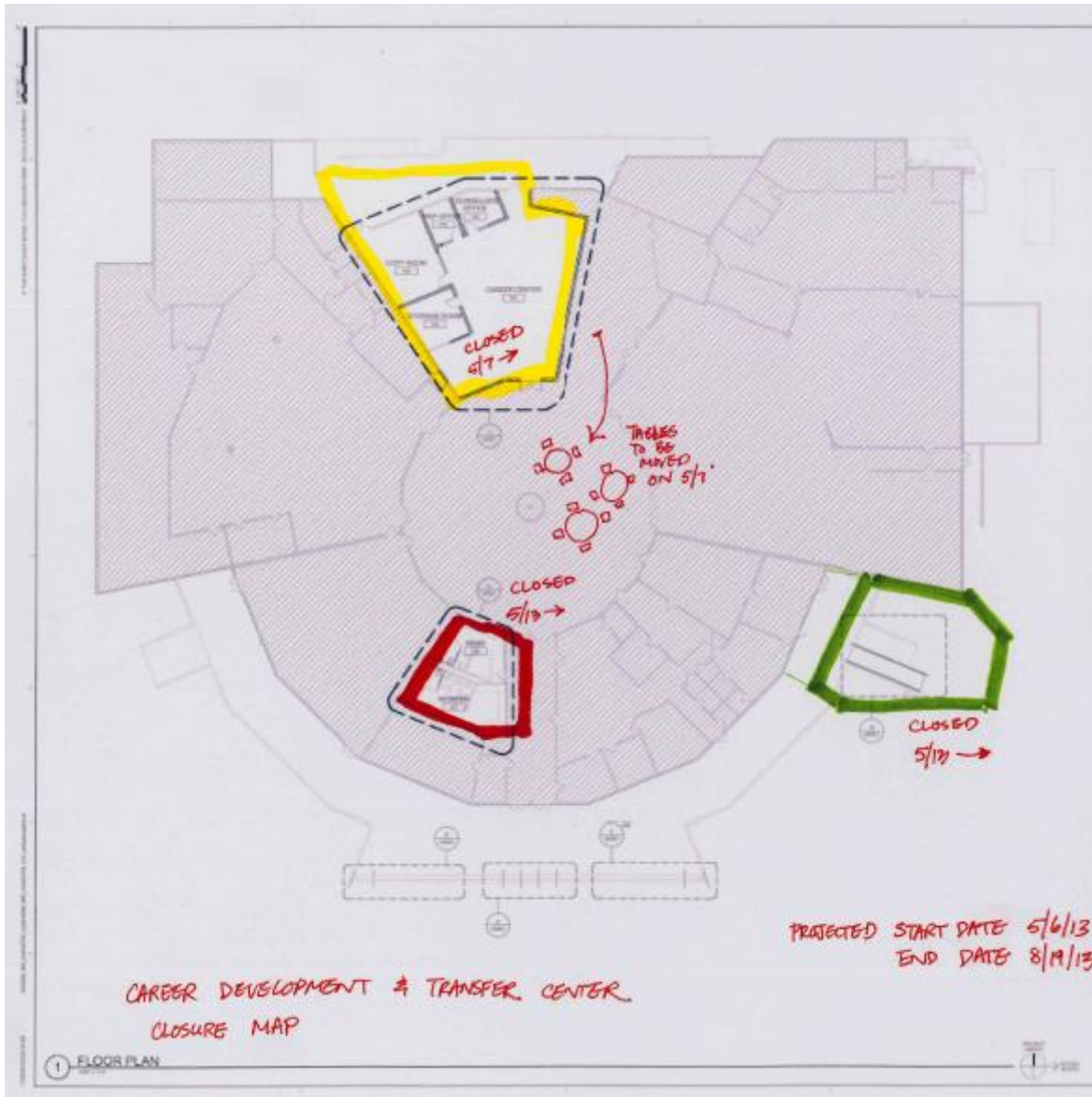

If there are any questions or concerns contact Kitchell CEM, Measure E Bond Construction Manager, located at 2201 Blue Gum Ave., Modesto CA 95358 Tel: 575-6991 Email mkennedy@kitchell.com

