



# Measure E Bond Program MODESTO JUNIOR COLLEGE CAMPUS CONSTRUCTION UPDATE



## UPDATES & ACTIVITIES THAT MAY IMPACT CAMPUS OPERATION *Week of March 4, 2013*

### SCIENCE COMMUNITY CENTER

**Work this week:** Clean up and finish work ongoing.  
Working on punchlist items.

<b>Access:</b>	No anticipated impact
<b>Noise:</b>	Moderate impact
<b>Parking:</b>	No anticipated impact
<b>Utilities:</b>	No anticipated impact
<b>Odors:</b>	No anticipated impact
<b>Dust:</b>	No anticipated impact



### INFRASTRUCTURE

**Work this week:** Continued installation of way finding signs.

<b>Access:</b>	Moderate impact
<b>Noise:</b>	No anticipated impact
<b>Parking:</b>	No anticipated impact
<b>Utilities:</b>	No anticipated impact
<b>Odors:</b>	No anticipated impact
<b>Dust:</b>	No anticipated impact



### SHIPPING & RECEIVING BLDG

**Work this week:** Site grading, metal building construction

<b>Access:</b>	None
<b>Noise:</b>	Moderate: equipment & deliveries
<b>Parking:</b>	No anticipated impact
<b>Utilities:</b>	No anticipated impact
<b>Odors:</b>	No anticipated impact
<b>Dust:</b>	No anticipated impact





# Measure E Bond Program MODESTO JUNIOR COLLEGE CAMPUS CONSTRUCTION UPDATE *continued (page 2 of 3)*

## PRIMARY DATA CENTER

**Work this week:** Rough in mechanical, electrical and plumbing. Installation of HVAC ducting and fire suppression system. Installation of low voltage wiring. Trenching and installation of underground electrical at electrical yard. Installation of lath and reveals for exterior stucco. Installation of TPO roofing at mechanical well.

<b>Access:</b>	Caution at G Street and 3 <sup>rd</sup> street.
<b>Noise:</b>	Moderate impact
<b>Parking:</b>	No anticipated impact
<b>Utilities:</b>	No anticipated impact
<b>Odors:</b>	No anticipated impact
<b>Dust:</b>	Moderate impact



## LIBRARY RENOVATION

**Work this week:** Continue installing duct work, plumbing, electrical conduits and interior framing.

<b>Access:</b>	See updated access map below
<b>Noise:</b>	Moderate: equipment & deliveries
<b>Parking:</b>	See attached map for closure.
<b>Utilities:</b>	None
<b>Odors:</b>	None
<b>Dust:</b>	None





Measure E Bond Program  
MODESTO JUNIOR COLLEGE CAMPUS  
CONSTRUCTION UPDATE  
continued (page 3 of 3)

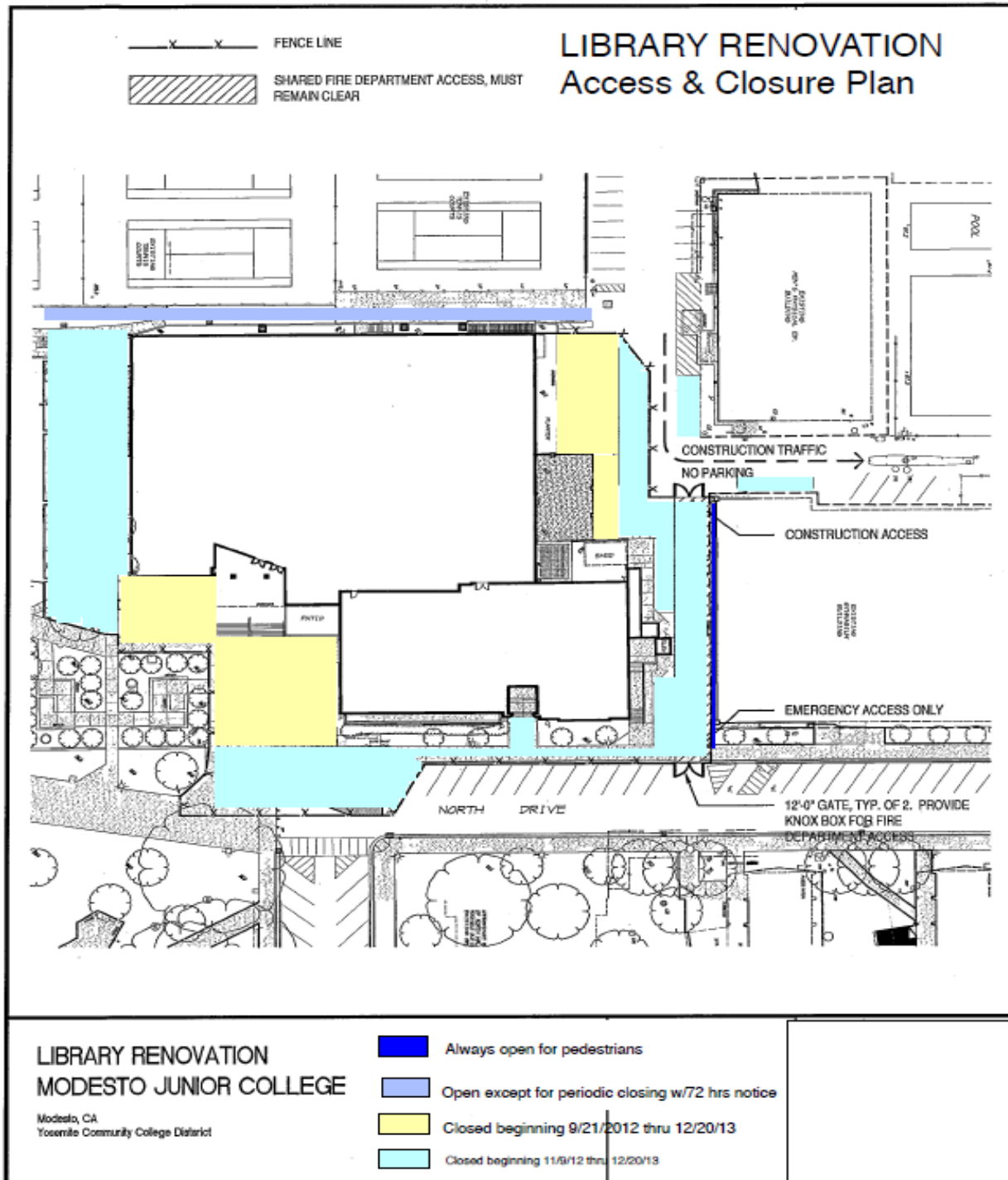

If there are any questions or concerns contact Kitchell CEM, Measure E Bond Construction Manager, located at 2201 Blue Gum Ave., Modesto CA 95358 Tel: 575-6991 Email [mkennedy@kitchell.com](mailto:mkennedy@kitchell.com)

