



# Measure E Bond Program MODESTO JUNIOR COLLEGE CAMPUS CONSTRUCTION UPDATE



## UPDATES & ACTIVITIES THAT MAY IMPACT CAMPUS OPERATION

*Week of November 12, 2012*

### SCIENCE COMMUNITY CENTER

**Work this week:** Continued installation of ceiling tiles. Installation of casework and lab cabinetry. Continued site work. Installation of flooring on 2<sup>nd</sup> and 3<sup>rd</sup> floors. Electrical, mechanical and plumbing finish work. Installation of planetarium dome. Interior and exterior painting.

<b>Access:</b>	No anticipated impact
<b>Noise:</b>	Moderate impact
<b>Parking:</b>	No anticipated impact
<b>Utilities:</b>	No anticipated impact
<b>Odors:</b>	No anticipated impact
<b>Dust:</b>	No anticipated impact



### WEST CAMPUS PARKING LOT

**Work this week:** Continue landscape and irrigation. Continued electrical installation for light poles and ticket machine. Paint and striping at parking lot.

<b>Access:</b>	Caution at 4 <sup>th</sup> and B Street, sidewalk closed at east end of Lot 202.
<b>Noise:</b>	No anticipated impact
<b>Parking:</b>	11 stalls at east end of Lot 202 impacted
<b>Utilities:</b>	No anticipated impact
<b>Odors:</b>	No anticipated impact
<b>Dust:</b>	No anticipated impact



### AG PAVILION SITE IMPROVEMENTS

**Work this week:** Continue installation of feedlot.

<b>Access:</b>	Limited access when using G Street & Student Center Dr.
<b>Noise:</b>	Moderate impact
<b>Parking:</b>	No anticipated impact
<b>Utilities:</b>	No anticipated impact
<b>Odors:</b>	No anticipated impact
<b>Dust:</b>	No anticipated impact





## Measure E Bond Program MODESTO JUNIOR COLLEGE CAMPUS CONSTRUCTION UPDATE *continued (page 2 of 3)*

### SHIPPING & RECEIVING BLDG

**Work this week:** No major activities taking place. Continued dust control.

<b>Access:</b>	Caution when using G Street & 5 <sup>th</sup> Street.
<b>Noise:</b>	Moderate impact
<b>Parking:</b>	No anticipated impact
<b>Utilities:</b>	No anticipated impact
<b>Odors:</b>	No anticipated impact
<b>Dust:</b>	No anticipated impact



### PRIMARY DATA CENTER

**Work this week:** Continued installation under slab electrical conduits at UPS rooms. Concrete slab pour to take place Monday, Nov. 12<sup>th</sup>.

<b>Access:</b>	Caution at G Street and 3 <sup>rd</sup> street.
<b>Noise:</b>	Moderate impact
<b>Parking:</b>	No anticipated impact
<b>Utilities:</b>	No anticipated impact
<b>Odors:</b>	No anticipated impact
<b>Dust:</b>	Moderate impact



### LIBRARY REMEDIATION

**Work this week:** Continue demolition and abatement on the first floor and begin flooring removal and abatement in the basement.

<b>Access:</b>	See updated access map below
<b>Noise:</b>	High: equipment noise
<b>Parking:</b>	Stalls in the alley between the Library and the Gym continue to be closed, additional stalls on North Road will be closed beginning 11/9. See attached map for closure.
<b>Utilities:</b>	Power to library except for the essential HVAC circuits remain off. Water to the Library will be turned off for a few hours.
<b>Odors:</b>	None
<b>Dust:</b>	None







Measure E Bond Program  
MODESTO JUNIOR COLLEGE CAMPUS  
CONSTRUCTION UPDATE  
*continued (page 3 of 3)*

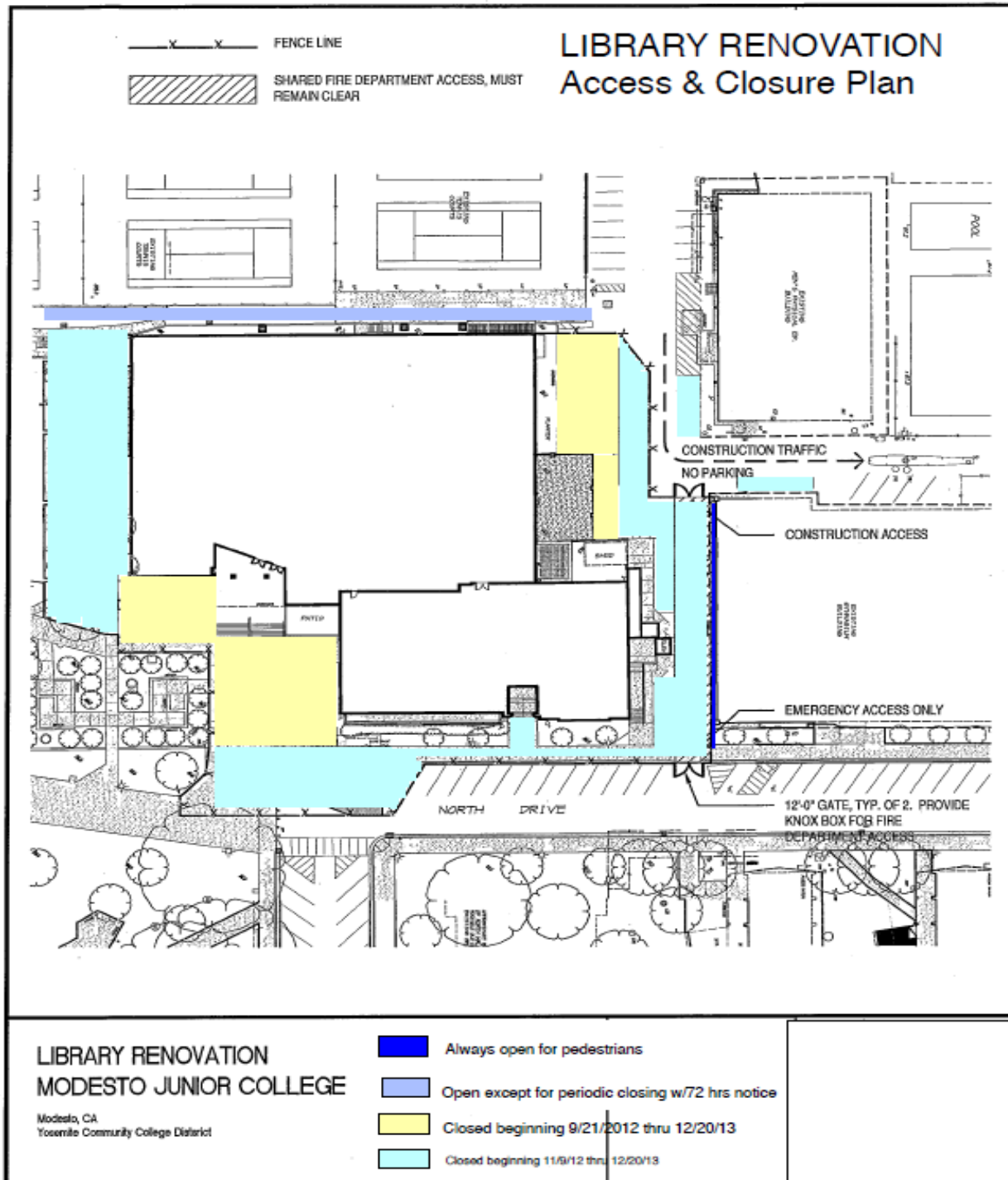

If there are any questions or concerns contact Kitchell CEM, Measure E Bond Construction Manager, located at 2201 Blue Gum Ave., Modesto CA 95358 Tel: 575-6991 Email [mkennedy@kitchell.com](mailto:mkennedy@kitchell.com)

