



Measure E Bond Program MODESTO JUNIOR COLLEGE CAMPUS CONSTRUCTION UPDATE



UPDATES & ACTIVITIES THAT MAY IMPACT CAMPUS OPERATION

Week of September 23, 2013

LIBRARY RENOVATION

Work this week: Continue interior finishes and electrical installation. Continue exterior site work. Continue installation of low voltage systems. Installing furniture.

Access:	See access map below
Noise:	Moderate: equipment & deliveries
Parking:	See attached map for closure.
Utilities:	None
Odors:	None
Dust:	None

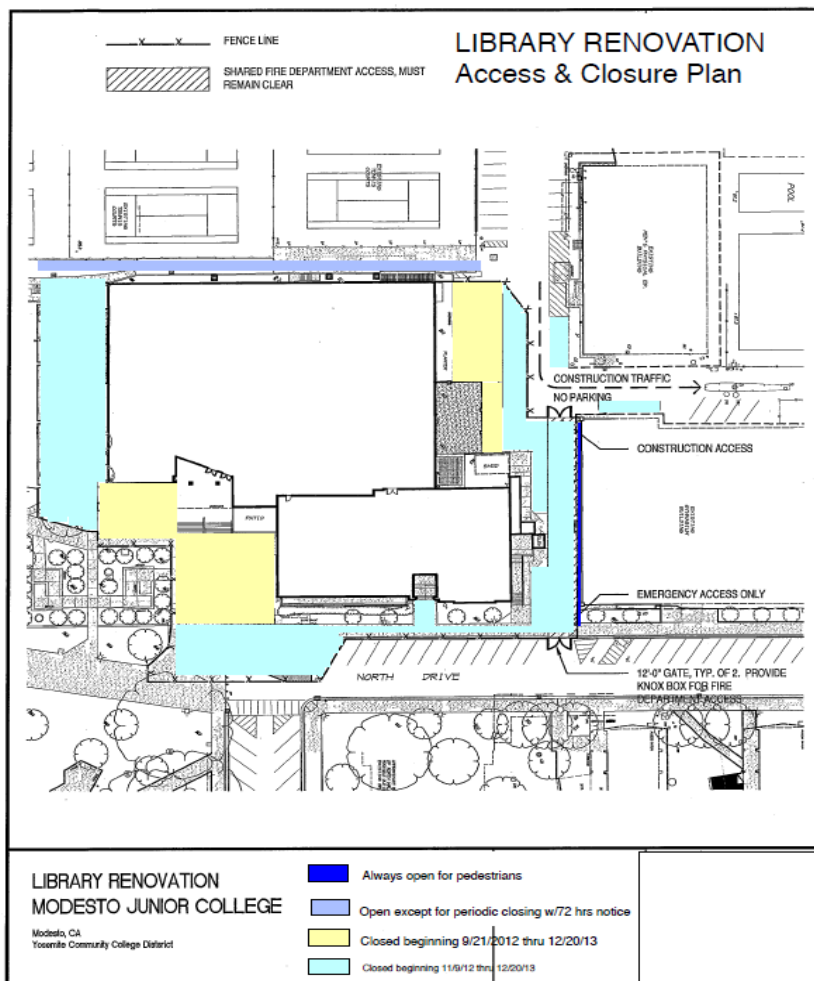



Measure E Bond Program MODESTO JUNIOR COLLEGE CAMPUS CONSTRUCTION UPDATE

HIGH TECH (NORTH HALL) MODERNIZATION

Work this week: Hard demo and soft demo.

Access: See access map below
Noise: Moderate: equipment & deliveries
Parking: See attached map for closure.
Utilities: None
Odors: None
Dust: None

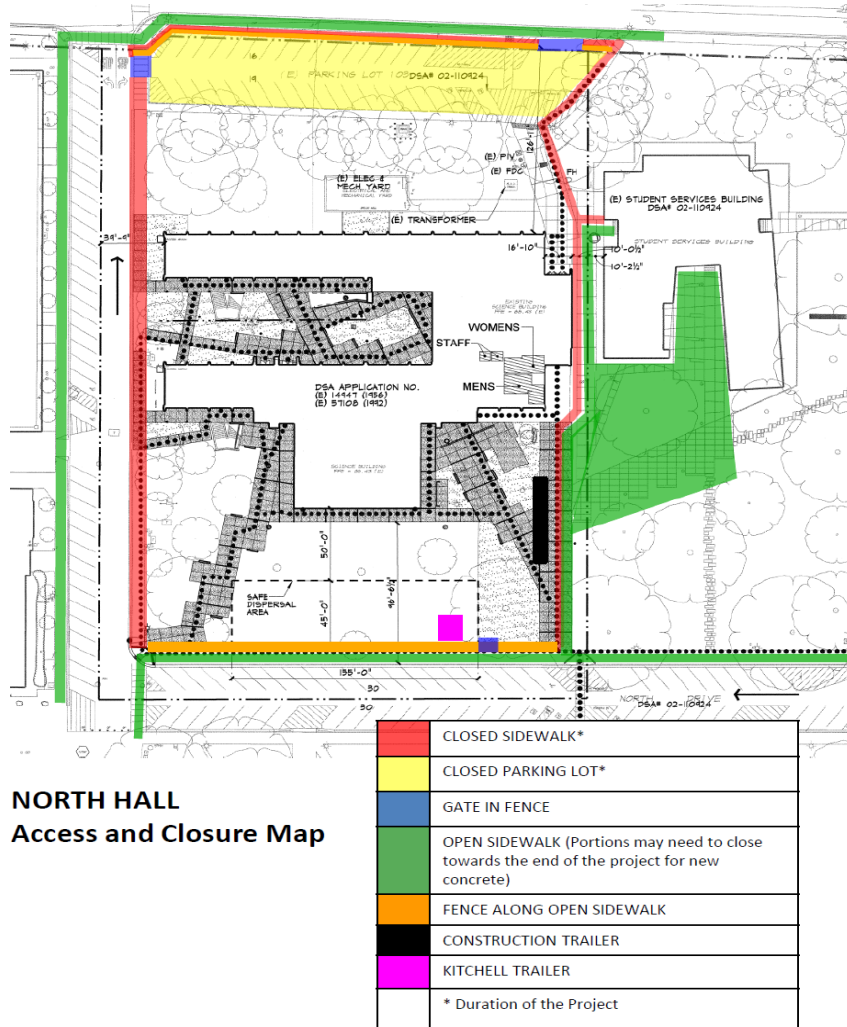

If there are any questions or concerns contact Kitchell CEM, Measure E Bond Construction Manager, located at 2201 Blue Gum Ave., Modesto CA 95358 Tel: 575-6991 Email mkennedy@kitchell.com

