



Measure E Bond Program MODESTO JUNIOR COLLEGE CAMPUS CONSTRUCTION UPDATE



UPDATES & ACTIVITIES THAT MAY IMPACT CAMPUS OPERATION

Week of February 25, 2013

SCIENCE COMMUNITY CENTER

Work this week: Clean up and finish work ongoing. Continued installation of casework and lab cabinetry finish work. Continued MEP finish work. Landscaping ongoing.

Access:	No anticipated impact
Noise:	Moderate impact
Parking:	No anticipated impact
Utilities:	No anticipated impact
Odors:	No anticipated impact
Dust:	No anticipated impact



INFRASTRUCTURE

Work this week: Continued installation of way finding signs.

Access:	Moderate impact
Noise:	No anticipated impact
Parking:	No anticipated impact
Utilities:	No anticipated impact
Odors:	No anticipated impact
Dust:	No anticipated impact

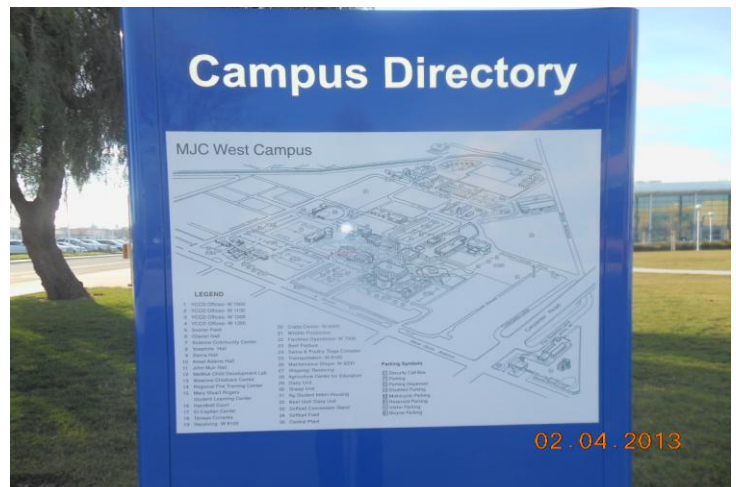

SHIPPING & RECEIVING BLDG

Work this week: Site grading, metal building construction

Access:	None
Noise:	Moderate: equipment & deliveries
Parking:	No anticipated impact
Utilities:	No anticipated impact
Odors:	No anticipated impact
Dust:	No anticipated impact





Measure E Bond Program MODESTO JUNIOR COLLEGE CAMPUS CONSTRUCTION UPDATE *continued (page 2 of 3)*

PRIMARY DATA CENTER

Work this week: Rough in mechanical, electrical and plumbing. Installation of HVAC ducting and fire suppression system. Installation of low voltage wiring. Trenching and installation of underground electrical at electrical yard. Installation of lath and reveals for exterior stucco. Installation of TPO roofing at mechanical well.

Access:	Caution at G Street and 3 rd street.
Noise:	Moderate impact
Parking:	No anticipated impact
Utilities:	No anticipated impact
Odors:	No anticipated impact
Dust:	Moderate impact



LIBRARY RENOVATION

Work this week: Continue installing duct work, plumbing, electrical conduits and interior framing.

Access:	See updated access map below
Noise:	Moderate: equipment & deliveries
Parking:	See attached map for closure.
Utilities:	None
Odors:	None
Dust:	None





Measure E Bond Program
MODESTO JUNIOR COLLEGE CAMPUS
CONSTRUCTION UPDATE
continued (page 3 of 3)

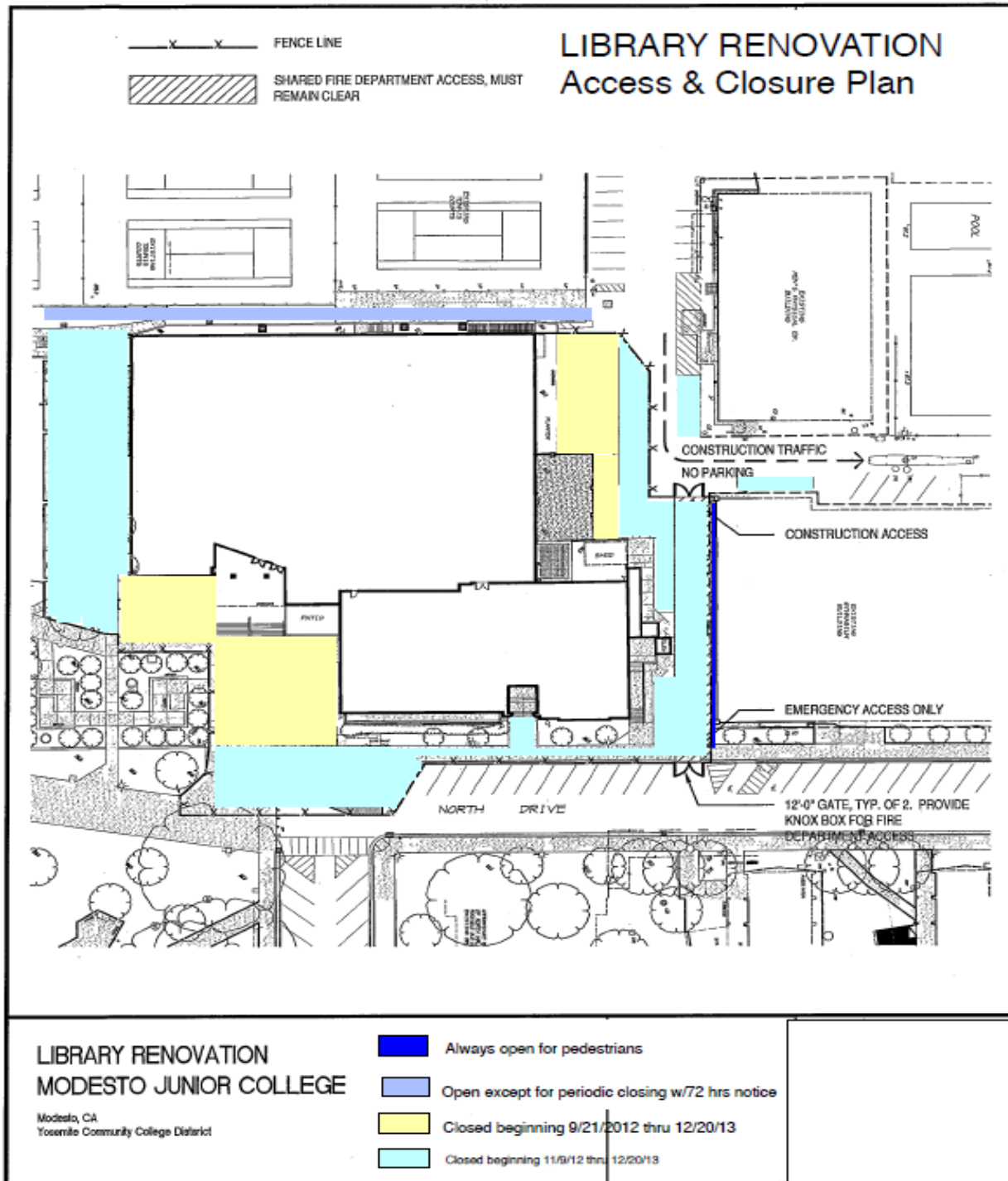

If there are any questions or concerns contact Kitchell CEM, Measure E Bond Construction Manager, located at 2201 Blue Gum Ave., Modesto CA 95358 Tel: 575-6991 Email mkennedy@kitchell.com

