



Measure E Bond Program MODESTO JUNIOR COLLEGE CAMPUS CONSTRUCTION UPDATE



UPDATES & ACTIVITIES THAT MAY IMPACT CAMPUS OPERATION

Week of January 28, 2013

SCIENCE COMMUNITY CENTER

Work this week: Continued installation of casework and lab cabinetry. Continued site work. Installation of flooring on 2nd and 3rd floors. Electrical, mechanical and plumbing finish work. Installation of interior finishes.

Access:	No anticipated impact
Noise:	Moderate impact
Parking:	No anticipated impact
Utilities:	No anticipated impact
Odors:	No anticipated impact
Dust:	No anticipated impact



INFRASTRUCTURE

Work this week: Removing abandoned utility poles and installing way finding signs.

Access:	Moderate impact
Noise:	No anticipated impact
Parking:	No anticipated impact
Utilities:	No anticipated impact
Odors:	No anticipated impact
Dust:	No anticipated impact



AG PAVILION SITE IMPROVEMENTS

Work this week: Installation of gravel at feedlot and punchlist work.

Access:	Limited access when using G Street & Student Center Dr.
Noise:	Moderate impact
Parking:	No anticipated impact
Utilities:	No anticipated impact
Odors:	No anticipated impact
Dust:	No anticipated impact





Measure E Bond Program MODESTO JUNIOR COLLEGE CAMPUS CONSTRUCTION UPDATE *continued (page 2 of 3)*

SHIPPING & RECEIVING BLDG

Work this week: Continue steel erection and roof installation.

Access: G Street blocked off to traffic due to crane use, Thursday 01/31 from 6am-4pm.

Noise: Moderate impact

Parking: No anticipated impact

Utilities: No anticipated impact

Odors: No anticipated impact

Dust: No anticipated impact



PRIMARY DATA CENTER

Work this week: Installation of interior and roof framing. Rough in electrical and plumbing. Installation of HVAC ducting, drywall, and fire suppression system.

Access: Caution at G Street and 3rd street.

Noise: Moderate impact

Parking: No anticipated impact

Utilities: No anticipated impact

Odors: No anticipated impact

Dust: Moderate impact



LIBRARY RENOVATION

Work this week: Continue installing duct work, plumbing, electrical conduits and interior framing.

Access: See updated access map below

Noise: Moderate: equipment & deliveries

Parking: See attached map for closure.

Utilities: None

Odors: None

Dust: None





Measure E Bond Program
MODESTO JUNIOR COLLEGE CAMPUS
CONSTRUCTION UPDATE
continued (page 3 of 3)

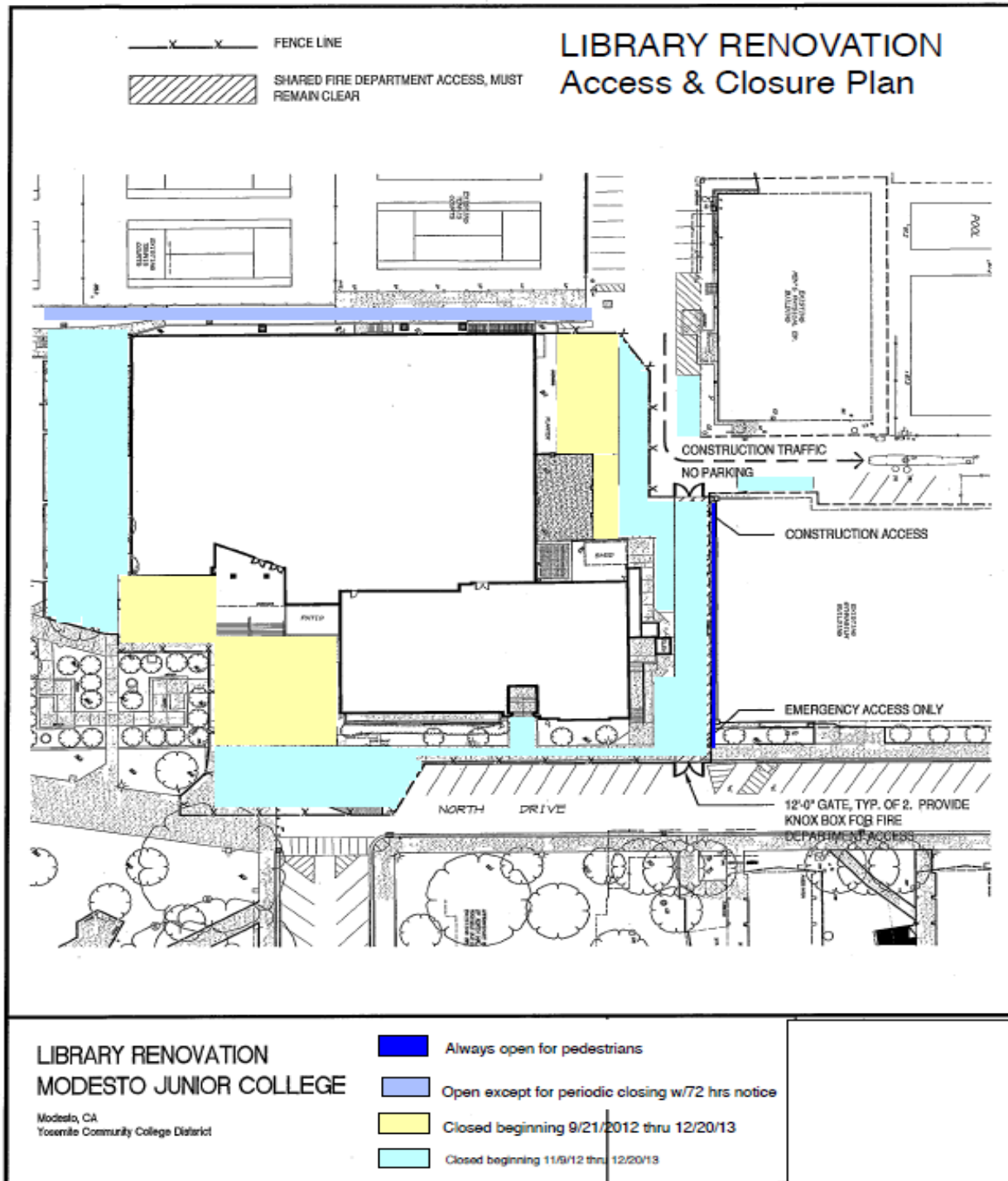

If there are any questions or concerns contact Kitchell CEM, Measure E Bond Construction Manager, located at 2201 Blue Gum Ave., Modesto CA 95358 Tel: 575-6991 Email mkennedy@kitchell.com

