



# Measure E Bond Program MODESTO JUNIOR COLLEGE CAMPUS CONSTRUCTION UPDATE



## UPDATES & ACTIVITIES THAT MAY IMPACT CAMPUS OPERATION *Week of April 22, 2013*

### SCIENCE COMMUNITY CENTER

**Work this week:** Clean up and finish work ongoing.  
Working on punchlist items.

<b>Access:</b>	No anticipated impact
<b>Noise:</b>	Moderate impact
<b>Parking:</b>	No anticipated impact
<b>Utilities:</b>	No anticipated impact
<b>Odors:</b>	No anticipated impact
<b>Dust:</b>	No anticipated impact



### INFRASTRUCTURE

**Work this week:** Continued installation of way finding signs.

<b>Access:</b>	Moderate impact
<b>Noise:</b>	No anticipated impact
<b>Parking:</b>	No anticipated impact
<b>Utilities:</b>	No anticipated impact
<b>Odors:</b>	No anticipated impact
<b>Dust:</b>	No anticipated impact



### SHIPPING & RECEIVING BLDG

**Work this week:** Metal building construction, installation of metal wall and roof panels. Metal stud framing, interior rough in mechanical, electrical and plumbing.

<b>Access:</b>	None
<b>Noise:</b>	Moderate: equipment & deliveries
<b>Parking:</b>	No anticipated impact
<b>Utilities:</b>	No anticipated impact
<b>Odors:</b>	No anticipated impact
<b>Dust:</b>	No anticipated impact





# Measure E Bond Program MODESTO JUNIOR COLLEGE CAMPUS CONSTRUCTION UPDATE *continued (page 2 of 3)*

## PRIMARY DATA CENTER

**Work this week:** Continued installation for metal roof system. Start installing gutters and downspouts. Prime and paint interior walls. Continue setting equipment in electrical yard and install AC units on roof. Pouring concrete sidewalks. Grading parking lot.

**Access:** Caution at G Street and 3<sup>rd</sup> street.  
**Noise:** Moderate impact  
**Parking:** No anticipated impact  
**Utilities:** No anticipated impact  
**Odors:** No anticipated impact  
**Dust:** Moderate impact



## LIBRARY RENOVATION

**Work this week:** Continue mechanical, electrical, and plumbing rough in. Continue interior framing and gypsum board installation. Continue pulling wire through conduits.

**Access:** See updated access map below  
**Noise:** Moderate: equipment & deliveries  
**Parking:** See attached map for closure.  
**Utilities:** None  
**Odors:** None  
**Dust:** None





**Measure E Bond Program**  
**MODESTO JUNIOR COLLEGE CAMPUS**  
**CONSTRUCTION UPDATE**  
*continued (page 3 of 3)*

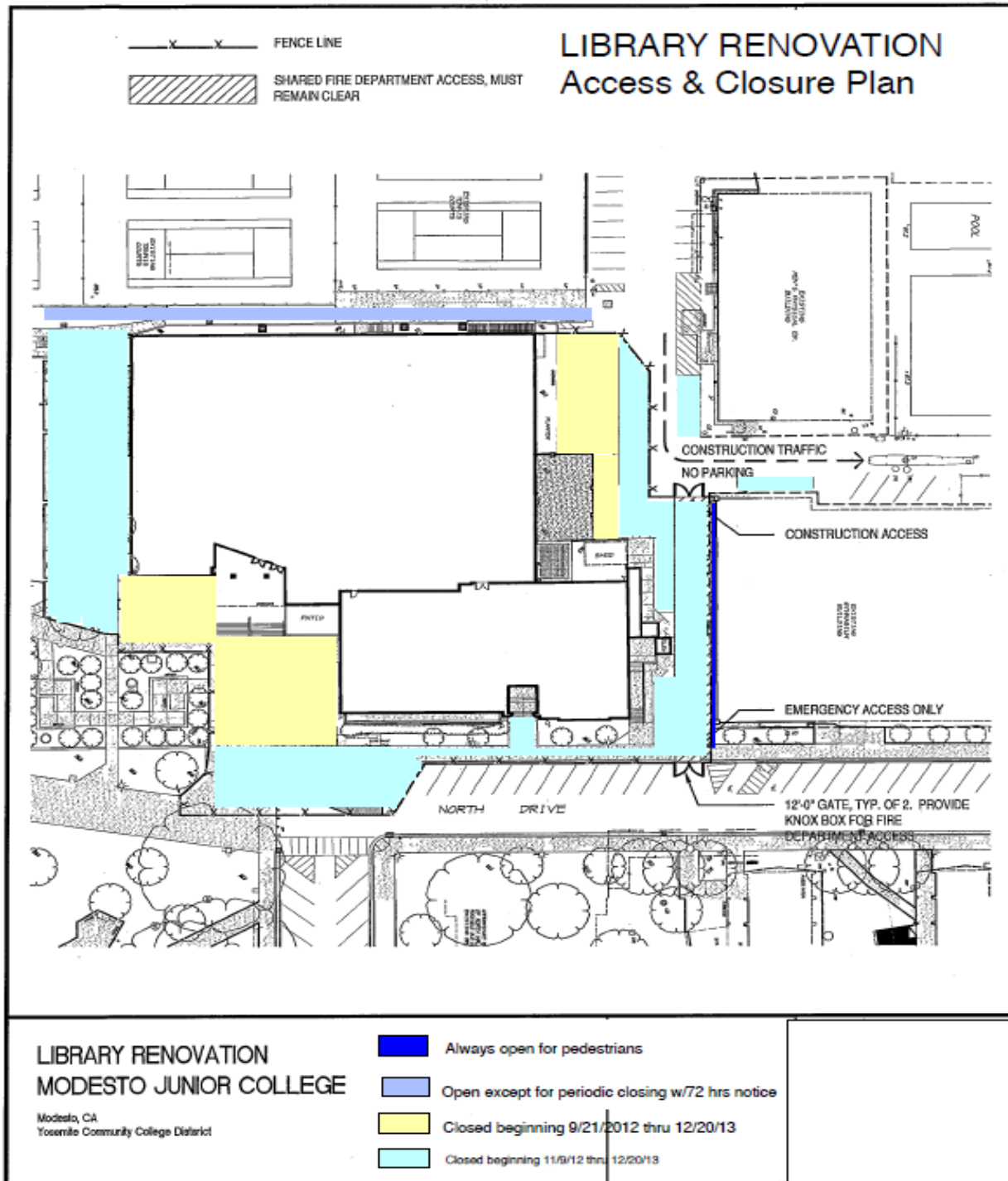

If there are any questions or concerns contact Kitchell CEM, Measure E Bond Construction Manager, located at 2201 Blue Gum Ave., Modesto CA 95358 Tel: 575-6991 Email [mkennedy@kitchell.com](mailto:mkennedy@kitchell.com)

