



# Measure E Bond Program MODESTO JUNIOR COLLEGE CAMPUS CONSTRUCTION UPDATE



## UPDATES & ACTIVITIES THAT MAY IMPACT CAMPUS OPERATION

*Week of October 14, 2013*

### LIBRARY RENOVATION

**Work this week:** Installing furniture. Working on punchlist items.

<b>Access:</b>	See access map below
<b>Noise:</b>	Moderate: equipment & deliveries
<b>Parking:</b>	See attached map for closure.
<b>Utilities:</b>	None
<b>Odors:</b>	None
<b>Dust:</b>	None

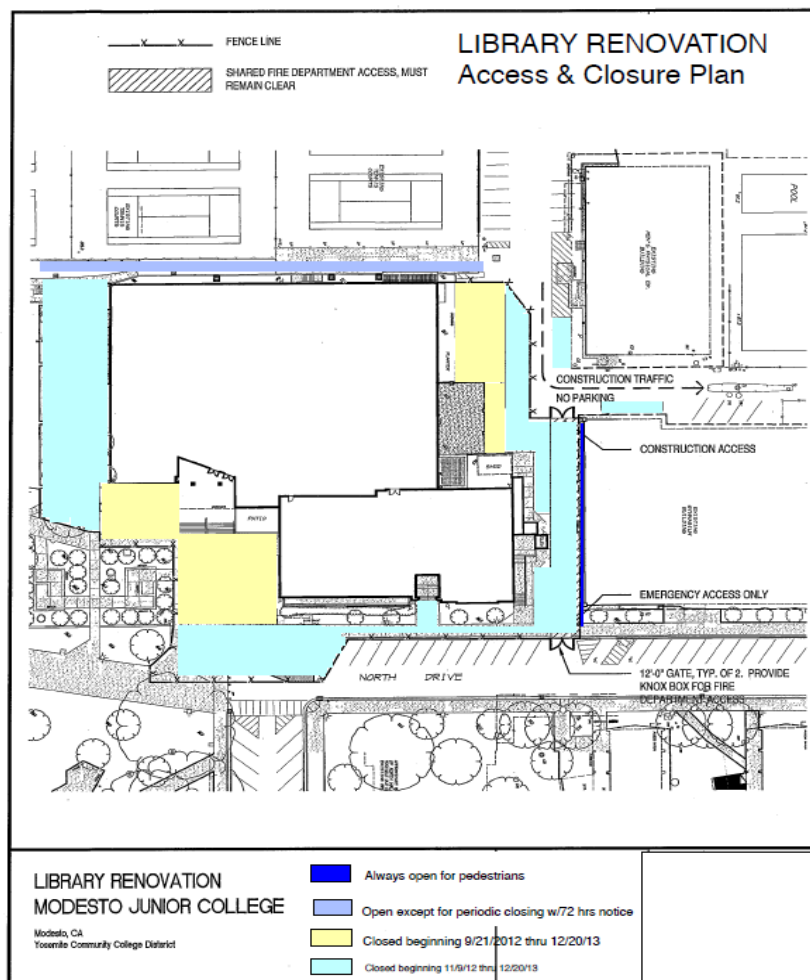



# Measure E Bond Program MODESTO JUNIOR COLLEGE CAMPUS CONSTRUCTION UPDATE

## HIGH TECH (NORTH HALL) MODERNIZATION

**Work this week:** Hard demo and soft demo.

<b>Access:</b>	See access map below
<b>Noise:</b>	Moderate: equipment & deliveries
<b>Parking:</b>	See attached map for closure.
<b>Utilities:</b>	None
<b>Odors:</b>	None
<b>Dust:</b>	None

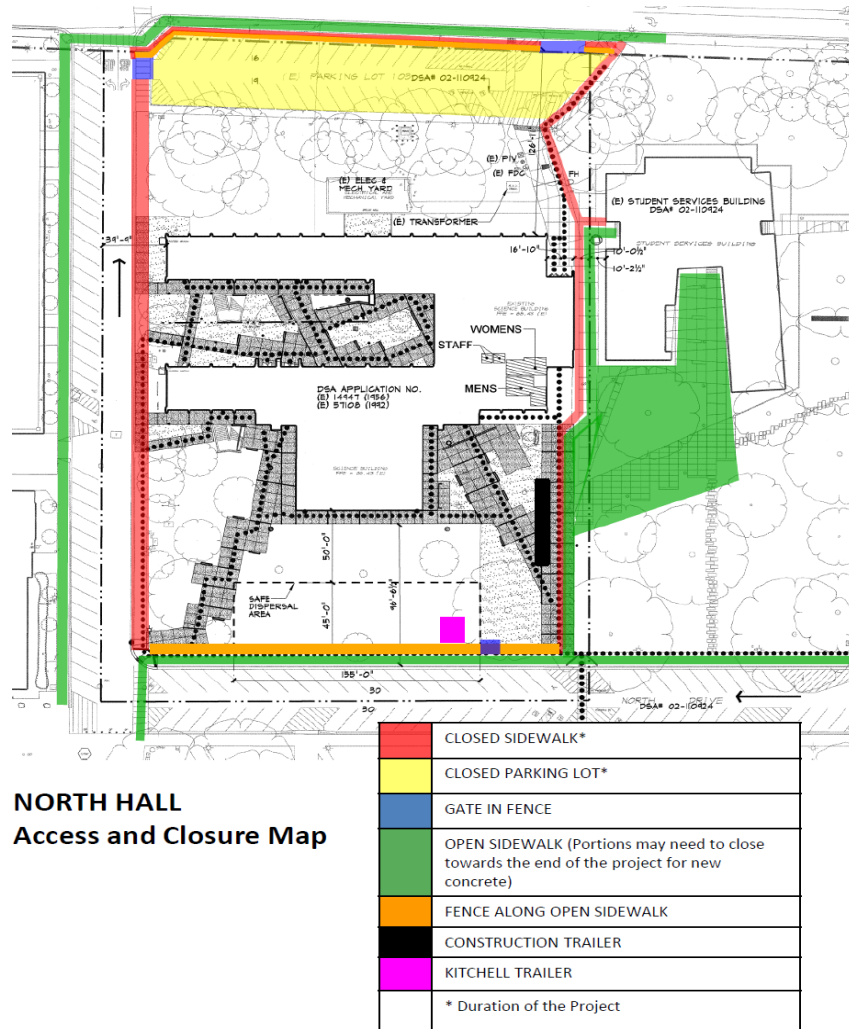

If there are any questions or concerns contact Kitchell CEM, Measure E Bond Construction Manager, located at 2201 Blue Gum Ave., Modesto CA 95358 Tel: 575-6991 Email [mkenedy@kitchell.com](mailto:mkenedy@kitchell.com)

