



# Measure E Bond Program MODESTO JUNIOR COLLEGE CAMPUS CONSTRUCTION UPDATE



## UPDATES & ACTIVITIES THAT MAY IMPACT CAMPUS OPERATION *Week of July 27, 2015*

### DISTRICT OFFICE BUILDING

**Work this week:** Vapor barrier and slab rebar. Pour slab on South side of building.

<b>Access:</b>	None.
<b>Noise:</b>	Moderate due to construction equipment.
<b>Parking:</b>	Some parking loss for duration of project.
<b>Utilities:</b>	None.
<b>Odors:</b>	None
<b>Dust:</b>	Minor impact.

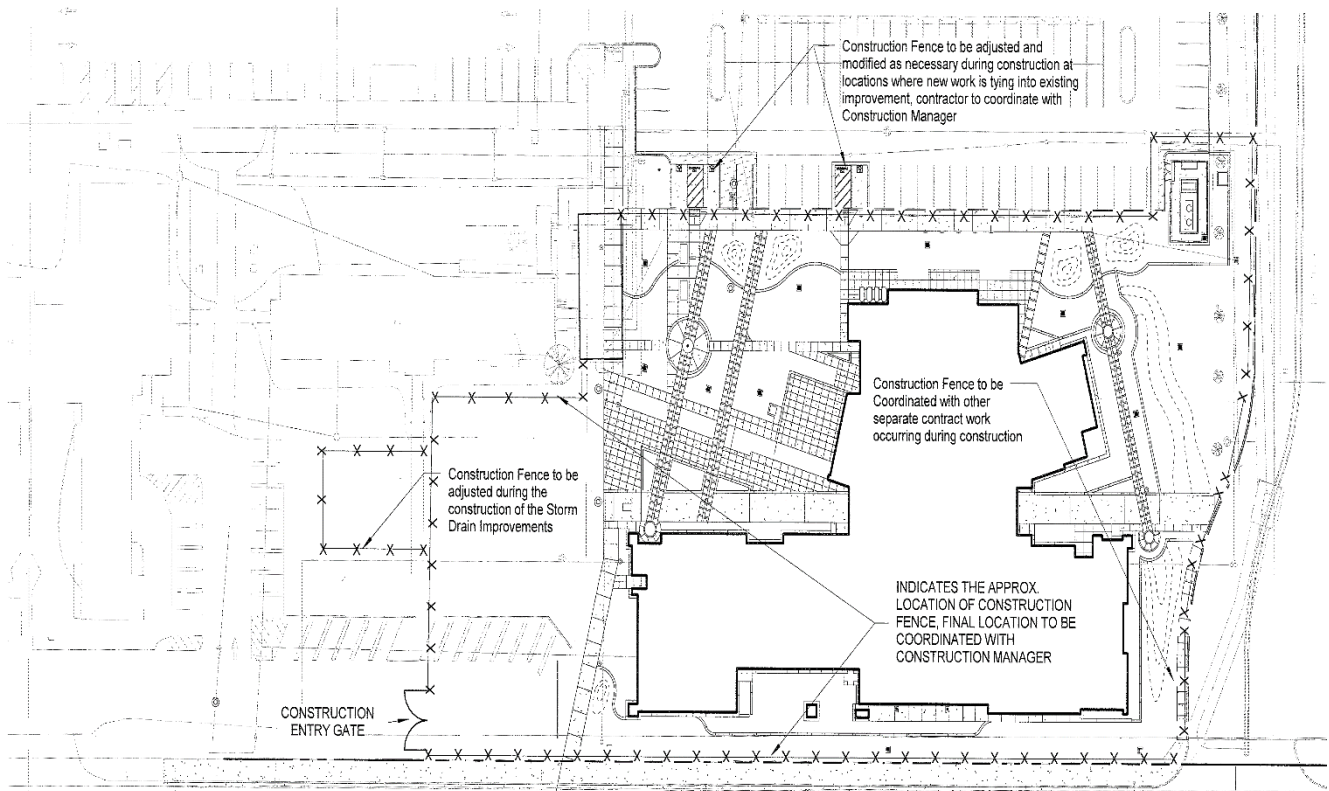

X-X-X

Construction fencing, Restricted access



# Measure E Bond Program MODESTO JUNIOR COLLEGE CAMPUS CONSTRUCTION UPDATE Page 2 of 4

## EAST CAMPUS ROADS - SOUTH DRIVE

**Work this week:** Pave road.

<b>Access:</b>	No access to South Drive for duration of project.
<b>Noise:</b>	Moderate due to construction equipment.
<b>Parking:</b>	No parking along South Drive for duration of project.
<b>Utilities:</b>	None.
<b>Odors:</b>	None.
<b>Dust:</b>	Minor from construction traffic.



## MJC East Campus

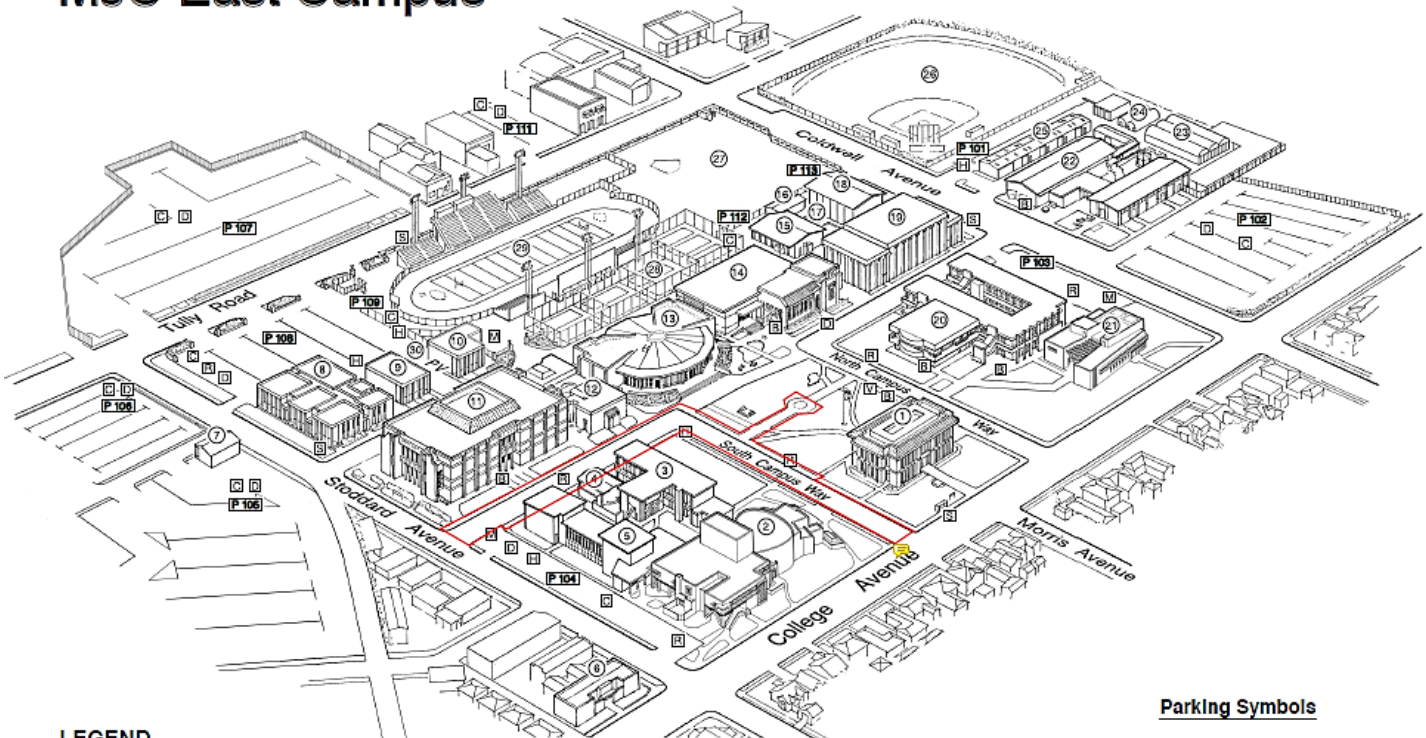

### LEGEND

1 Administration (Morris Memorial)	7 Facilities Operations	15 Physical Education- Men	23 Greenhouse
2 Performing and Media Arts Center	8 Electronics/ Computer Science	16 Physical Education Offices	24 Propagation House
3 Art	9 Journalism	17 Swimming Pool	25 Ag Storage
4 Art Gallery	10 Classroom Annex	18 Physical Education- Women	26 Athletic Field #2
5 Music	11 Founders' Hall	19 Gymnasium	27 Athletic Field #1
6 Great Valley Museum	12 Forum	20 Science	28 Tennis Courts
	13 Student Center	21 Student Services	29 Stadium
	14 Learning Resource Center/ Library	22 Agriculture	30 Pirates' Village

### Parking Symbols

☒	Security Call Box
P	Parking 101-113
Ⓟ	Parking Dispenser
♿	Disabled Parking
🏍	Motorcycle Parking
🅇	Reserved Parking
👤	Visitor Parking
🚲	Bicycle Parking
🚌	Prime Shine - Pirate Express Shuttle





# Measure E Bond Program MODESTO JUNIOR COLLEGE CAMPUS CONSTRUCTION UPDATE Page 3 of 4

## GVM EDUCATION DEMONSTRATION CENTER

**Work this week:** Contractor working on punchlist items.

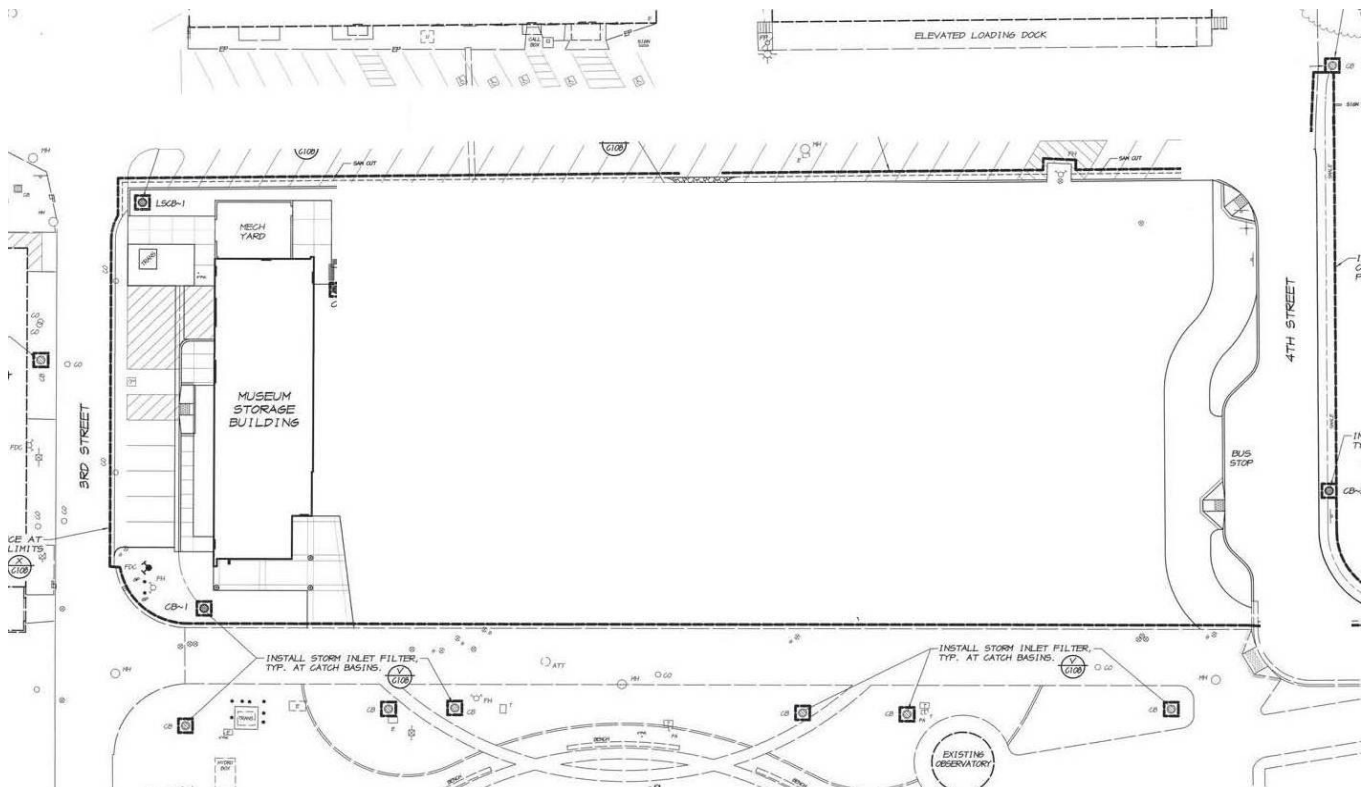
**Access:** None  
**Noise:** Minimal.  
**Parking:** None  
**Utilities:** None  
**Odors:** None  
**Dust:** None



	Construction fencing, Restricted access
	4 <sup>th</sup> Street closed for the duration of the project



# Measure E Bond Program MODESTO JUNIOR COLLEGE CAMPUS CONSTRUCTION UPDATE

Page 4 of 4

## BLUE GUM AVE & PRICHARD AVE SIGNALIZATION

**Work this week:** Signal is scheduled to be energized and operational on Tuesday July 28, 2015.

<b>Access:</b>	Caution at Blue Gum Ave. and 4 <sup>th</sup> Street Intersection.
<b>Noise:</b>	Low.
<b>Parking:</b>	Construction laydown area to be removed and reopen to public.
<b>Utilities:</b>	None
<b>Odors:</b>	None
<b>Dust:</b>	None

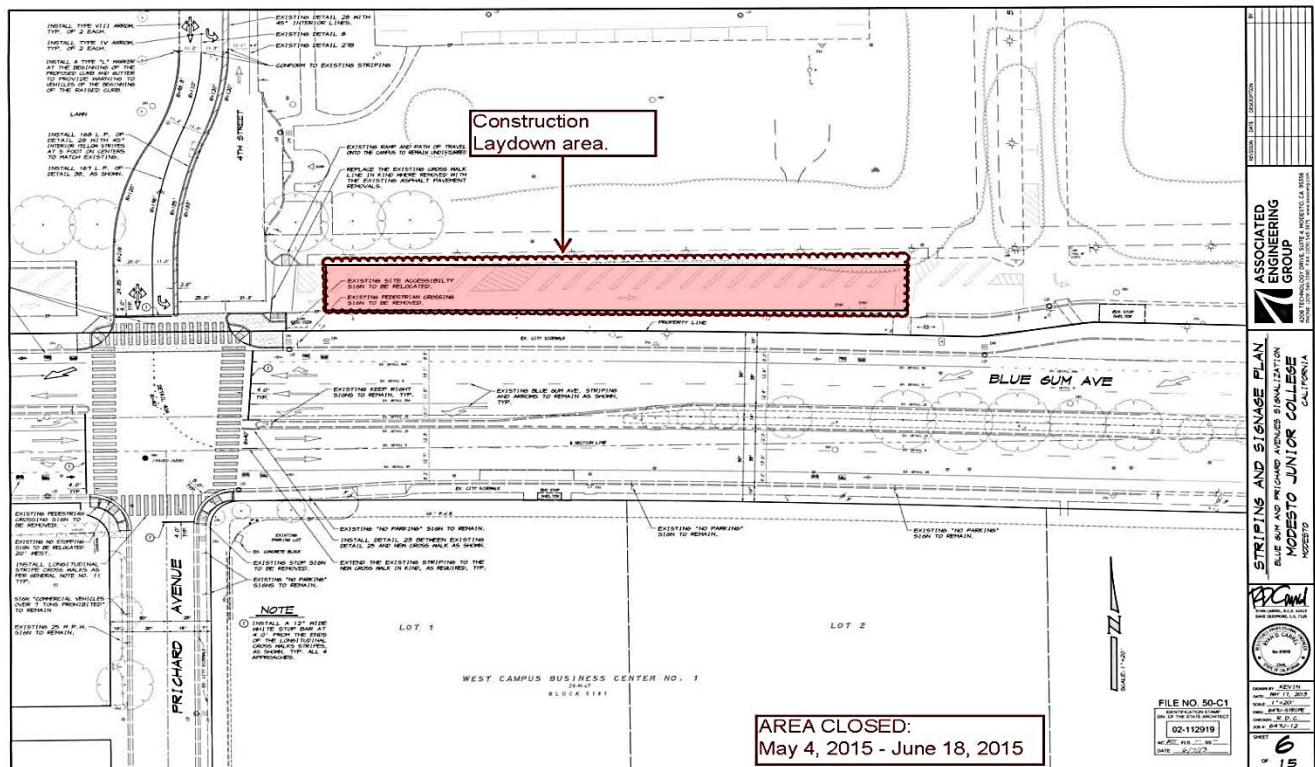

	Construction fencing, Restricted access
	Street closed for the duration of the project

If there are any questions or concerns contact Kitchell CEM, Measure E Bond Construction Manager, located at 2201 Blue Gum Ave., Modesto CA 95358 Tel: 575-6991 Email [mkenney@kitchell.com](mailto:mkenney@kitchell.com)

