



Measure E Bond Program MODESTO JUNIOR COLLEGE CAMPUS CONSTRUCTION UPDATE



UPDATES & ACTIVITIES THAT MAY IMPACT CAMPUS OPERATION *Week of June 15, 2015*

DISTRICT OFFICE BUILDING

Work this week: Continue footing excavation.

Access:	None.
Noise:	Minor equipment noise.
Parking:	Some parking loss for duration of project.
Utilities:	None.
Odors:	None
Dust:	Minor impact.

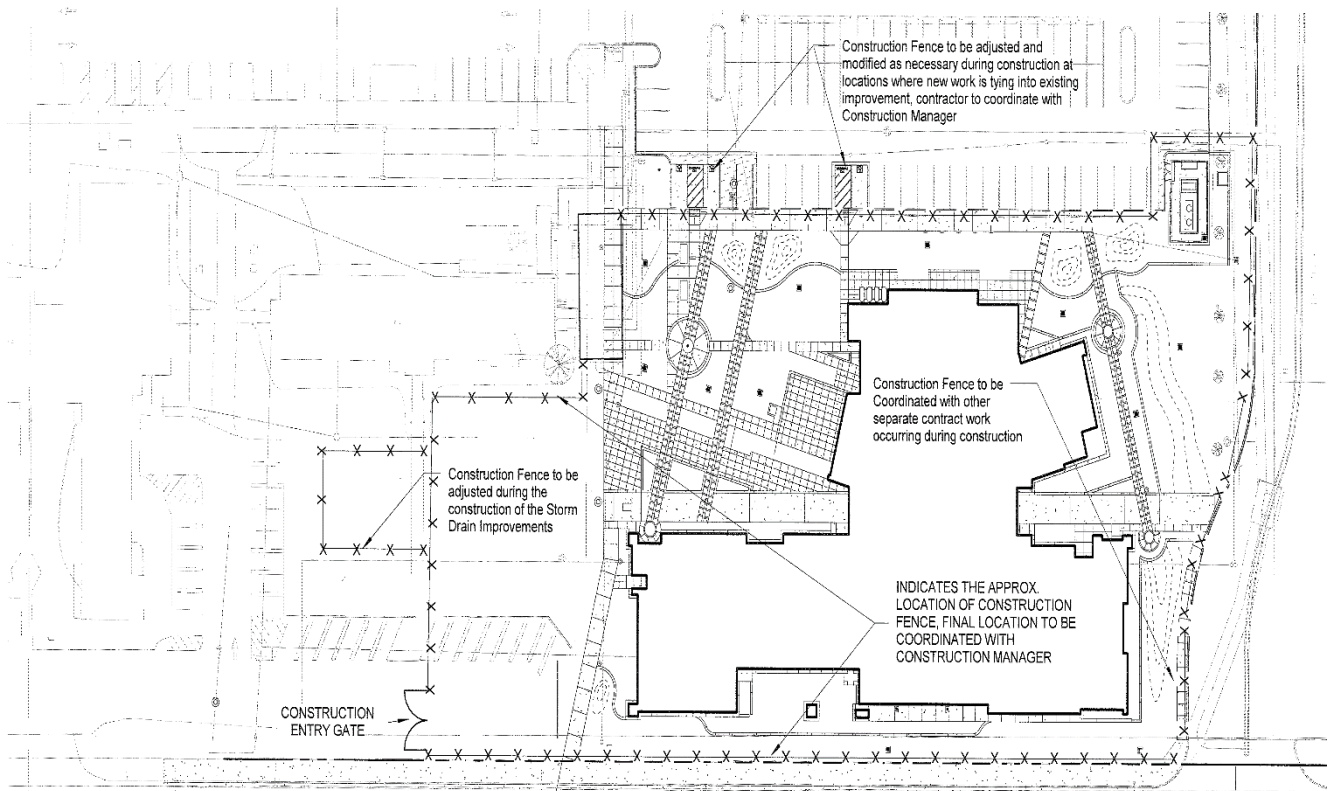

X-X-X

Construction fencing, Restricted access



Measure E Bond Program MODESTO JUNIOR COLLEGE CAMPUS CONSTRUCTION UPDATE

Page 2 of 5

EAST CAMPUS ROADS – NORTH DRIVE

Work this week: Striping roadway.

Access: No access to North Drive until noon on Tuesday, June 16, 2015.

Noise: Moderate/ Equipment.

Parking: No parking along North Drive until noon on Tuesday, June 16, 2015.

Utilities: None.

Odors: None.

Dust: None.



MJC East Campus

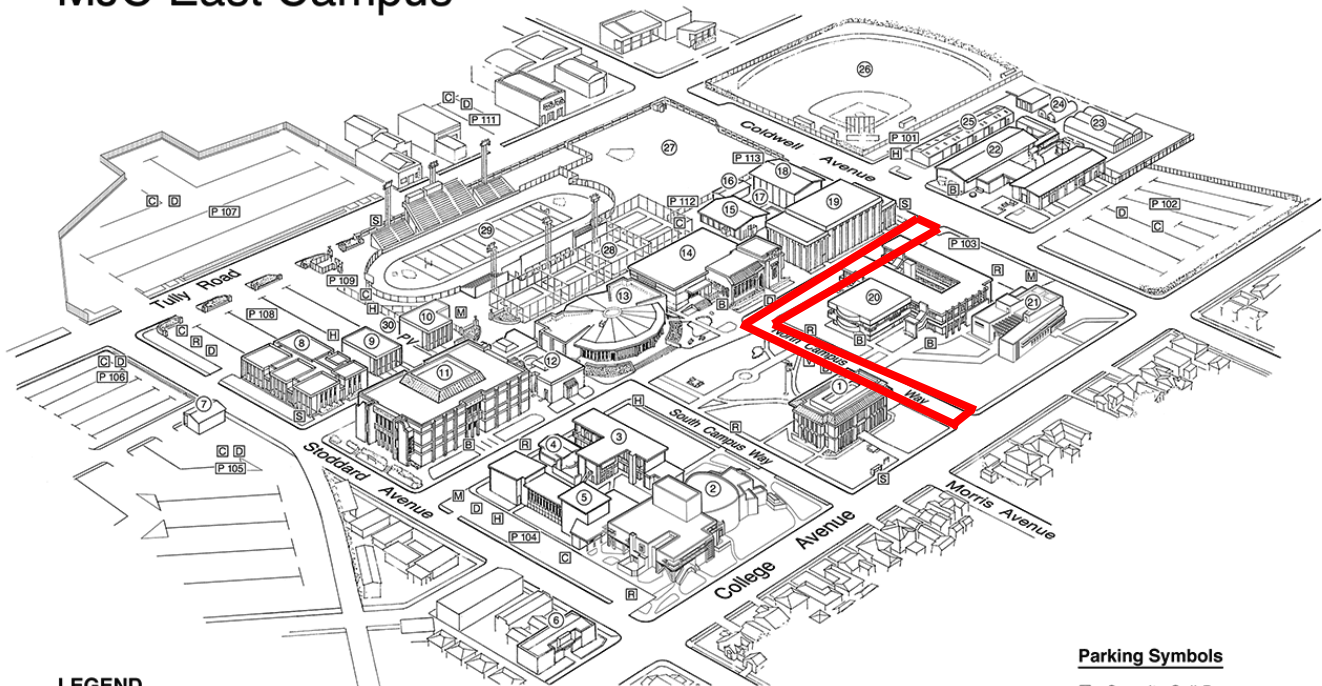

LEGEND

- | | | | |
|------------------------------------|--------------------------------------|-------------------------------|----------------------|
| 1 Administration (Morris Memorial) | 7 Facilities Operations | 15 Physical Education- Men | 23 Greenhouse |
| 2 Performing and Media Arts Center | 8 Electronics/ Computer Science | 16 Physical Education Offices | 24 Propagation House |
| 3 Art | 9 Journalism | 17 Swimming Pool | 25 Ag Storage |
| 4 Art Gallery | 10 Classroom Annex | 18 Physical Education- Women | 26 Athletic Field #2 |
| 5 Music | 11 Founders' Hall | 19 Gymnasium | 27 Athletic Field #1 |
| 6 Great Valley Museum | 12 Forum | 20 Science | 28 Tennis Courts |
| | 13 Student Center | 21 Student Services | 29 Stadium |
| | 14 Learning Resource Center/ Library | 22 Agriculture | 30 Pirates' Village |

Parking Symbols

- ☐ Security Call Box
- ☐ Parking 101-113
- ☐ Parking Dispenser
- ☐ Disabled Parking
- ☐ Motorcycle Parking
- ☐ Reserved Parking
- ☐ Visitor Parking
- ☐ Bicycle Parking
- ☐ Prime Shine - Pirate Express Shuttle



Measure E Bond Program MODESTO JUNIOR COLLEGE CAMPUS CONSTRUCTION UPDATE Page 3 of 5

EAST CAMPUS ROADS - SOUTH DRIVE

Work this week: Mobilize and demolish old road.

Access:	No access to South Drive starting Wednesday, June 17, 2015.
Noise:	Moderate/ Equipment.
Parking:	No parking along South Drive starting Wednesday, June 17, 2015.
Utilities:	None.
Odors:	None.
Dust:	None.

MJC East Campus

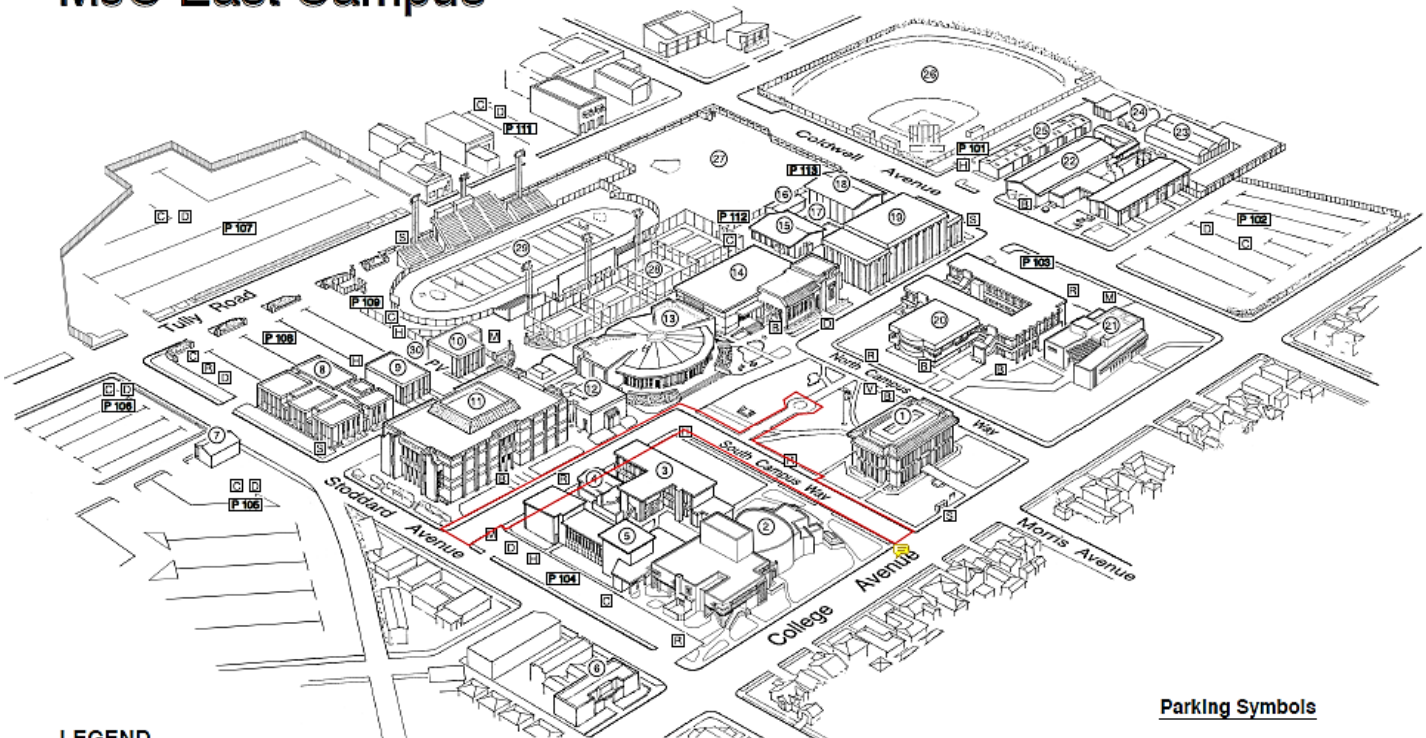

LEGEND

1 Administration (Morris Memorial)	7 Facilities Operations	15 Physical Education- Men	23 Greenhouse
2 Performing and Media Arts Center	8 Electronics/ Computer Science	16 Physical Education Offices	24 Propagation House
3 Art	9 Journalism	17 Swimming Pool	25 Ag Storage
4 Art Gallery	10 Classroom Annex	18 Physical Education- Women	26 Athletic Field #2
5 Music	11 Founders' Hall	19 Gymnasium	27 Athletic Field #1
6 Great Valley Museum	12 Forum	20 Science	28 Tennis Courts
	13 Student Center	21 Student Services	29 Stadium
	14 Learning Resource Center/ Library	22 Agriculture	30 Pirates' Village

Parking Symbols

☒	Security Call Box
☐	Parking 101-113
☐	Parking Dispenser
☐	Disabled Parking
☐	Motorcycle Parking
☐	Reserved Parking
☐	Visitor Parking
☐	Bicycle Parking
☐	Prime Shine - Pirate Express Shuttle

GVM EDUCATION DEMONSTRATION CENTER

Work this week: Finish metal roof panel installation. Complete electrical, HVAC, Data, Fire Alarm and Security Systems and perform final tests. Conduct punchlist walks.

Access: Caution at 3rd and E Street.
Partial closure at 4th Street.
See map below

Noise: Moderate: Heavy equipment deliveries



Parking: None

Utilities: None

Odors: None

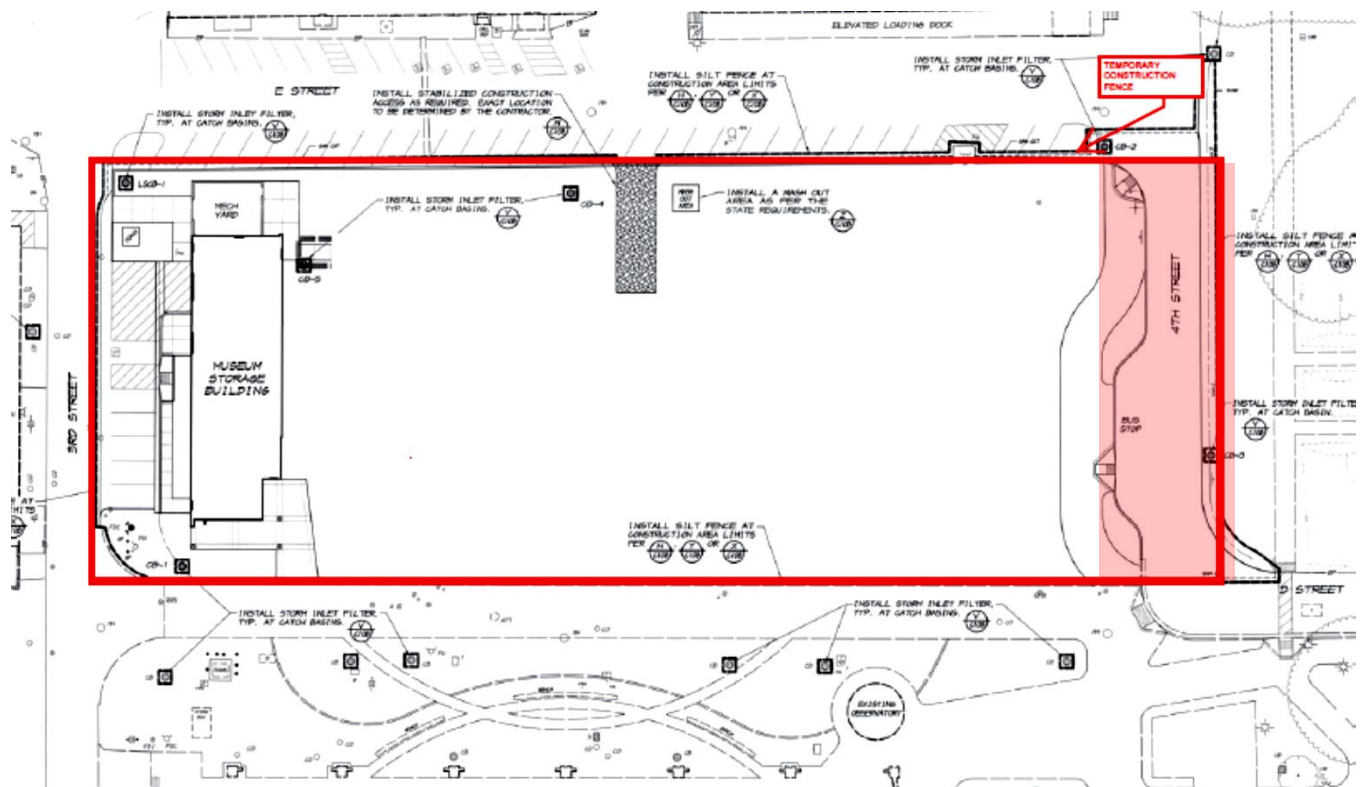
Dust: None





	Construction fencing, Restricted access
	4 th Street closed for the duration of the project

BLUE GUM AVE & PRICHARD AVE SIGNALIZATION

Work this week: Energize and program new traffic signals. Project expected to complete June 19, 2015.

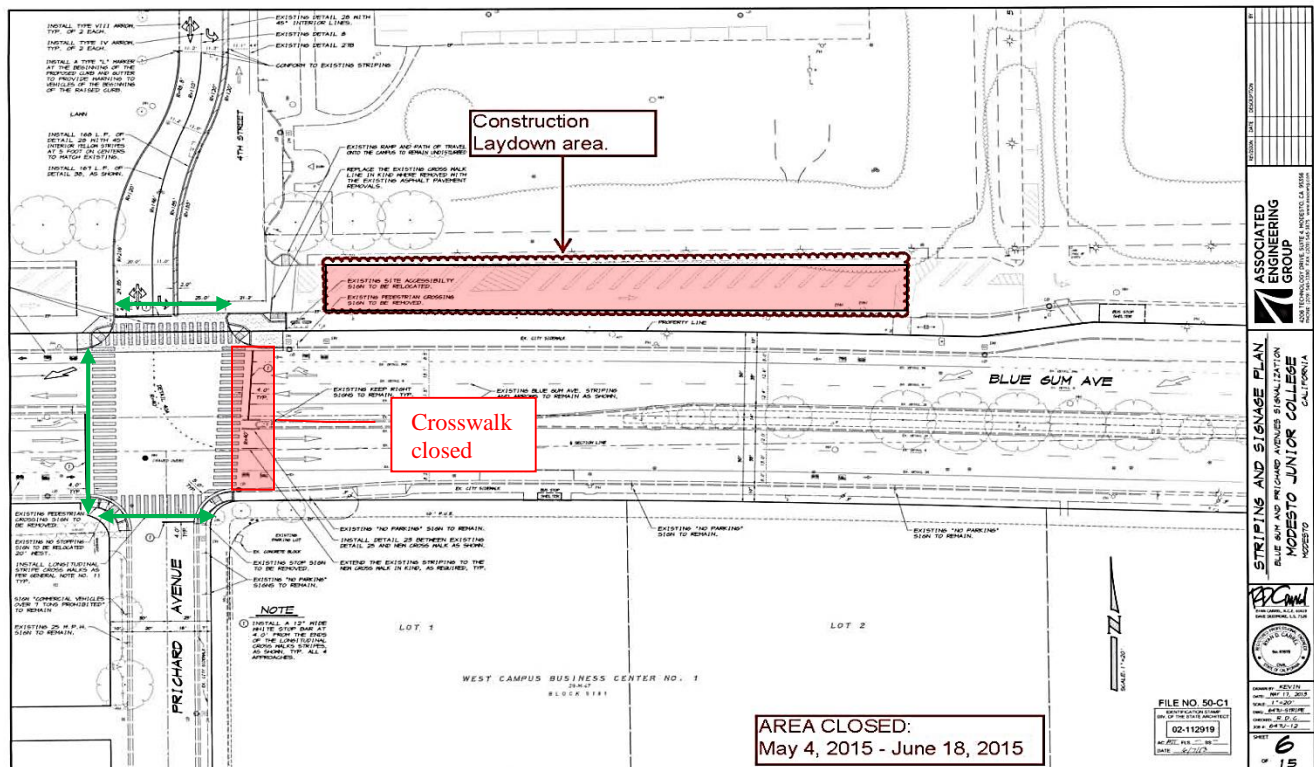
Access:	Caution at Blue Gum Ave. and 4 th Street Intersection. Partial closure at 4 th street entrance. Traffic control in place.
Noise:	Low: Demolition
Parking:	Parking closed along frontage road, east of 4 th street entrance.
Utilities:	None
Odors:	None
Dust:	None

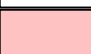

	Construction fencing, Restricted access
	Street closed for the duration of the project

If there are any questions or concerns contact Kitchell CEM, Measure E Bond Construction Manager, located at 2201 Blue Gum Ave., Modesto CA 95358 Tel: 575-6991 Email mkenney@kitchell.com