



# Measure E Bond Program MODESTO JUNIOR COLLEGE CAMPUS CONSTRUCTION UPDATE



## UPDATES & ACTIVITIES THAT MAY IMPACT CAMPUS OPERATION *Week of October 27, 2014*

### HIGH TECH (NORTH HALL) MODERNIZATION

**Work this week:** Pulling wires within conduits. Continued installation of sheet rock and texture. Continue interior paint and exterior paint. Continue installation of T-bar ceiling and electrical finish work. Start exterior panel installation work.

<b>Access:</b>	Partial closure at North Drive sidewalk
<b>Noise:</b>	Substantial: Drilling
<b>Parking:</b>	See attached map for closure.
<b>Utilities:</b>	None
<b>Odors:</b>	None

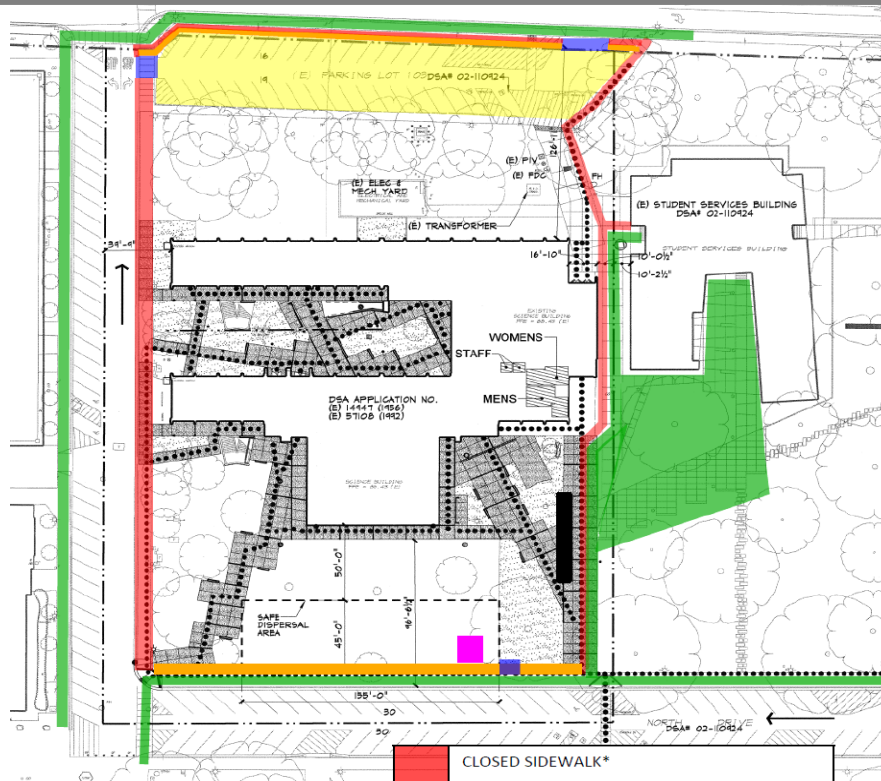

**NORTH HALL  
Access and Closure Map**

	CLOSED SIDEWALK*
	CLOSED PARKING LOT*
	GATE IN FENCE
	OPEN SIDEWALK (Portions may need to close towards the end of the project for new concrete)
	FENCE ALONG OPEN SIDEWALK
	CONSTRUCTION TRAILER
	KITCHELL TRAILER
	* Duration of the Project



# Measure E Bond Program MODESTO JUNIOR COLLEGE CAMPUS CONSTRUCTION UPDATE

Page 2 of 3

## GVM EDUCATION DEMONSTRATION CENTER

**Work this week:** Continue curbs and walkway near 4<sup>th</sup> street and E street. Remove debris and dirt from site.

<b>Access:</b>	Caution at 3 <sup>rd</sup> and E Street. Partial closure at 4 <sup>th</sup> Street. See map below
<b>Noise:</b>	Moderate: Heavy equipment deliveries
<b>Parking:</b>	None
<b>Utilities:</b>	None
<b>Odors:</b>	None
<b>Dust:</b>	None

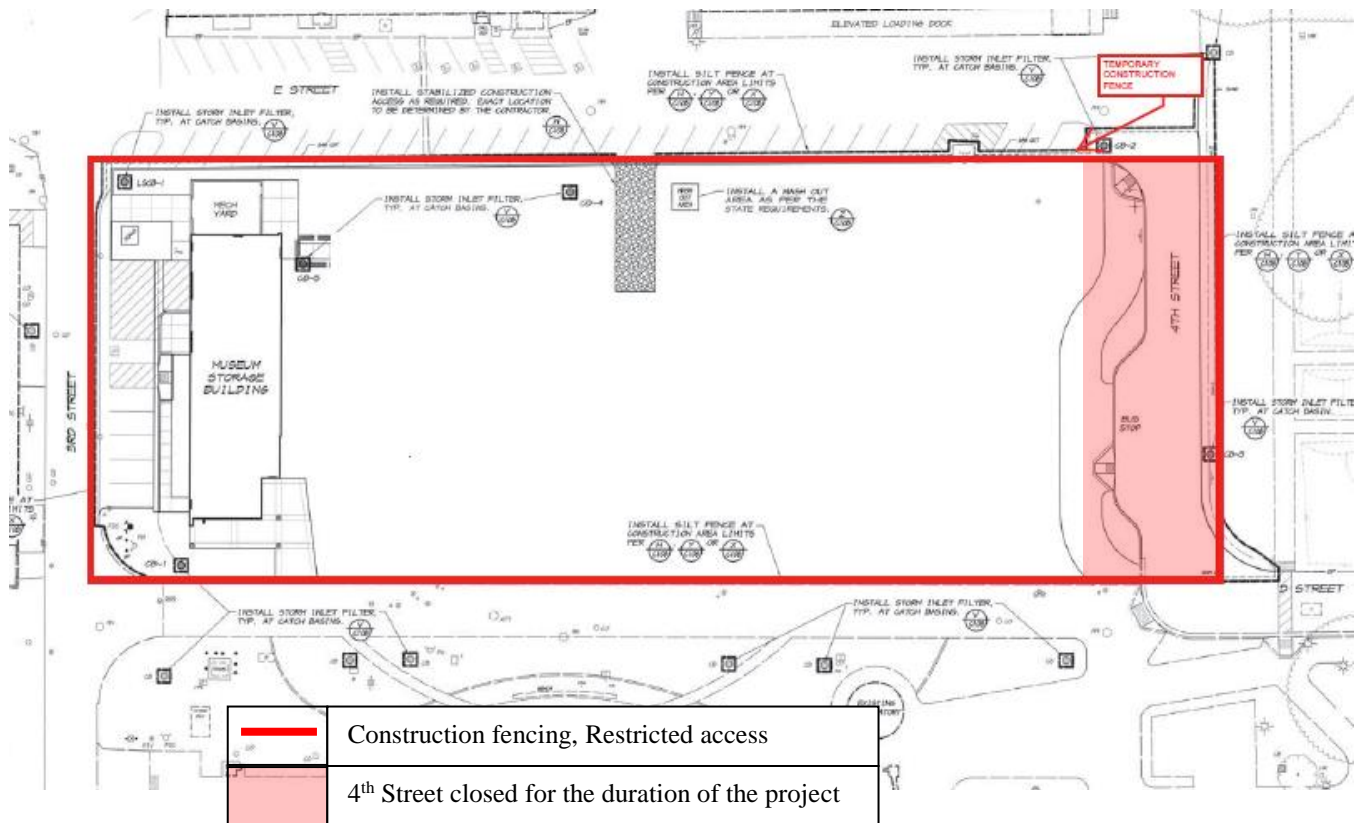

If there are any questions or concerns contact Kitchell CEM, Measure E Bond Construction Manager, located at 2201 Blue Gum Ave., Modesto CA 95358 Tel: 575-6991 Email [mkenney@kitchell.com](mailto:mkenney@kitchell.com)

