



Measure E Bond Program MODESTO JUNIOR COLLEGE CAMPUS CONSTRUCTION UPDATE



UPDATES & ACTIVITIES THAT MAY IMPACT CAMPUS OPERATION

Week of August 10, 2015

DISTRICT OFFICE BUILDING

Work this week: Setting rebar and digging footings.

Access: None.
Noise: Moderate due to construction equipment.
Parking: Some parking loss for duration of project.
Utilities: None.
Odors: None
Dust: Minor impact.

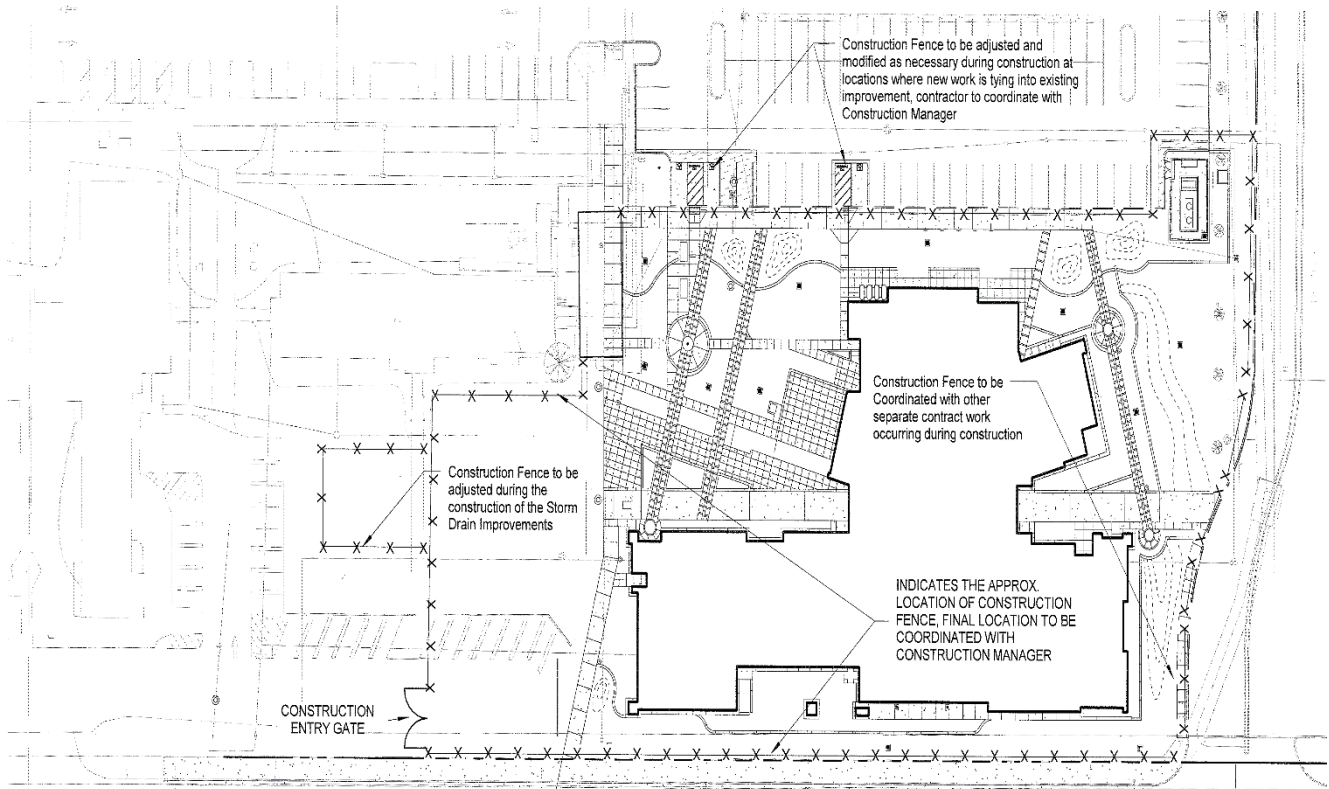

X-X-X

Construction fencing, Restricted access



Measure E Bond Program MODESTO JUNIOR COLLEGE CAMPUS CONSTRUCTION UPDATE Page 2 of 2

EAST CAMPUS ROADS – SOUTH DRIVE

Work this week: Stripe road and remove fence on August 14.

Access:	No access to South Drive for duration of project.
Noise:	Moderate due to construction equipment.
Parking:	No parking along South Drive for duration of project.
Utilities:	None.
Odors:	None.
Dust:	Minor from construction traffic



MJC East Campus

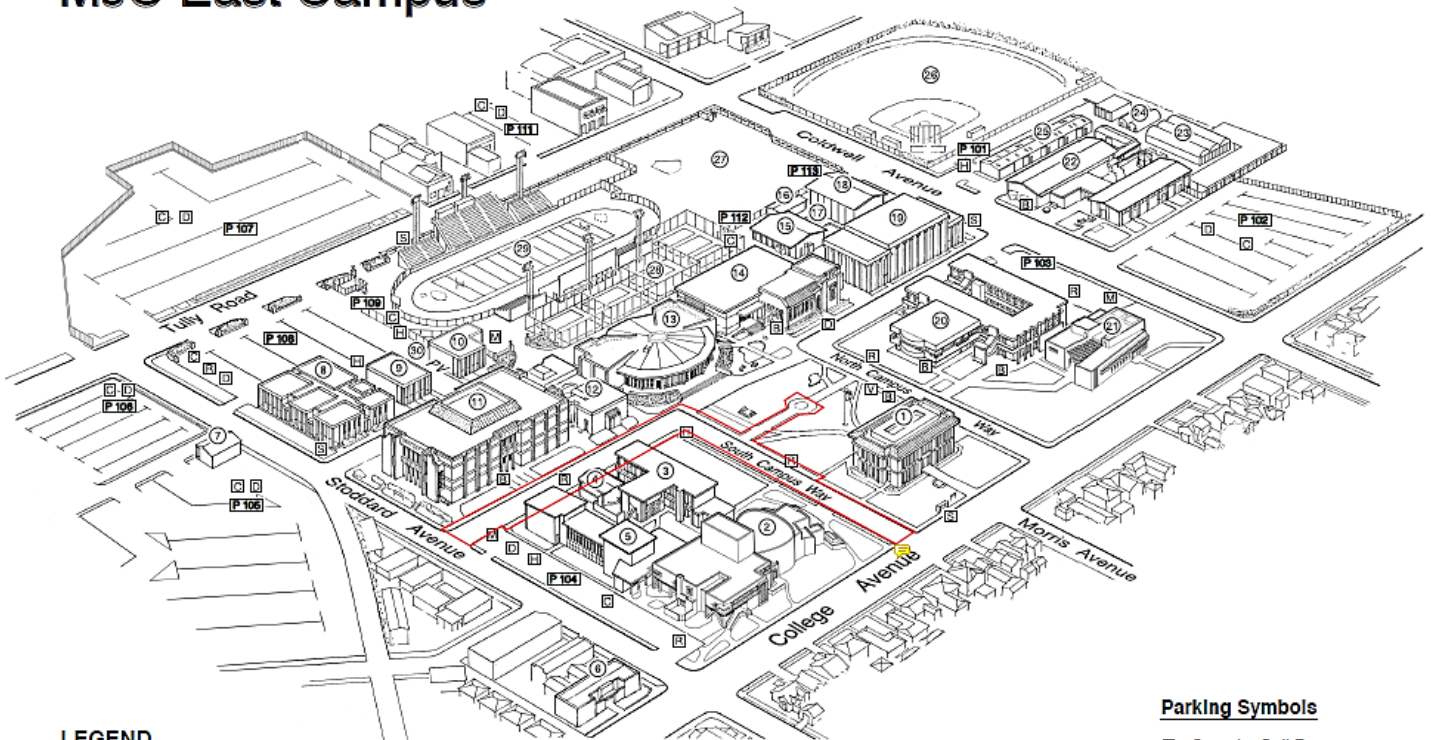

LEGEND

- | | | | |
|------------------------------------|--------------------------------------|-------------------------------|----------------------|
| 1 Administration (Morris Memorial) | 7 Facilities Operations | 15 Physical Education- Men | 23 Greenhouse |
| 2 Performing and Media Arts Center | 8 Electronics/ Computer Science | 16 Physical Education Offices | 24 Propagation House |
| 3 Art | 9 Journalism | 17 Swimming Pool | 25 Ag Storage |
| 4 Art Gallery | 10 Classroom Annex | 18 Physical Education- Women | 26 Athletic Field #2 |
| 5 Music | 11 Founders' Hall | 19 Gymnasium | 27 Athletic Field #1 |
| 6 Great Valley Museum | 12 Forum | 20 Science | 28 Tennis Courts |
| | 13 Student Center | 21 Student Services | 29 Stadium |
| | 14 Learning Resource Center/ Library | 22 Agriculture | 30 Pirates' Village |

Parking Symbols

- ☑ Security Call Box
- ☑ Parking 101-113
- ☑ Parking Dispenser
- ☑ Disabled Parking
- ☑ Motorcycle Parking
- ☑ Reserved Parking
- ☑ Visitor Parking
- ☑ Bicycle Parking
- ☑ Prime Shine - Pirate Express Shuttle

If there are any questions or concerns contact Kitchell CEM, Measure E Bond Construction Manager, located at 2201 Blue Gum Ave., Modesto CA 95358 Tel: 575-6991 Email mkenedy@kitchell.com

