



Measure E Bond Program MODESTO JUNIOR COLLEGE CAMPUS CONSTRUCTION UPDATE



UPDATES & ACTIVITIES THAT MAY IMPACT CAMPUS OPERATION

Week of July 22, 2013

INFRASTRUCTURE

Work this week: Working on punchlist items.

Access:	Moderate impact
Noise:	No anticipated impact
Parking:	No anticipated impact
Utilities:	No anticipated impact
Odors:	No anticipated impact
Dust:	No anticipated impact



SHIPPING & RECEIVING BLDG

Work this week: Working on punchlist items.

Access:	Caution at G Street and 5 th Street
Noise:	Moderate: equipment & deliveries
Parking:	No anticipated impact
Utilities:	No anticipated impact
Odors:	No anticipated impact
Dust:	No anticipated impact



PRIMARY DATA CENTER

Work this week: Continue installing cable trays and data racks in data room. Continue pulling data cables in data room. Continued installation of fire suppression system. Installing busducts in data room.

Access:	Caution at G Street and 3 rd street.
Noise:	Moderate impact
Parking:	No anticipated impact
Utilities:	No anticipated impact
Odors:	No anticipated impact
Dust:	Moderate impact





Measure E Bond Program MODESTO JUNIOR COLLEGE CAMPUS CONSTRUCTION UPDATE *continued (page 2 of 4)*

LIBRARY RENOVATION

Work this week: Continue painting, interior finishes and electrical installation. Continue exterior site work. Installation of security and fire alarm systems.

Access:	See access map below
Noise:	Moderate: equipment & deliveries
Parking:	See attached map for closure.
Utilities:	None
Odors:	None
Dust:	None



CAREER TRANSFER CENTER

Work this week: Continued mechanical, electrical and plumbing rough-in. Drywall and taping. Pulling wires. Install flooring.

Access:	See updated access map below
Noise:	Moderate: equipment & deliveries
Parking:	See attached map for closure.
Utilities:	None
Odors:	None
Dust:	None





Measure E Bond Program MODESTO JUNIOR COLLEGE CAMPUS CONSTRUCTION UPDATE *continued (page 3 of 4)*

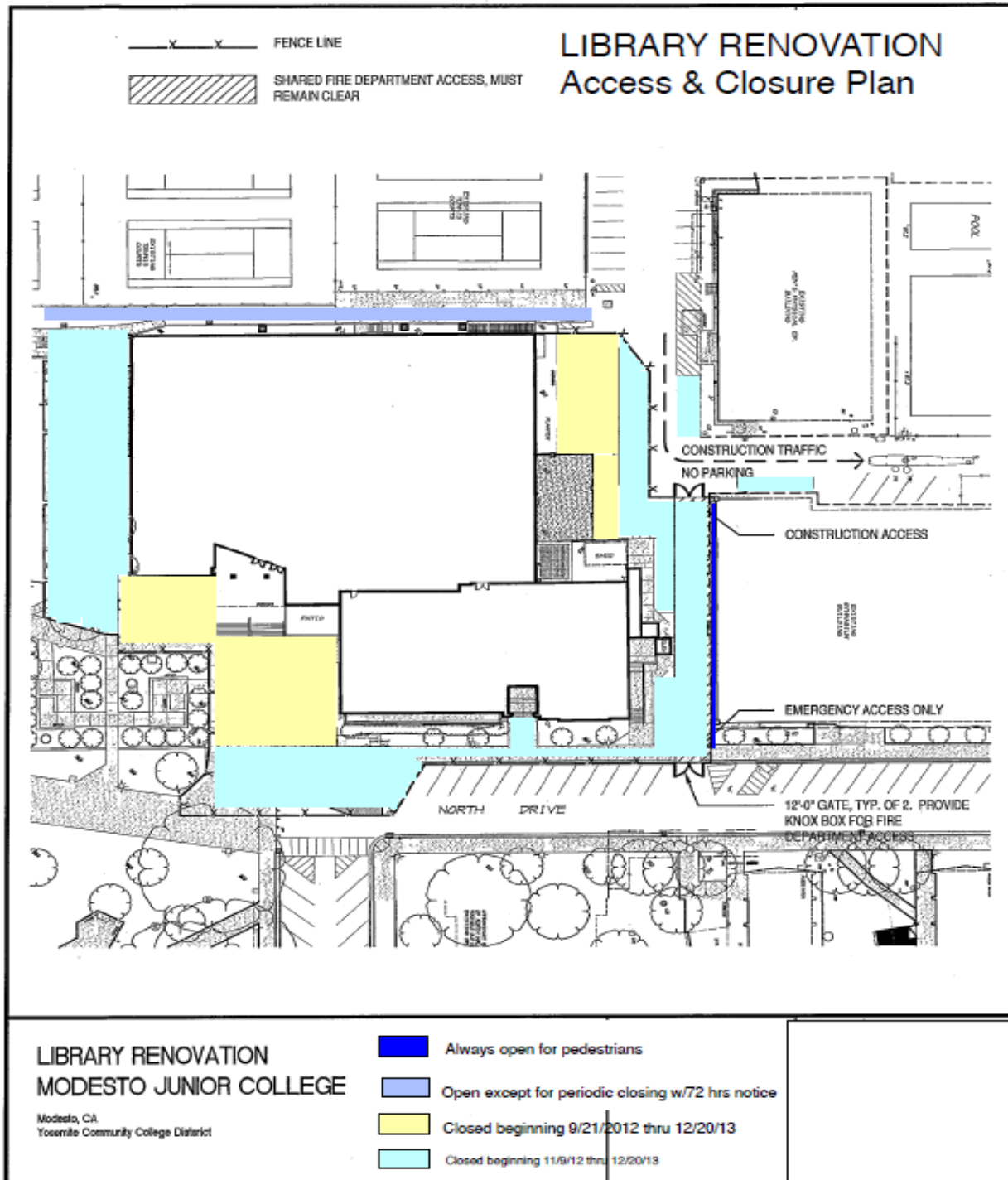



Measure E Bond Program
MODESTO JUNIOR COLLEGE CAMPUS
CONSTRUCTION UPDATE
continued (page 4 of 4)

CAREER DEVELOPMENT & TRANSFER CENTER – Access & Closure Map

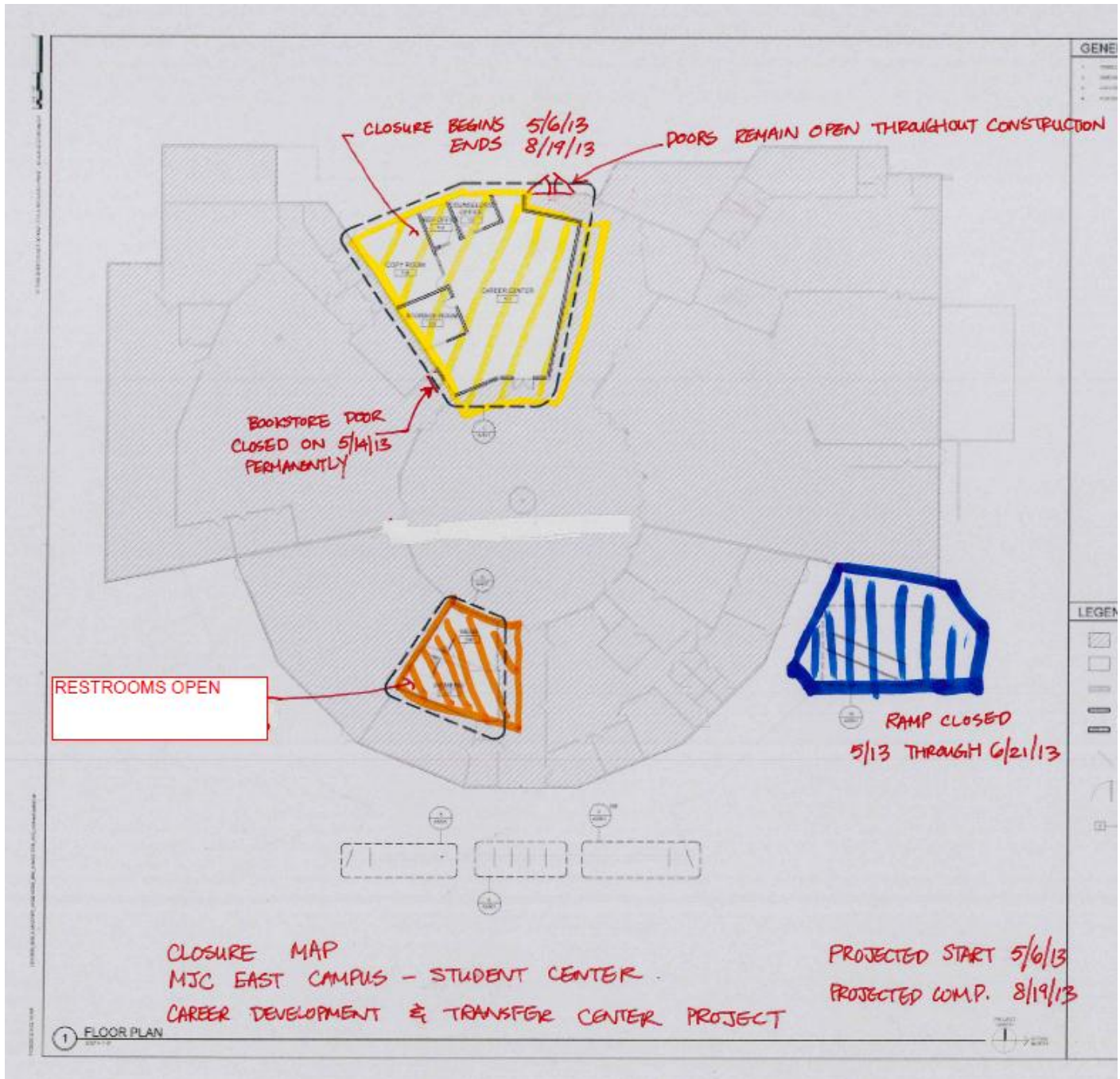

If there are any questions or concerns contact Kitchell CEM, Measure E Bond Construction Manager, located at 2201 Blue Gum Ave., Modesto CA 95358 Tel: 575-6991 Email mkennedy@kitchell.com

