



Measure E Bond Program MODESTO JUNIOR COLLEGE CAMPUS CONSTRUCTION UPDATE



UPDATES & ACTIVITIES THAT MAY IMPACT CAMPUS OPERATION

Week of July 8, 2013

INFRASTRUCTURE

Work this week: Fire Access Lane paving, from north end of Glacier Hall to "E" Street has been completed. Landscape Irrigation is ongoing. Continued installation of plants and shrubs.

Access:	Moderate impact
Noise:	No anticipated impact
Parking:	No anticipated impact
Utilities:	No anticipated impact
Odors:	No anticipated impact
Dust:	No anticipated impact



SHIPPING & RECEIVING BLDG

Work this week: Continued installation of MEP systems. Paint and texture interior walls. Continue landscaping.

Access:	Caution at G Street and 5 th Street
Noise:	Moderate: equipment & deliveries
Parking:	No anticipated impact
Utilities:	No anticipated impact
Odors:	No anticipated impact
Dust:	No anticipated impact



PRIMARY DATA CENTER

Work this week: Continue under access floor rough-in of electrical systems in data room. Continued installation of electrical panels and equipment in UPS rooms. Pull wire to UPS rooms. Continue installing cable trays and data racks in data room. Continue pulling data cables in data room. Continued installation of fire suppression system. Testing of FSS system.

Access:	Caution at G Street and 3 rd street.
Noise:	Moderate impact
Parking:	No anticipated impact
Utilities:	No anticipated impact
Odors:	No anticipated impact
Dust:	Moderate impact





Measure E Bond Program MODESTO JUNIOR COLLEGE CAMPUS CONSTRUCTION UPDATE *continued (page 2 of 4)*

LIBRARY RENOVATION

Work this week: Continue painting, interior finishes and electrical installation. Continue exterior site work.

Access:	See access map below
Noise:	Moderate: equipment & deliveries
Parking:	See attached map for closure.
Utilities:	None
Odors:	None
Dust:	None



CAREER TRANSFER CENTER

Work this week: Continued metal framing, mechanical, electrical and plumbing rough-in.

Access:	See updated access map below
Noise:	Moderate: equipment & deliveries
Parking:	See attached map for closure.
Utilities:	None
Odors:	None
Dust:	None





Measure E Bond Program
MODESTO JUNIOR COLLEGE CAMPUS
CONSTRUCTION UPDATE
continued (page 3 of 4)

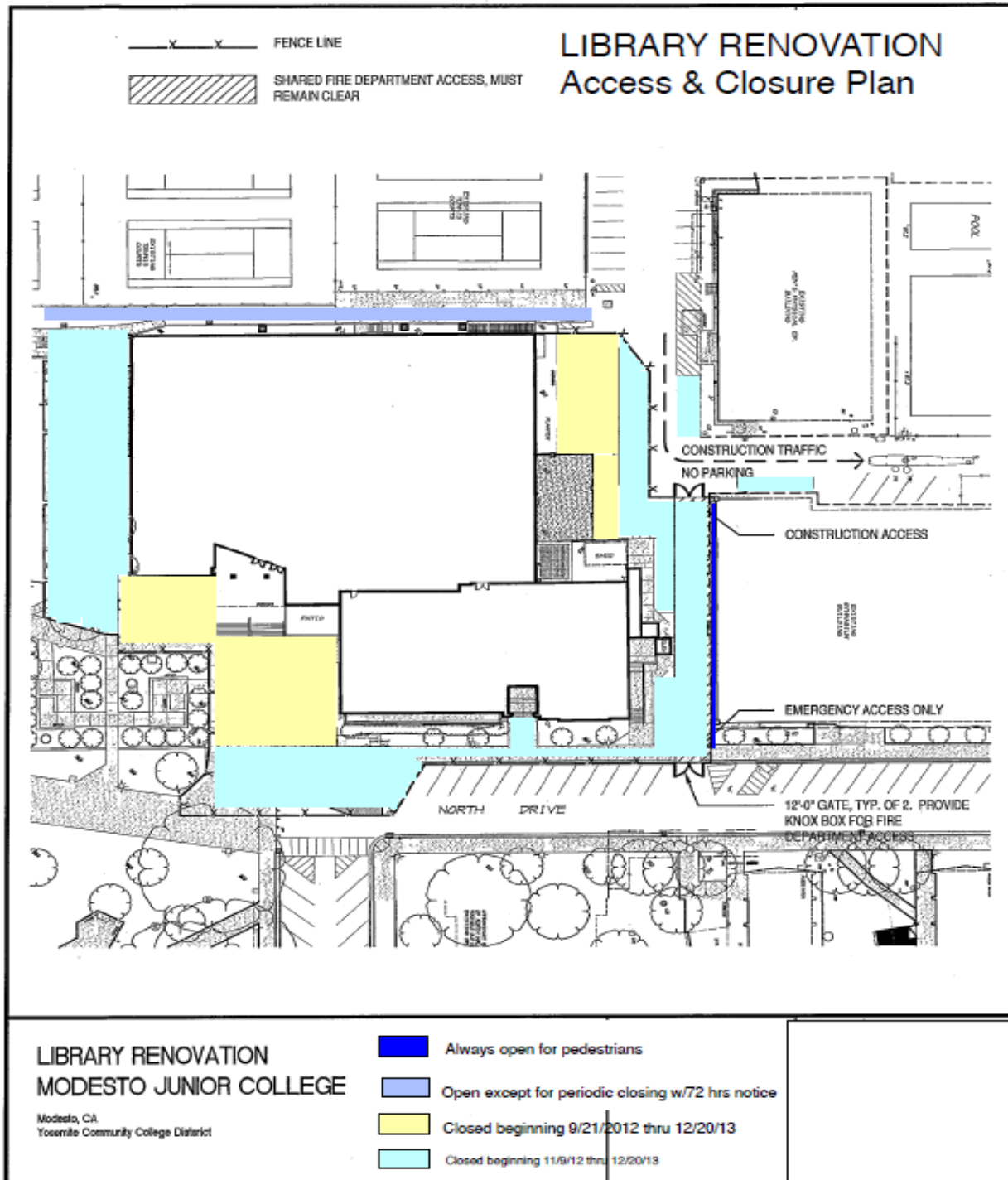



Measure E Bond Program
MODESTO JUNIOR COLLEGE CAMPUS
CONSTRUCTION UPDATE
continued (page 4 of 4)

CAREER DEVELOPMENT & TRANSFER CENTER – Access & Closure Map

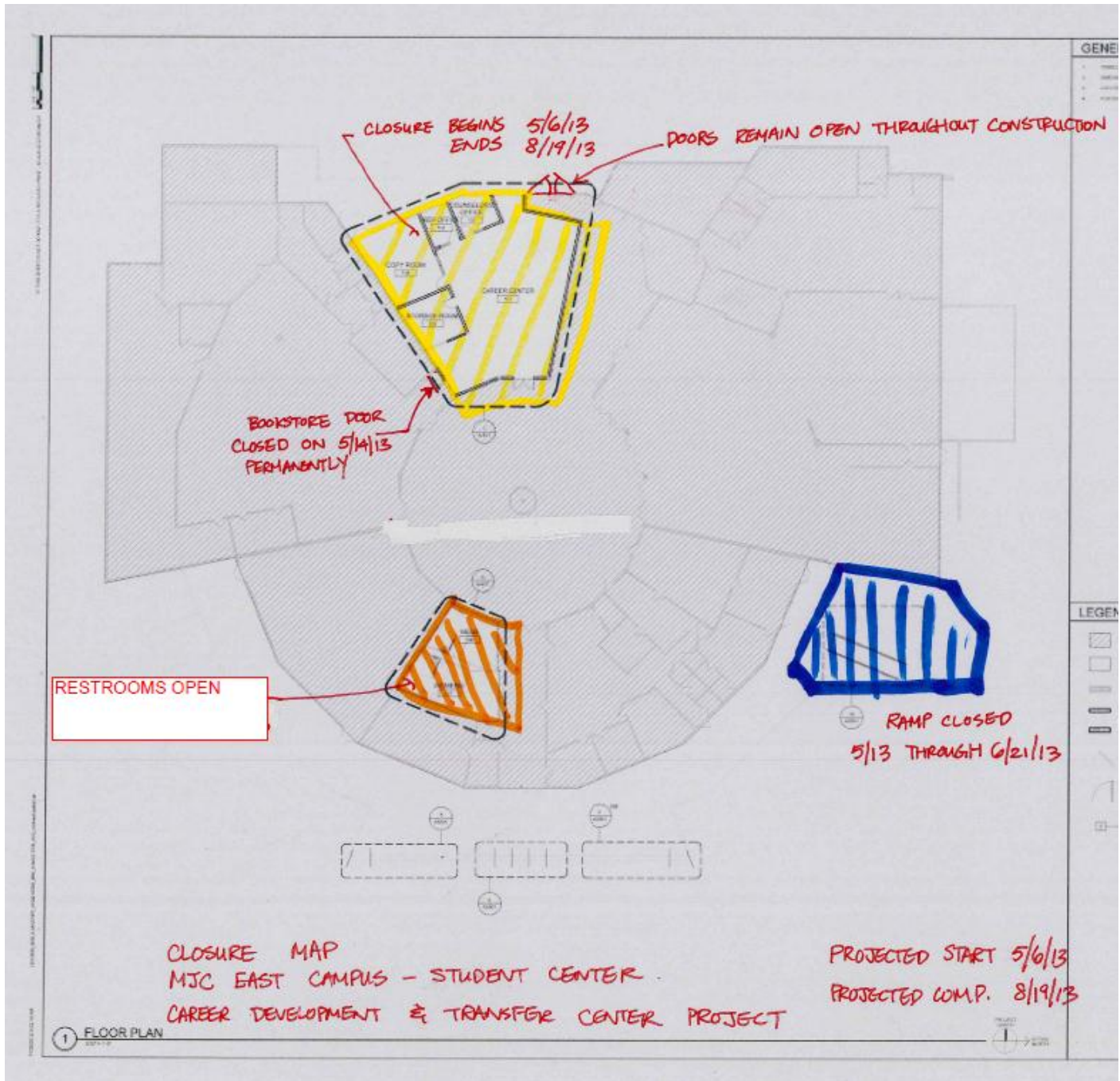

If there are any questions or concerns contact Kitchell CEM, Measure E Bond Construction Manager, located at 2201 Blue Gum Ave., Modesto CA 95358 Tel: 575-6991 Email mkennedy@kitchell.com

