



# Measure E Bond Program MODESTO JUNIOR COLLEGE CAMPUS CONSTRUCTION UPDATE



## UPDATES & ACTIVITIES THAT MAY IMPACT CAMPUS OPERATION

*Week of July 1, 2013*

### INFRASTRUCTURE

**Work this week:** Fire Access Lane paving, from north end of Glacier Hall to "E" Street has been completed. Landscape Irrigation is ongoing. Continued installation of plants and shrubs.

<b>Access:</b>	Moderate impact
<b>Noise:</b>	No anticipated impact
<b>Parking:</b>	No anticipated impact
<b>Utilities:</b>	No anticipated impact
<b>Odors:</b>	No anticipated impact
<b>Dust:</b>	No anticipated impact



### SHIPPING & RECEIVING BLDG

**Work this week:** Continued installation of MEP systems. Paint and texture interior walls. Continue landscaping.

<b>Access:</b>	Caution at G Street and 5 <sup>th</sup> Street
<b>Noise:</b>	Moderate: equipment & deliveries
<b>Parking:</b>	No anticipated impact
<b>Utilities:</b>	No anticipated impact
<b>Odors:</b>	No anticipated impact
<b>Dust:</b>	No anticipated impact



### PRIMARY DATA CENTER

**Work this week:** Continue under access floor rough-in of electrical systems in data room. Continued installation of electrical panels and equipment in UPS rooms. Pull wire to UPS rooms. Continue installing cable trays and data racks in data room. Continue pulling data cables in data room. Continued installation of fire suppression system. Testing of FSS system.

<b>Access:</b>	Caution at G Street and 3 <sup>rd</sup> street.
<b>Noise:</b>	Moderate impact
<b>Parking:</b>	No anticipated impact
<b>Utilities:</b>	No anticipated impact
<b>Odors:</b>	No anticipated impact
<b>Dust:</b>	Moderate impact





# Measure E Bond Program MODESTO JUNIOR COLLEGE CAMPUS CONSTRUCTION UPDATE *continued (page 2 of 4)*

## **LIBRARY RENOVATION**

**Work this week:** Continue painting, interior finishes and electrical installation. Continue exterior site work.

<b>Access:</b>	See access map below
<b>Noise:</b>	Moderate: equipment & deliveries
<b>Parking:</b>	See attached map for closure.
<b>Utilities:</b>	None
<b>Odors:</b>	None
<b>Dust:</b>	None



## **CAREER TRANSFER CENTER**

**Work this week:** Continued metal framing, mechanical, electrical and plumbing rough-in.

<b>Access:</b>	See updated access map below
<b>Noise:</b>	Moderate: equipment & deliveries
<b>Parking:</b>	See attached map for closure.
<b>Utilities:</b>	None
<b>Odors:</b>	None
<b>Dust:</b>	None





Measure E Bond Program  
MODESTO JUNIOR COLLEGE CAMPUS  
CONSTRUCTION UPDATE  
continued (page 3 of 4)

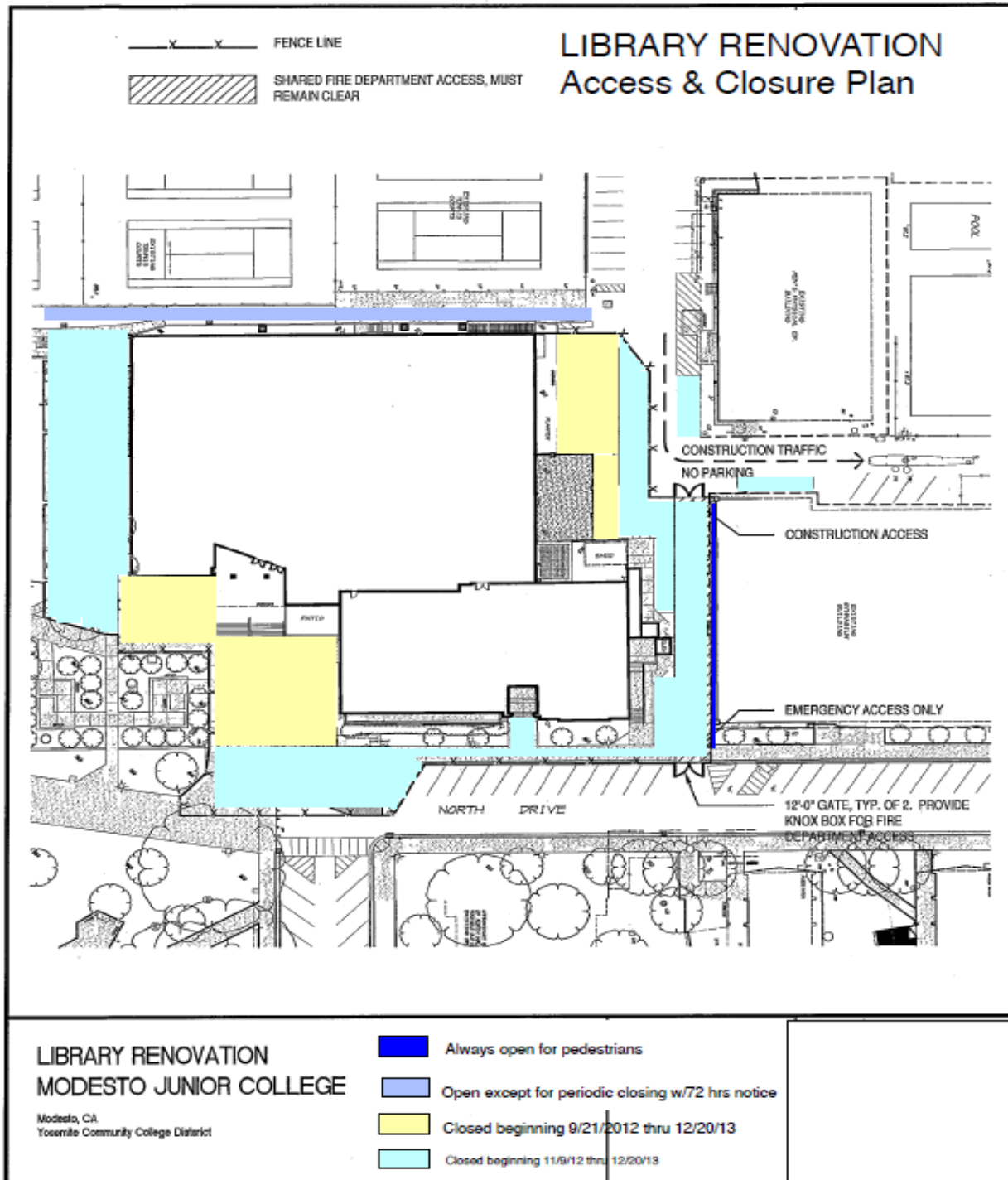





Measure E Bond Program  
MODESTO JUNIOR COLLEGE CAMPUS  
CONSTRUCTION UPDATE  
continued (page 4 of 4)

CAREER DEVELOPMENT & TRANSFER CENTER – Access & Closure Map

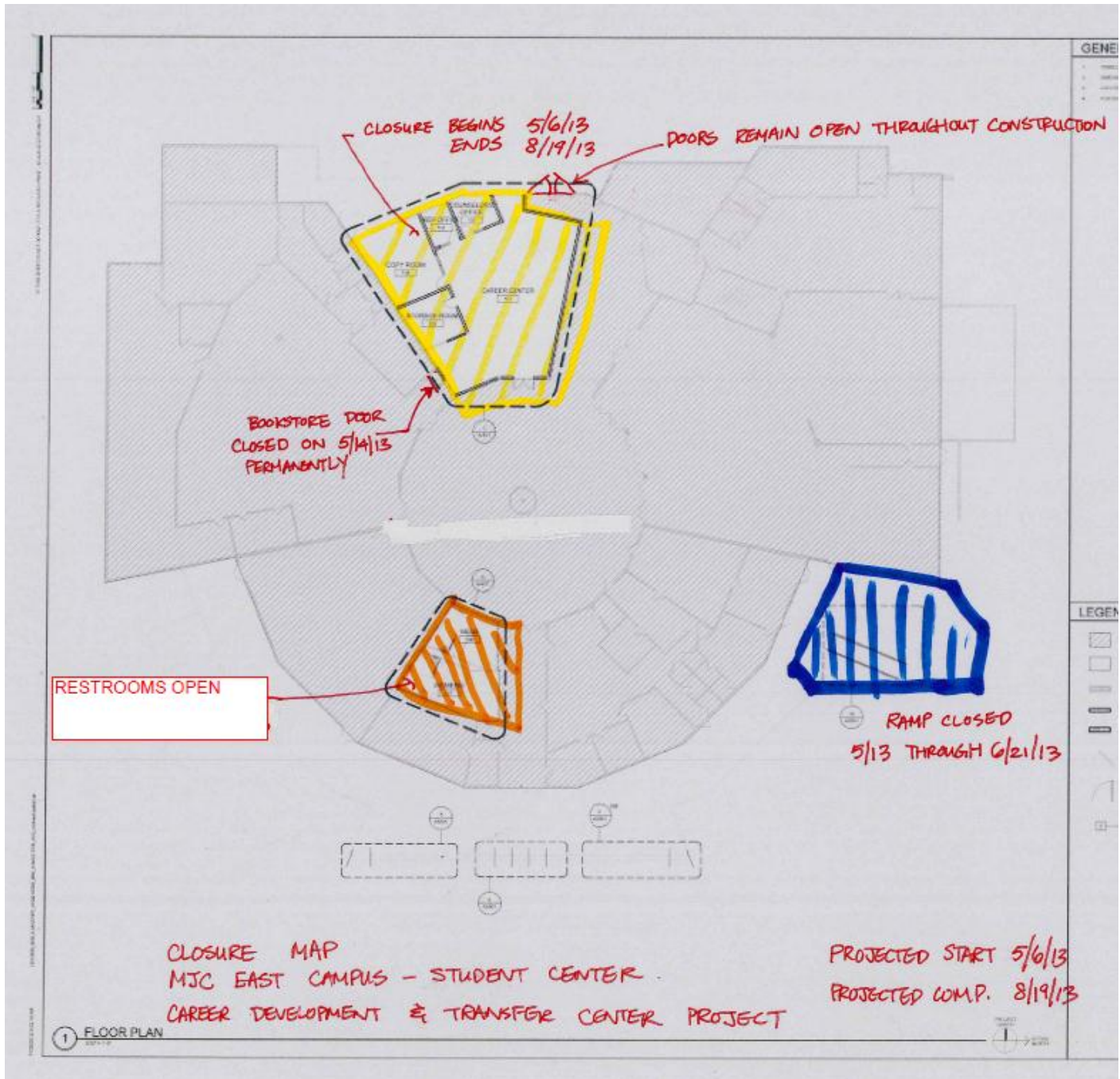

If there are any questions or concerns contact Kitchell CEM, Measure E Bond Construction Manager, located at 2201 Blue Gum Ave., Modesto CA 95358 Tel: 575-6991 Email [mkenedy@kitchell.com](mailto:mkenedy@kitchell.com)

