



# Measure E Bond Program MODESTO JUNIOR COLLEGE CAMPUS CONSTRUCTION UPDATE



## UPDATES & ACTIVITIES THAT MAY IMPACT CAMPUS OPERATION

*Week of June 3, 2013*

### INFRASTRUCTURE

**Work this week:** Continued installation of way finding signs. Continued site grading, completing concrete benches and preparing for landscaping.

<b>Access:</b>	Moderate impact
<b>Noise:</b>	No anticipated impact
<b>Parking:</b>	No anticipated impact
<b>Utilities:</b>	No anticipated impact
<b>Odors:</b>	No anticipated impact
<b>Dust:</b>	No anticipated impact



### SHIPPING & RECEIVING BLDG

**Work this week:** Continued installation of MEP systems. Paint and texture interior walls. Continue landscaping.

<b>Access:</b>	Caution at G Street and 5 <sup>th</sup> Street
<b>Noise:</b>	Moderate: equipment & deliveries
<b>Parking:</b>	No anticipated impact
<b>Utilities:</b>	No anticipated impact
<b>Odors:</b>	No anticipated impact
<b>Dust:</b>	No anticipated impact



### PRIMARY DATA CENTER

**Work this week:** Continue under access floor rough-in of electrical, mechanical and plumbing systems in data room. Continued installation of electrical panels and equipment in UPS rooms. Pull wire to UPS rooms. Install interior door hardware. Install access floor in data room.

<b>Access:</b>	Caution at G Street and 3 <sup>rd</sup> street.
<b>Noise:</b>	Moderate impact
<b>Parking:</b>	No anticipated impact
<b>Utilities:</b>	No anticipated impact
<b>Odors:</b>	No anticipated impact
<b>Dust:</b>	Moderate impact





# Measure E Bond Program MODESTO JUNIOR COLLEGE CAMPUS CONSTRUCTION UPDATE *continued (page 2 of 4)*

## **LIBRARY RENOVATION**

**Work this week:** Continue painting, interior finishes and electrical installation. Continue exterior site work and roof demolition.

<b>Access:</b>	See access map below
<b>Noise:</b>	Moderate: equipment & deliveries
<b>Parking:</b>	See attached map for closure.
<b>Utilities:</b>	None
<b>Odors:</b>	None
<b>Dust:</b>	None



## **CAREER TRANSFER CENTER**

**Work this week:** Concrete slab coring, metal framing, mechanical, electrical and plumbing rough-in.

<b>Access:</b>	See updated access map below
<b>Noise:</b>	Moderate: equipment & deliveries
<b>Parking:</b>	See attached map for closure.
<b>Utilities:</b>	None
<b>Odors:</b>	None
<b>Dust:</b>	None





Measure E Bond Program  
MODESTO JUNIOR COLLEGE CAMPUS  
CONSTRUCTION UPDATE  
continued (page 3 of 4)

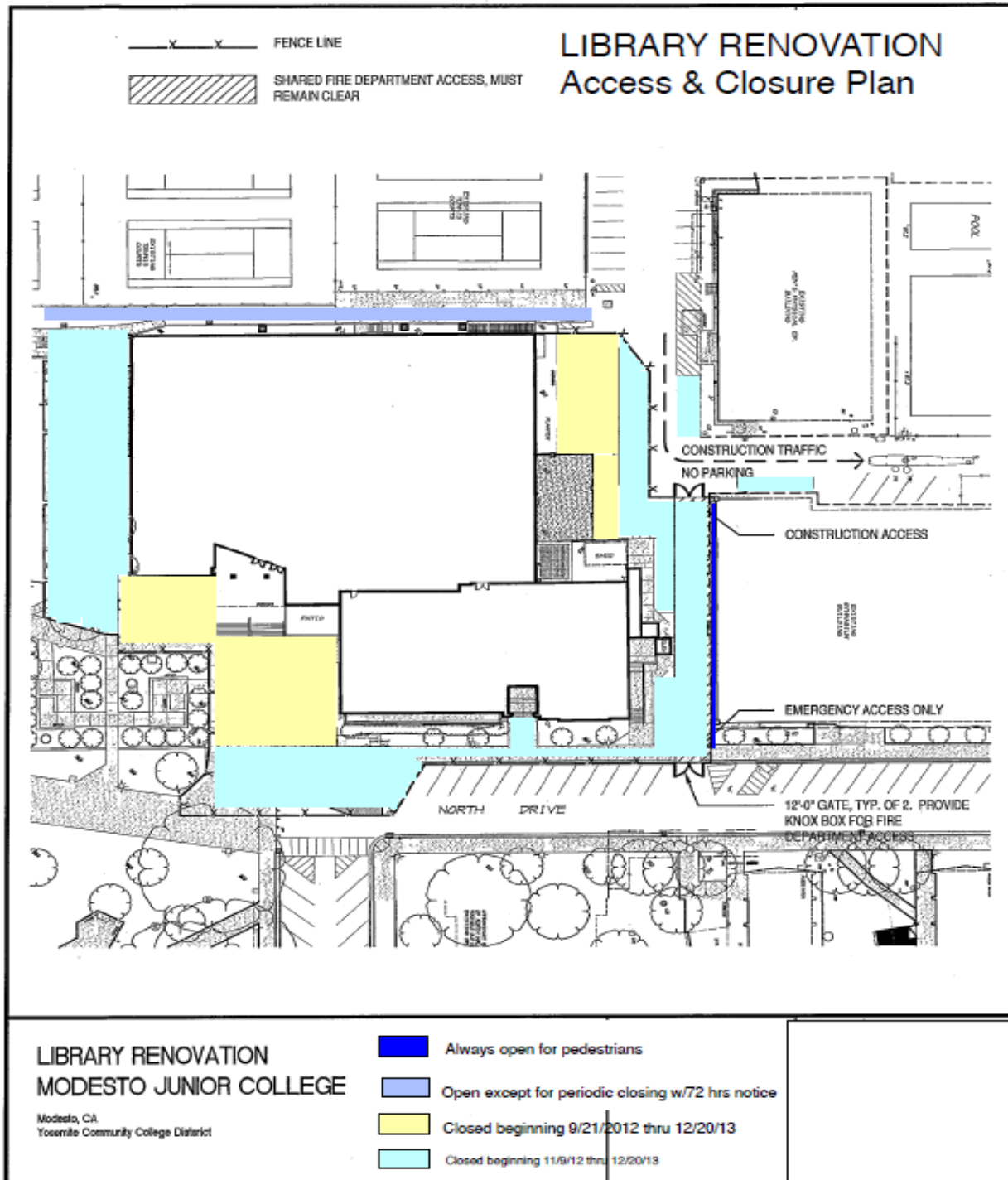





**Measure E Bond Program**  
**MODESTO JUNIOR COLLEGE CAMPUS**  
**CONSTRUCTION UPDATE**  
*continued (page 4 of 4)*

**CAREER DEVELOPMENT & TRANSFER CENTER – Access & Closure Map (Updated 05/09/2013)**

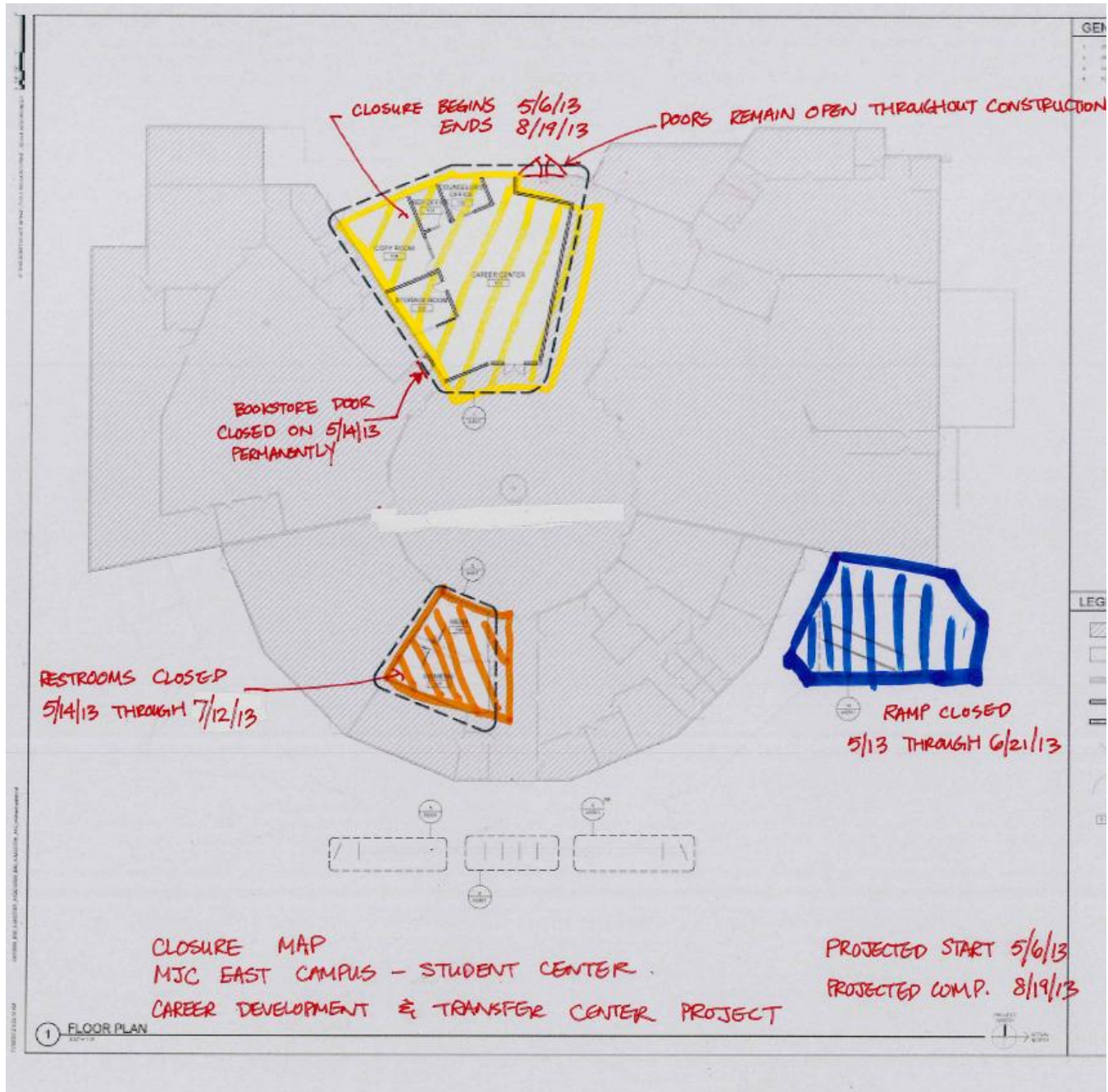

If there are any questions or concerns contact Kitchell CEM, Measure E Bond Construction Manager, located at 2201 Blue Gum Ave., Modesto CA 95358 Tel: 575-6991 Email [mkennedy@kitchell.com](mailto:mkennedy@kitchell.com)

