



Measure E Bond Program MODESTO JUNIOR COLLEGE CAMPUS CONSTRUCTION UPDATE



UPDATES & ACTIVITIES THAT MAY IMPACT CAMPUS OPERATION

Week of November 5, 2012

SCIENCE COMMUNITY CENTER

Work this week: Continued installation of ceiling tiles. Installation of casework and lab cabinetry. Continued site work. Installation of flooring on 2nd and 3rd floors. Electrical, mechanical and plumbing finish work. Installation of planetarium dome. Interior and exterior painting.

Access:	No anticipated impact
Noise:	Moderate impact
Parking:	No anticipated impact
Utilities:	No anticipated impact
Odors:	No anticipated impact
Dust:	No anticipated impact



WEST CAMPUS PARKING LOT

Work this week: Continue landscape and irrigation. Continued electrical installation for light poles and ticket machine. Finishing final grades. Asphalt paving installation this week.

Access:	Caution at 4 th and B Street, sidewalk closed at east end of Lot 202.
Noise:	No anticipated impact
Parking:	11 stalls at east end of Lot 202 impacted
Utilities:	No anticipated impact
Odors:	No anticipated impact
Dust:	No anticipated impact



AG PAVILION SITE IMPROVEMENTS

Work this week: Continue installation of feedlot.

Access:	Limited access when using G Street & Student Center Dr.
Noise:	Moderate impact
Parking:	No anticipated impact
Utilities:	No anticipated impact
Odors:	No anticipated impact
Dust:	No anticipated impact





Measure E Bond Program MODESTO JUNIOR COLLEGE CAMPUS CONSTRUCTION UPDATE *continued (page 2 of 3)*

SHIPPING & RECEIVING BLDG

Work this week: No major activities taking place. Continued dust control.

Access:	Caution when using G Street & 5 th Street.
Noise:	Moderate impact
Parking:	No anticipated impact
Utilities:	No anticipated impact
Odors:	No anticipated impact
Dust:	No anticipated impact



PRIMARY DATA CENTER

Work this week: Continued under slab plumbing and electrical. Install waterproofing at data room. Installation of waterlines and French drain.

Access:	Caution at G Street and 3 rd street.
Noise:	Moderate impact
Parking:	No anticipated impact
Utilities:	No anticipated impact
Odors:	No anticipated impact
Dust:	Moderate impact



LIBRARY REMEDIATION

Work this week: Continue demolition and abatement on the first floor and begin flooring removal and abatement in the basement.

Access:	See updated access map below
Noise:	High: equipment noise
Parking:	Stalls in the alley between the Library and the Gym continue to be closed, additional stalls on North Road will be closed beginning 11/9. See attached map for closure.
Utilities:	Power to library except for the essential HVAC circuits remain off. Water to the Library will be turned off for a few hours.
Odors:	None
Dust:	None





Measure E Bond Program
MODESTO JUNIOR COLLEGE CAMPUS
CONSTRUCTION UPDATE
continued (page 3 of 3)

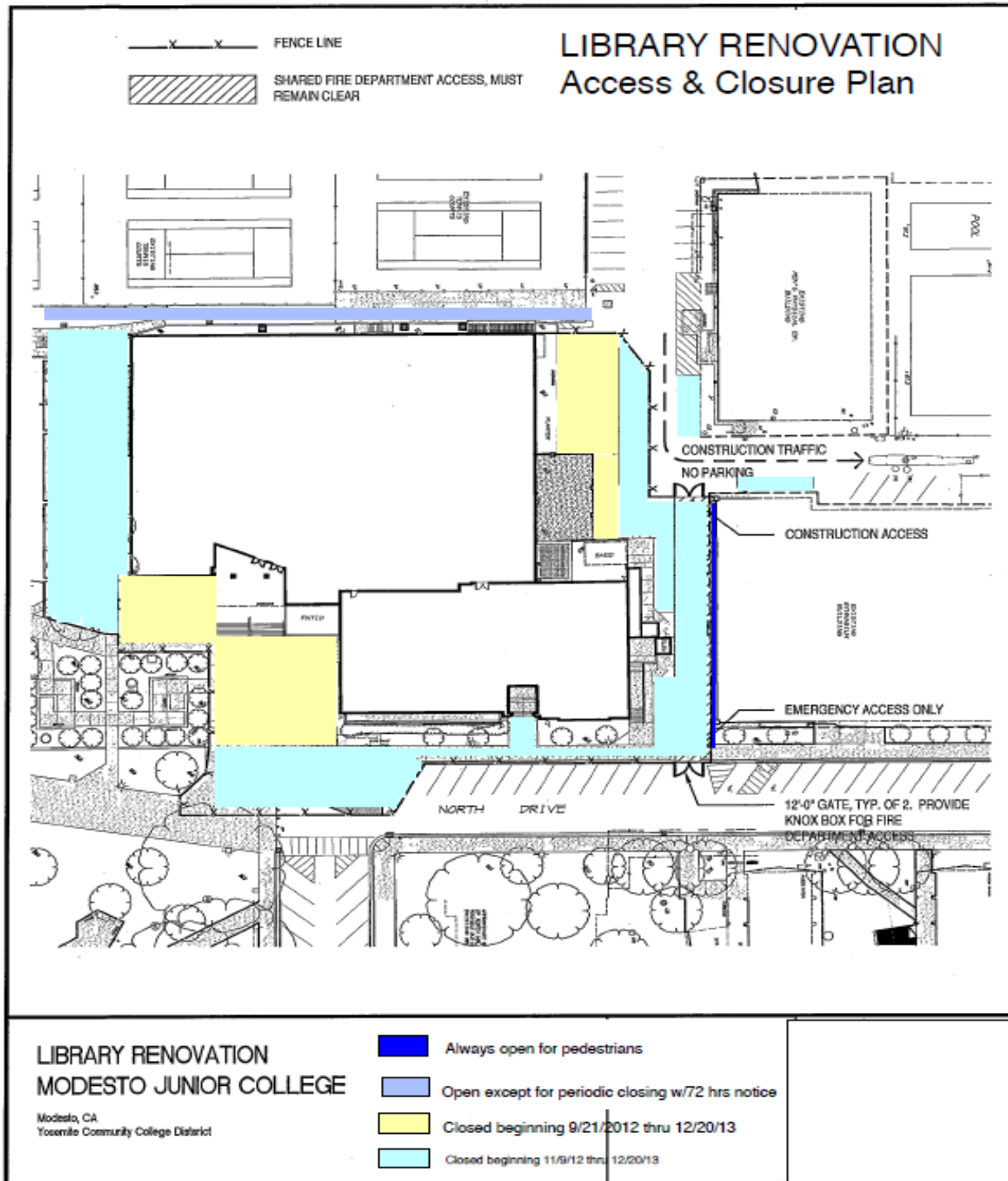

If there are any questions or concerns contact Kitchell CEM, Measure E Bond Construction Manager, located at 2201 Blue Gum Ave., Modesto CA 95358 Tel: 575-6991 Email mkenney@kitchell.com

