



Measure E Bond Program MODESTO JUNIOR COLLEGE CAMPUS CONSTRUCTION UPDATE



UPDATES & ACTIVITIES THAT MAY IMPACT CAMPUS OPERATION

Week of October 15, 2012

SCIENCE COMMUNITY CENTER

Work this week: Continued installation of ceiling tiles. Installation of casework and lab cabinetry. Continued site work. Installation of flooring on 2nd and 3rd floors. Electrical, mechanical and plumbing finish work. Installation of planetarium dome. Interior and exterior painting.

Access:	No anticipated impact
Noise:	Moderate impact
Parking:	No anticipated impact
Utilities:	No anticipated impact
Odors:	No anticipated impact
Dust:	No anticipated impact



WEST CAMPUS PARKING LOT

Work this week: Continue landscape and irrigation. Continued electrical installation for light poles and ticket machine.

Access:	Caution at 4 th and B Street, sidewalk closed at east end of Lot 202.
Noise:	No anticipated impact
Parking:	11 stalls at east end of Lot 202 impacted
Utilities:	No anticipated impact
Odors:	No anticipated impact
Dust:	No anticipated impact



AG PAVILION SITE IMPROVEMENTS

Work this week: Continue installation of fencing at gates. Continue installation of feedlot. Complete installation of ticket machine at parking lot.

Access:	Limited access when using G Street & Student Center Dr.
Noise:	Moderate impact
Parking:	No anticipated impact
Utilities:	No anticipated impact
Odors:	No anticipated impact
Dust:	No anticipated impact





Measure E Bond Program MODESTO JUNIOR COLLEGE CAMPUS CONSTRUCTION UPDATE *continued (page 2 of 3)*

SHIPPING & RECEIVING BLDG

Work this week: No major activities taking place. Continued dust control.

Access:	Caution when using G Street & 5 th Street.
Noise:	Moderate impact
Parking:	No anticipated impact
Utilities:	No anticipated impact
Odors:	No anticipated impact
Dust:	No anticipated impact



PRIMARY DATA CENTER

Work this week: Pouring concrete stem walls on Tuesday. Stripping forms and back filling. Begin under slab plumbing and electrical.

Access:	Caution at G Street and 3 rd street.
Noise:	Moderate impact
Parking:	No anticipated impact
Utilities:	No anticipated impact
Odors:	No anticipated impact
Dust:	Moderate impact



LIBRARY RENOVATION

Work this week: Continue abatement on the first floor of the library. Prepare for abatement in the basement.

Access:	No access to Library Building, see attached map.
Noise:	Moderate: equipment & deliveries
Parking:	16 stalls in the alley between the Library and the Gym continues to be closed.
Utilities:	All electrical circuits inside the Library with the exceptions of the circuits providing power to HVAC system to adjacent building are turned off. Water to Library will be turned off for a few hours.
Odors:	Yes, cutting of metal material
Dust:	None





Measure E Bond Program MODESTO JUNIOR COLLEGE CAMPUS CONSTRUCTION UPDATE *continued (page 3 of 3)*

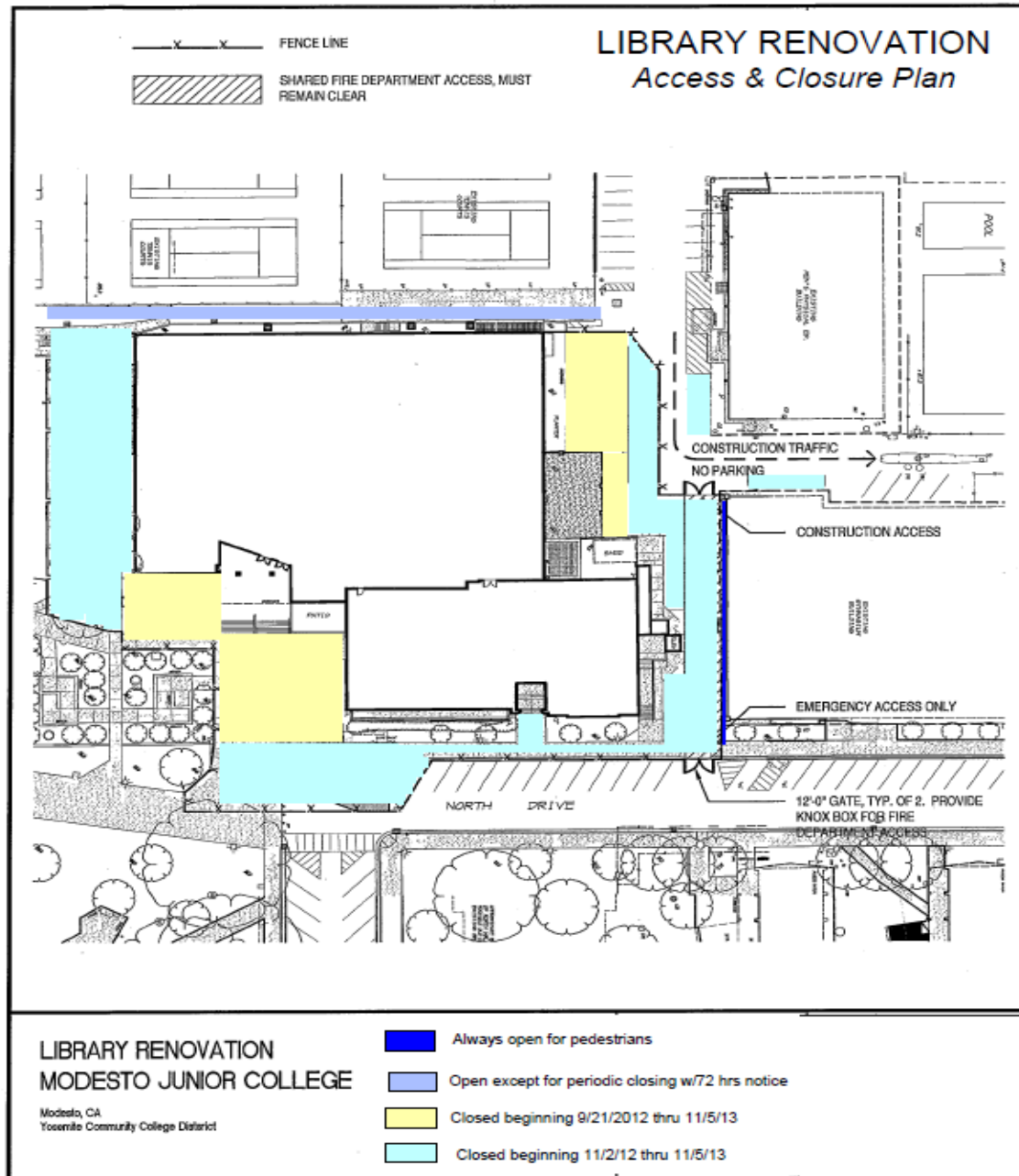

If there are any questions or concerns contact Kitchell CEM, Measure E Bond Construction Manager, located at 2201 Blue Gum Ave., Modesto CA 95358 Tel: 575-6991 Email mkennedy@kitchell.com

