



Measure E Bond Program MODESTO JUNIOR COLLEGE CAMPUS CONSTRUCTION UPDATE



UPDATES & ACTIVITIES THAT MAY IMPACT CAMPUS OPERATION

Week of September 24, 2012

SCIENCE COMMUNITY CENTER

Work this week: Plastering of exterior nearing completion, installation of ceiling tiles, installation of casework and lab cabinetry on 2nd and 3rd floor, installation of carpeting in admin tower, site work beginning.

Access:	No anticipated impact
Noise:	Moderate impact
Parking:	No anticipated impact
Utilities:	No anticipated impact
Odors:	No anticipated impact
Dust:	No anticipated impact



WEST CAMPUS PARKING LOT

Work this week: Continued installation of site utilities and finish grades.

Access:	Caution at 4 th and B Street, sidewalk closed at east end of Lot 202.
Noise:	No anticipated impact
Parking:	11 stalls at east end of Lot 202 impacted
Utilities:	No anticipated impact
Odors:	No anticipated impact
Dust:	No anticipated impact



AG PAVILION SITE IMPROVEMENTS

Work this week: Working on punchlist items.

Access:	Limited access when using G Street & Student Center Dr.
Noise:	Moderate impact
Parking:	No anticipated impact
Utilities:	No anticipated impact
Odors:	No anticipated impact
Dust:	No anticipated impact





Measure E Bond Program MODESTO JUNIOR COLLEGE CAMPUS CONSTRUCTION UPDATE *continued (page 2 of 3)*

SHIPPING & RECEIVING BLDG

Work this week: Excavating for retention basin and loading dock. Installation of underground utilities.

Access:	Caution when using G Street & 5 th Street.
Noise:	Moderate impact
Parking:	No anticipated impact
Utilities:	No anticipated impact
Odors:	No anticipated impact
Dust:	No anticipated impact



PRIMARY DATA CENTER

Work this week: Excavation and installation of underground utilities. Framing and setting forms for footings and building pad.

Access:	No anticipated impact
Noise:	Moderate impact
Parking:	No anticipated impact
Utilities:	No anticipated impact
Odors:	No anticipated impact
Dust:	Low impact



LIBRARY RENOVATION

Work this week: Contractor mobilized and begun soft demolition.

Access:	See attached map
Noise:	Moderate: equipment and deliveries

Parking: 5 stalls on North Street, 16 stalls in alley between the PE buildings and the library to be closed by next Tuesday

Utilities: All electrical circuits inside the library except for the exterior lighting and circuits providing power to the HVAC system and power to the adjacent building are turned off

Odors:	No anticipated impact
Dust:	Low impact





Measure E Bond Program MODESTO JUNIOR COLLEGE CAMPUS CONSTRUCTION UPDATE *continued (page 3 of 3)*

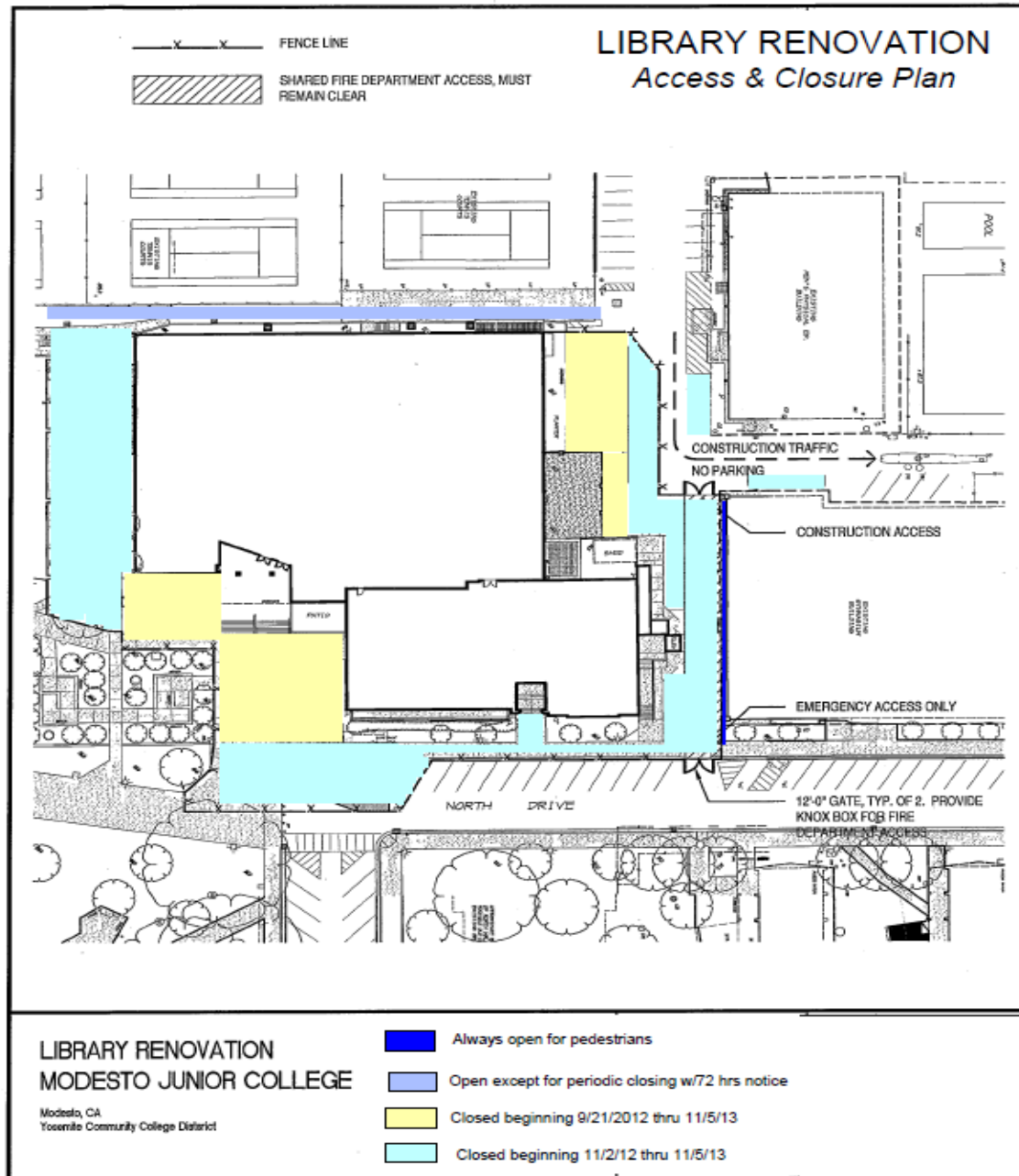

If there are any questions or concerns contact Kitchell CEM, Measure E Bond Construction Manager, located at 2201 Blue Gum Ave., Modesto CA 95358 Tel: 575-6991 Email mkennedy@kitchell.com

