



# Measure E Bond Program MODESTO JUNIOR COLLEGE CAMPUS CONSTRUCTION UPDATE



## UPDATES & ACTIVITIES THAT MAY IMPACT CAMPUS OPERATION

*Week of September 17, 2012*

### SCIENCE COMMUNITY CENTER

**Work this week:** Installation of interior drywall, plastering of exterior, installation of T-bar ceilings, installation of interior cabinetry on 2<sup>nd</sup> floor. Roughing-in plumbing and electrical.

<b>Access:</b>	No anticipated impact
<b>Noise:</b>	Moderate impact
<b>Parking:</b>	No anticipated impact
<b>Utilities:</b>	No anticipated impact
<b>Odors:</b>	No anticipated impact
<b>Dust:</b>	No anticipated impact



### WEST CAMPUS PARKING LOT

**Work this week:** Continued installation of site utilities. Electrical work in progress impact to additional parking stalls.

<b>Access:</b>	Caution at 4 <sup>th</sup> and B Street, sidewalk closed at east end of Lot 202.
<b>Noise:</b>	No anticipated impact
<b>Parking:</b>	11 stalls at east end of Lot 202 impacted
<b>Utilities:</b>	No anticipated impact
<b>Odors:</b>	No anticipated impact
<b>Dust:</b>	No anticipated impact



### AG PAVILION SITE IMPROVEMENTS

**Work this week:** Working on punchlist items.

<b>Access:</b>	Limited access when using G Street & Student Center Dr.
<b>Noise:</b>	Moderate impact
<b>Parking:</b>	No anticipated impact
<b>Utilities:</b>	No anticipated impact
<b>Odors:</b>	No anticipated impact
<b>Dust:</b>	No anticipated impact





# Measure E Bond Program MODESTO JUNIOR COLLEGE CAMPUS CONSTRUCTION UPDATE *continued (page 2 of 3)*

## SHIPPING & RECEIVING BLDG

**Work this week:** Excavating for retention basin and loading dock. Installation of underground utilities.

<b>Access:</b>	Caution when using G Street & 5 <sup>th</sup> Street.
<b>Noise:</b>	Moderate impact
<b>Parking:</b>	No anticipated impact
<b>Utilities:</b>	No anticipated impact
<b>Odors:</b>	No anticipated impact
<b>Dust:</b>	No anticipated impact



## PRIMARY DATA CENTER

**Work this week:** Contractor mobilized trailer and fencing. Implement SWPPP control system.

<b>Access:</b>	No anticipated impact
<b>Noise:</b>	Moderate impact
<b>Parking:</b>	No anticipated impact
<b>Utilities:</b>	No anticipated impact
<b>Odors:</b>	No anticipated impact
<b>Dust:</b>	Low impact



## LIBRARY RENOVATION

**Work this week:** Hazmat contractor to mobilize next week

<b>Access:</b>	See attached map
<b>Noise:</b>	Moderate impact
<b>Parking:</b>	See attached map
<b>Utilities:</b>	No anticipated impact
<b>Odors:</b>	No anticipated impact
<b>Dust:</b>	Low impact







# Measure E Bond Program MODESTO JUNIOR COLLEGE CAMPUS CONSTRUCTION UPDATE *continued (page 3 of 3)*

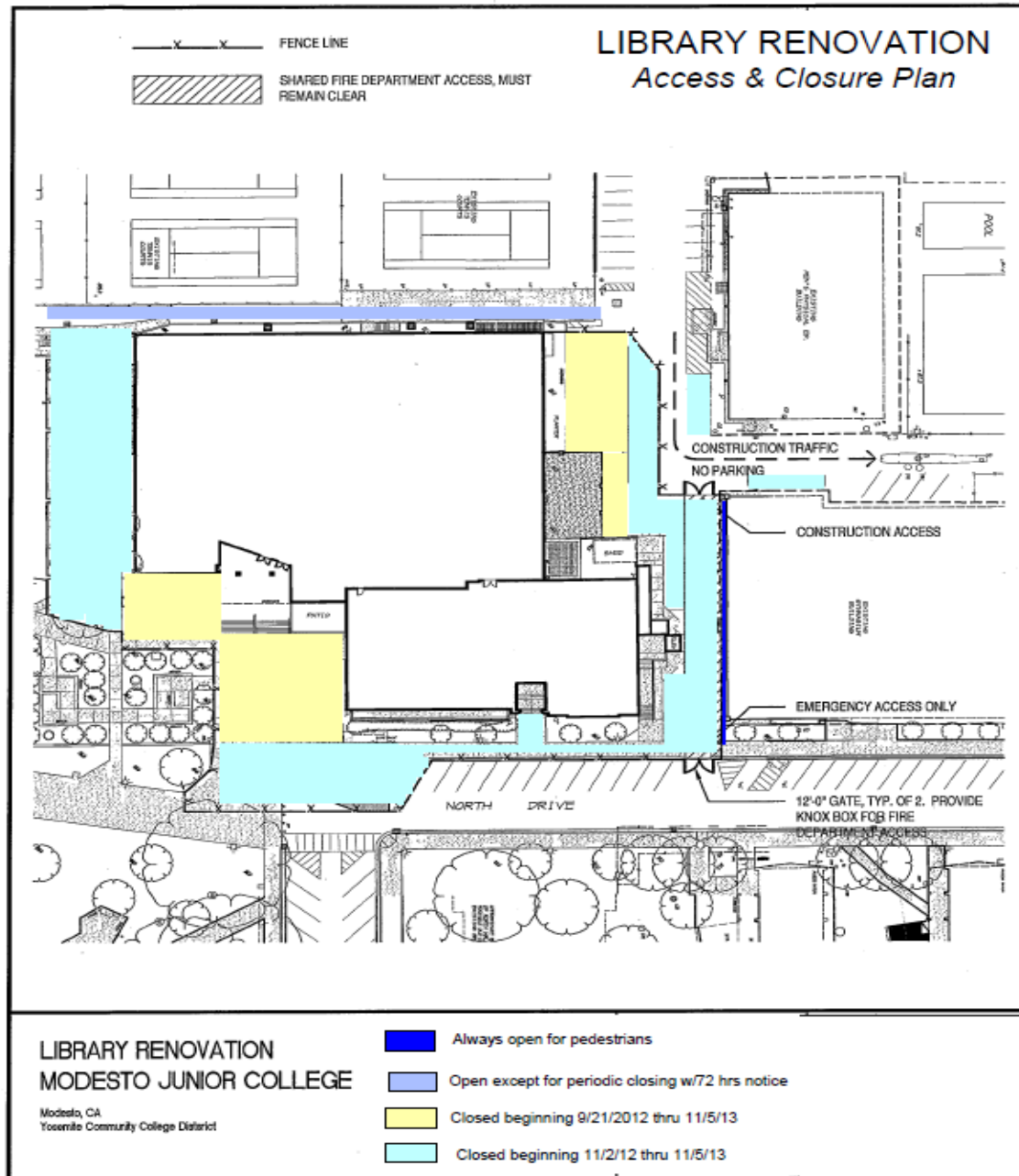

If there are any questions or concerns contact Kitchell CEM, Measure E Bond Construction Manager, located at 2201 Blue Gum Ave., Modesto CA 95358 Tel: 575-6991 Email [mkennedy@kitchell.com](mailto:mkennedy@kitchell.com)

