



# Measure E Bond Program MODESTO JUNIOR COLLEGE CAMPUS CONSTRUCTION UPDATE



## UPDATES & ACTIVITIES THAT MAY IMPACT CAMPUS OPERATION

*Week of February 11, 2013*

### SCIENCE COMMUNITY CENTER

**Work this week:** Continued installation of casework and lab cabinetry. Continued MEP finish work. Ongoing installation of interior finishes. Landscaping. Installation of metal grill panels.

<b>Access:</b>	No anticipated impact
<b>Noise:</b>	Moderate impact
<b>Parking:</b>	No anticipated impact
<b>Utilities:</b>	No anticipated impact
<b>Odors:</b>	No anticipated impact
<b>Dust:</b>	No anticipated impact



### INFRASTRUCTURE

**Work this week:** Continued installation of way finding signs.

<b>Access:</b>	Moderate impact
<b>Noise:</b>	No anticipated impact
<b>Parking:</b>	No anticipated impact
<b>Utilities:</b>	No anticipated impact
<b>Odors:</b>	No anticipated impact
<b>Dust:</b>	No anticipated impact

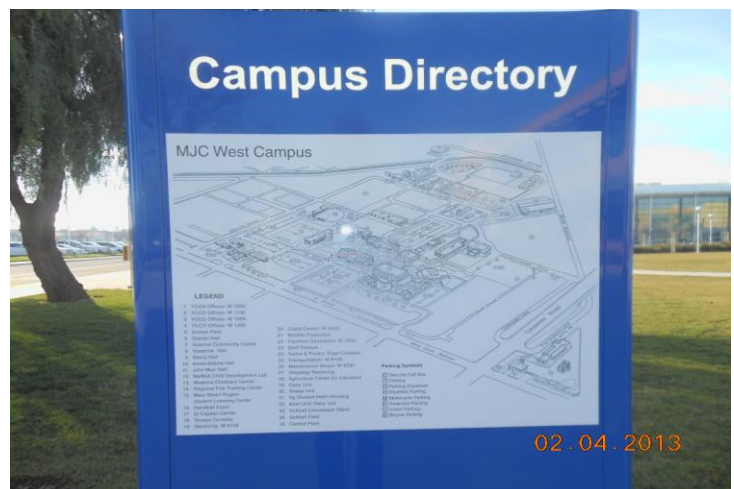

02.04.2013

### AG PAVILION SITE IMPROVEMENTS

**Work this week:** Installation of gravel at feedlot and punchlist work.

<b>Access:</b>	Limited access when using G Street & Student Center Dr.
<b>Noise:</b>	Moderate impact
<b>Parking:</b>	No anticipated impact
<b>Utilities:</b>	No anticipated impact
<b>Odors:</b>	No anticipated impact
<b>Dust:</b>	No anticipated impact



01.24.2013



# Measure E Bond Program MODESTO JUNIOR COLLEGE CAMPUS CONSTRUCTION UPDATE *continued (page 2 of 3)*

## SHIPPING & RECEIVING BLDG

**Work this week:** Site grading, metal building construction

<b>Access:</b>	None
<b>Noise:</b>	Moderate: equipment & deliveries
<b>Parking:</b>	No anticipated impact
<b>Utilities:</b>	No anticipated impact
<b>Odors:</b>	No anticipated impact
<b>Dust:</b>	No anticipated impact



## PRIMARY DATA CENTER

**Work this week:** Roof/Mechanical well framing on going. Rough in electrical and plumbing. Installation of HVAC ducting and fire suppression system.

<b>Access:</b>	Caution at G Street and 3 <sup>rd</sup> street.
<b>Noise:</b>	Moderate impact
<b>Parking:</b>	No anticipated impact
<b>Utilities:</b>	No anticipated impact
<b>Odors:</b>	No anticipated impact
<b>Dust:</b>	Moderate impact



## LIBRARY RENOVATION

**Work this week:** Continue installing duct work, plumbing, electrical conduits and interior framing.

<b>Access:</b>	See updated access map below
<b>Noise:</b>	Moderate: equipment & deliveries
<b>Parking:</b>	See attached map for closure.
<b>Utilities:</b>	None
<b>Odors:</b>	None
<b>Dust:</b>	None





Measure E Bond Program  
MODESTO JUNIOR COLLEGE CAMPUS  
CONSTRUCTION UPDATE  
continued (page 3 of 3)

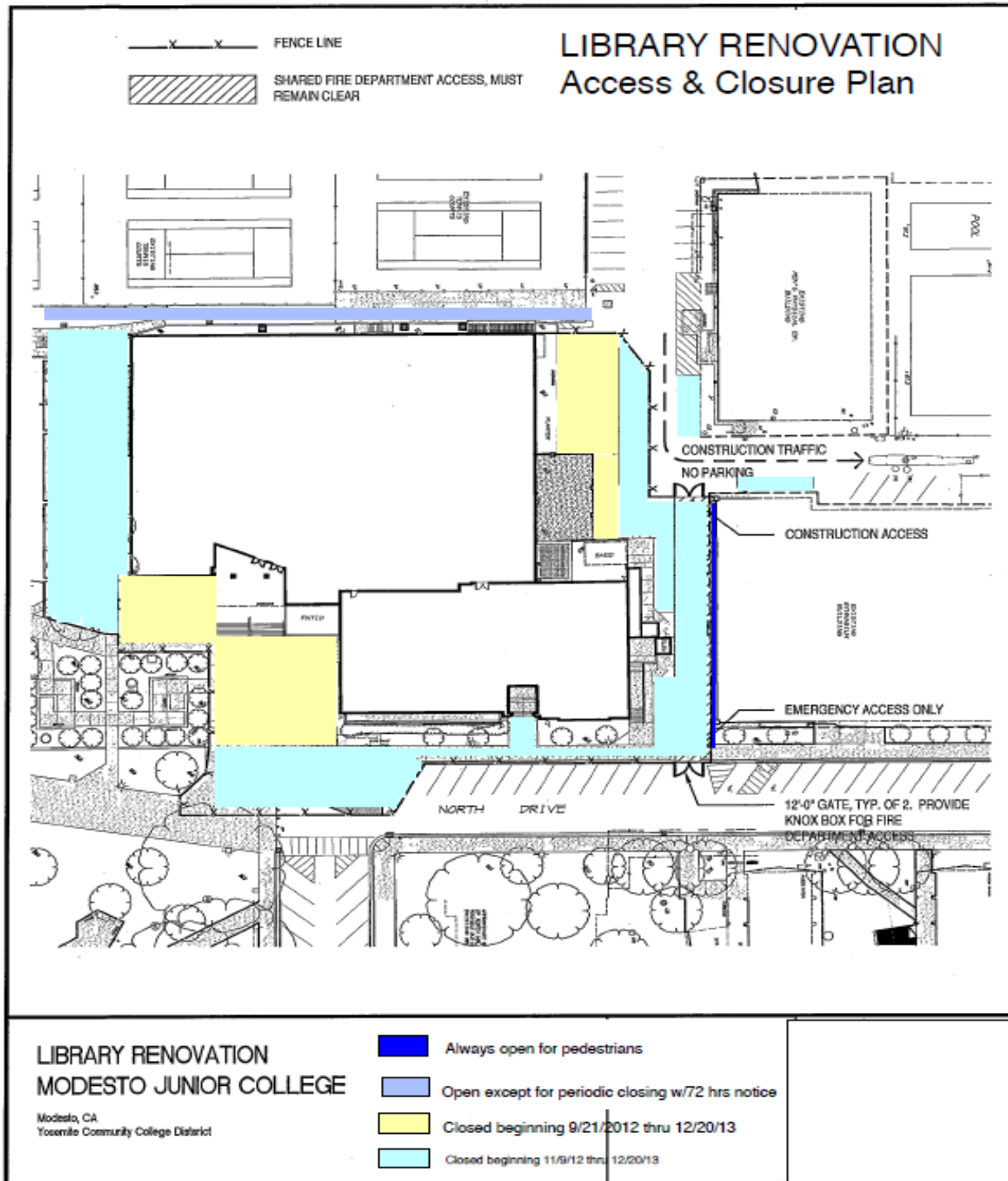

If there are any questions or concerns contact Kitchell CEM, Measure E Bond Construction Manager, located at 2201 Blue Gum Ave., Modesto CA 95358 Tel: 575-6991 Email [mkennedy@kitchell.com](mailto:mkennedy@kitchell.com)

