



Measure E Bond Program MODESTO JUNIOR COLLEGE CAMPUS CONSTRUCTION UPDATE



UPDATES & ACTIVITIES THAT MAY IMPACT CAMPUS OPERATION

Week of December 24, 2012

SCIENCE COMMUNITY CENTER

Work this week: Continued installation of casework and lab cabinetry. Continued site work. Installation of flooring on 2nd and 3rd floors. Electrical, mechanical and plumbing finish work. Installation of interior finishes. Installation of GVM displays.

Access:	No anticipated impact
Noise:	Moderate impact
Parking:	No anticipated impact
Utilities:	No anticipated impact
Odors:	No anticipated impact
Dust:	No anticipated impact



INFRASTRUCTURE

Work this week: Removing abandoned utility poles and installing way finding signs.

Access:	Moderate impact
Noise:	No anticipated impact
Parking:	No anticipated impact
Utilities:	No anticipated impact
Odors:	No anticipated impact
Dust:	No anticipated impact



AG PAVILION SITE IMPROVEMENTS

Work this week: Installation of gravel and punchlist work.

Access:	Limited access when using G Street & Student Center Dr.
Noise:	Moderate impact
Parking:	No anticipated impact
Utilities:	No anticipated impact
Odors:	No anticipated impact
Dust:	No anticipated impact





Measure E Bond Program MODESTO JUNIOR COLLEGE CAMPUS CONSTRUCTION UPDATE *continued (page 2 of 3)*

SHIPPING & RECEIVING BLDG

Work this week: Forming loading dock, and curb forms at north side. Stripping forms and clean up at concrete slab.

Access:	Caution when using G Street & 5 th Street.
Noise:	Moderate impact
Parking:	No anticipated impact
Utilities:	No anticipated impact
Odors:	No anticipated impact
Dust:	No anticipated impact



PRIMARY DATA CENTER

Work this week: Installation of interior and exterior framing. Rough in electrical. Installation of structural steel

Access:	Caution at G Street and 3 rd street.
Noise:	Moderate impact
Parking:	No anticipated impact
Utilities:	No anticipated impact
Odors:	No anticipated impact
Dust:	Moderate impact



LIBRARY RENOVATION

Work this week: Electrical rough in. Concrete placement for wall cubs

Access:	See updated access map below
Noise:	Deliveries and tractors
Parking:	See attached map for closure.
Utilities:	Power to library except for the essential HVAC circuits remain off. Water to the Library will be turned off for a few hours.
Odors:	None
Dust:	None





Measure E Bond Program
MODESTO JUNIOR COLLEGE CAMPUS
CONSTRUCTION UPDATE
continued (page 3 of 3)

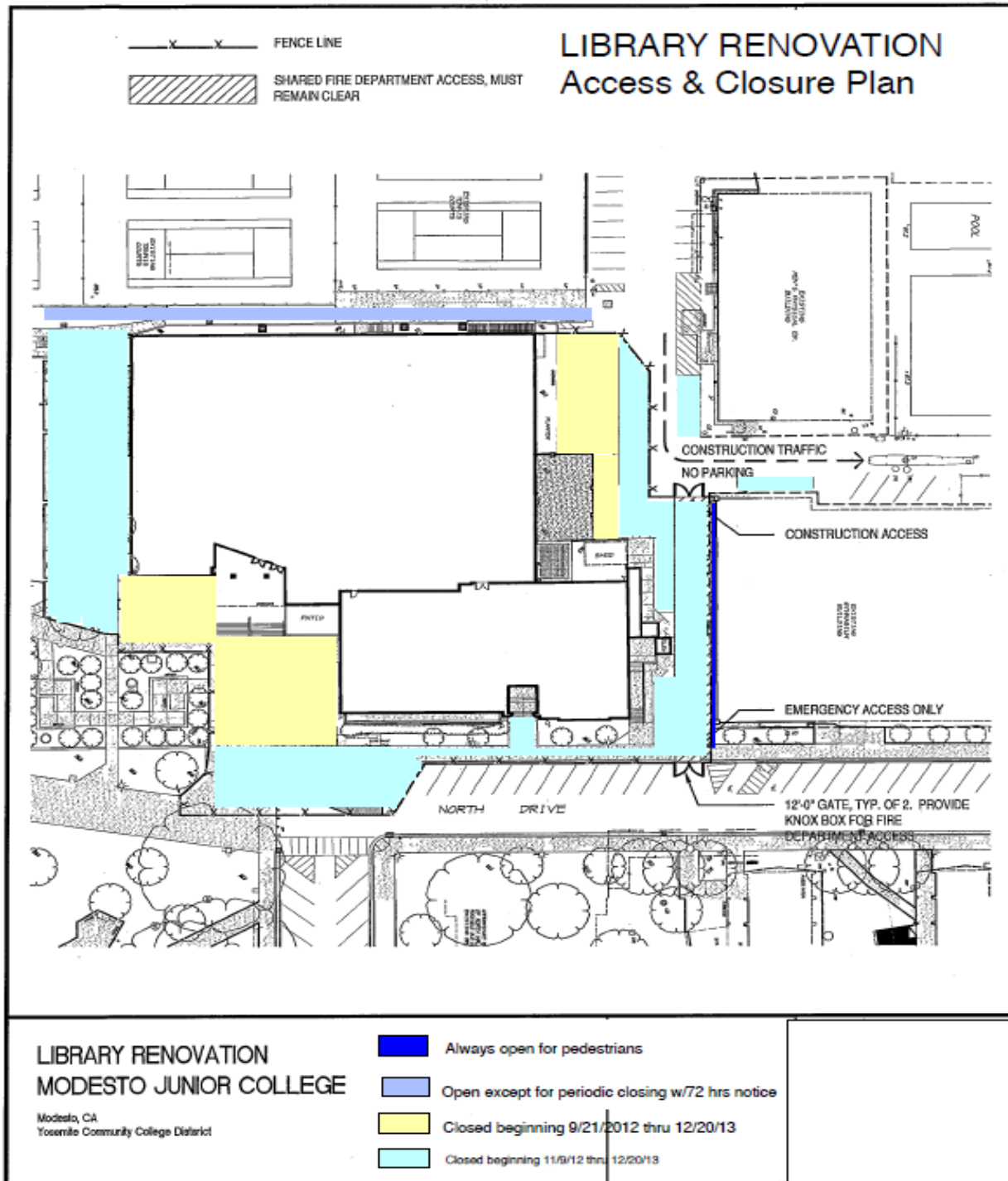

If there are any questions or concerns contact Kitchell CEM, Measure E Bond Construction Manager, located at 2201 Blue Gum Ave., Modesto CA 95358 Tel: 575-6991 Email mkennedy@kitchell.com

