



# Measure E Bond Program MODESTO JUNIOR COLLEGE CAMPUS CONSTRUCTION UPDATE



## UPDATES & ACTIVITIES THAT MAY IMPACT CAMPUS OPERATION *Week of May 30, 2016*

### DISTRICT OFFICE BUILDING

**Work this week:** Contractor will be working on mechanical and electrical rough-in, roofing, building stucco, and installing sheetrock. Painting and site grading.

**Access:** None  
**Noise:** Moderate due to construction equipment.  
**Parking:** None  
**Utilities:** None  
**Odors:** None  
**Dust:** Minor impact.

X-X-X Construction fencing. Restricted access.

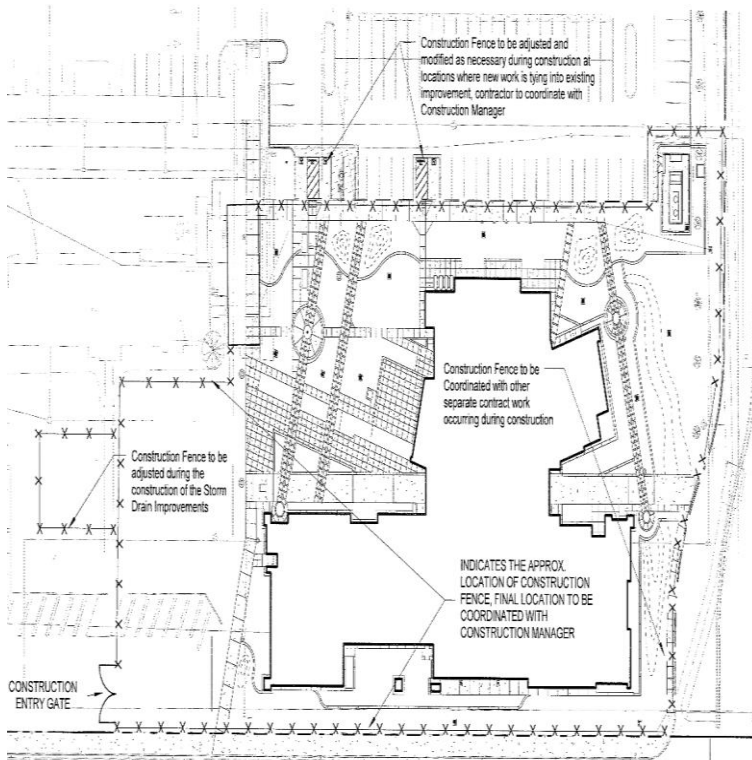



## WESTERLY ROADS AREAS 3 & 4

**Work this week:** Forming of sidewalks along 4<sup>th</sup> street will occur, curbs in the same vicinity will also be poured towards the beginning of the week. Electrical & irrigation work will continue. Grading will take place towards the end of the week at E & 4<sup>th</sup> Street.

**Access:** Traffic will be redirected to G-Street North of Lot 207.

**Noise:** Extreme noise due to heavy construction equipment.

**Parking:** Lot 207 will be closed. Lot 202 will be partly closed.

**Utilities:** None anticipated.

**Odors:** None anticipated.

**Dust:** Moderate impact due to construction related activities.

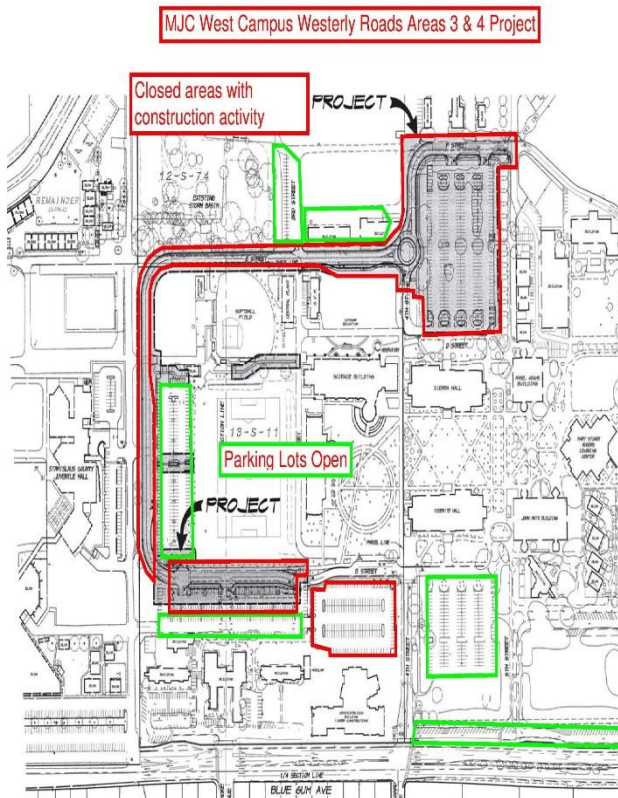





## SOLAR ARRAY PROJECT

**Work this week:** Electrical work and installation of modules to begin this week. Continue painting of steel.

**Access:** None.  
**Noise:** Extreme noise due to heavy construction equipment.  
**Parking:** Lot 215 will be closed.  
**Utilities:** None anticipated.  
**Odors:** None anticipated.  
**Dust:** Moderate impact due to construction related activities.

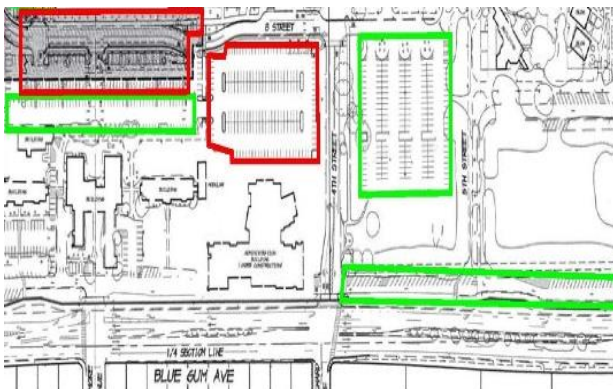

Under Construction

Available Parking

