



Measure E Bond Program MODESTO JUNIOR COLLEGE CAMPUS CONSTRUCTION UPDATE



UPDATES & ACTIVITIES THAT MAY IMPACT CAMPUS OPERATION *Week of April 18, 2016*

DISTRICT OFFICE BUILDING

Work this week: Contractor will be working on mechanical, electrical, and plumbing (MEP) rough-in, wall framing, roofing, exterior lath, and install sheetrock.

Access: None
Noise: Moderate due to construction equipment.
Parking: None
Utilities: None
Odors: None
Dust: Minor impact

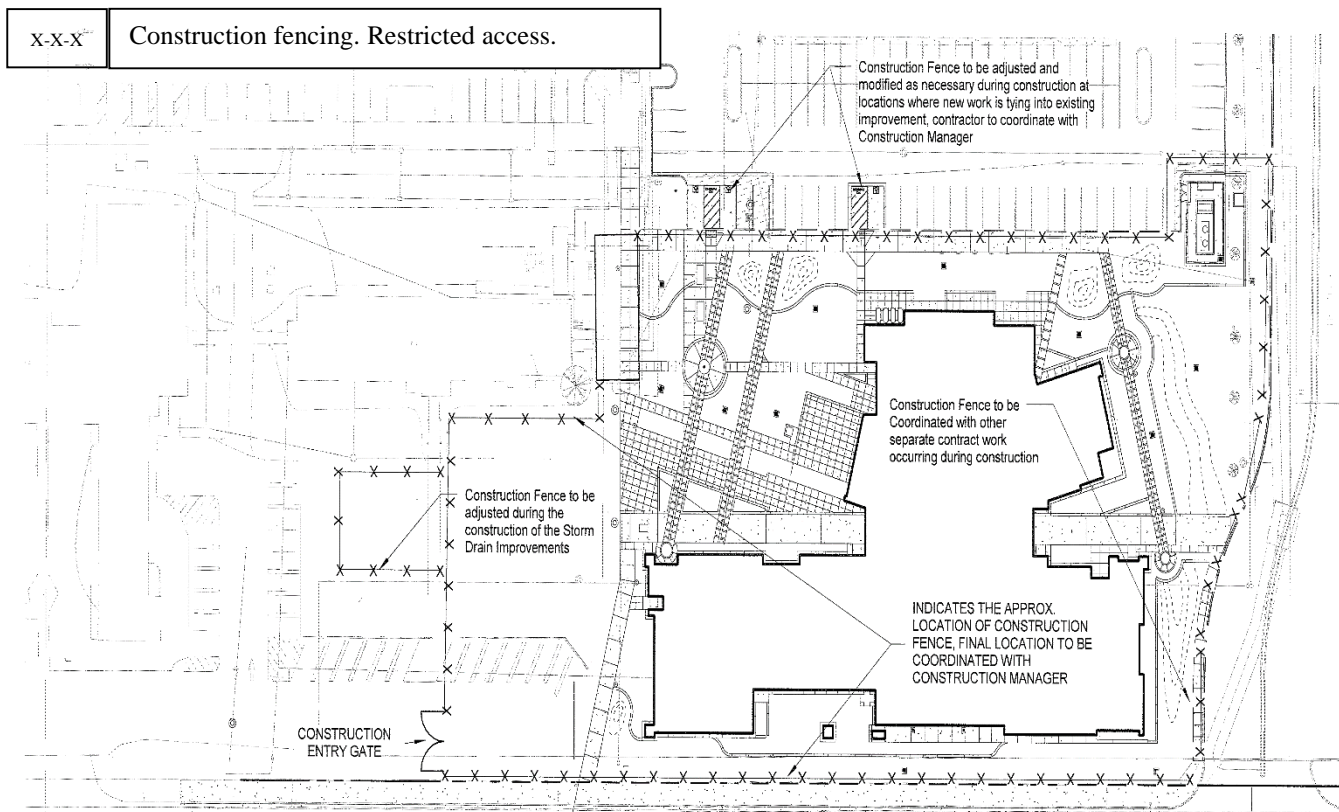



WESTERLY ROADS AREAS 3 & 4

Work this week: The dilapidated asphalt areas at Parking Lot 207 will receive a subgrade application to get ready for asphalt. Unfortunately due to last week's weather we will be unable to continue grading the new road west of the softball field. However in that area we will be potholing for water lines. Grinding of the asphalt & concrete will begin at Parking Lot 207 down towards the softball field.

Access: Traffic will be redirected to G-Street North of Lot 207.

Noise: Extreme noise due to heavy construction equipment.

Parking: Lot 207 will be closed.

Utilities: None anticipated.

Odors: None anticipated.

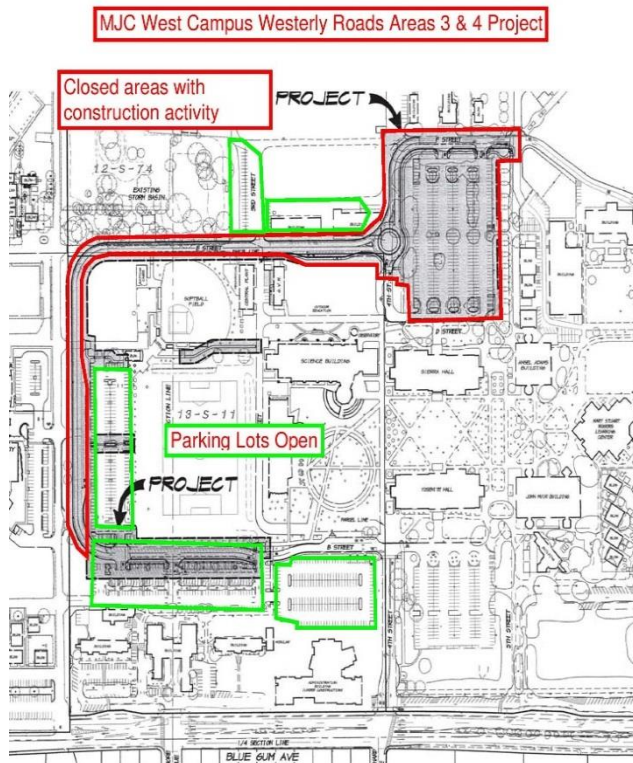

If there are any questions or concerns contact Kitchell CEM, Measure E Bond Construction Manager, located at 2201 Blue Gum Ave., Modesto CA 95358 Tel: 575-6991 Email mkennedy@kitchell.com